

DEPOSIT OF STATEMENT AND MAP

SECTION 31(6) OF THE HIGHWAYS ACT 1980
(as amended by the Countryside and Rights of Way Act 2000)

TO: LINCOLNSHIRE COUNTY COUNCIL

1. I have been since 5th April 1992 the owner within the meaning of the above section of the land known as land lying to the north east side of Blackthorn Lane, Fishtoft, Boston, Lincolnshire more particularly delineated on the map accompanying this statement and thereon edged red.
2. The aforementioned land lies in the Parishes of Fishtoft.
3. No ways over the land had been dedicated as highways.
4. The deposit shall comprise this statement and accompanying map.

Signed (landowner) 

Name (of landowner - please print) RICHARD HARDY

Address (of landowner - please print) WILLOUGHBY HOUSE, WILLOUGHBY HILLS, FISHTOFT,
BOSTON, LINCOLNSHIRE PE21 9SA

Date 15/11/11

Land Registry
Official copy of
title plan

Title number LL317584
Ordnance Survey map reference TF3444NE
Scale 1:2500
Administrative area Lincolnshire: Boston



© Crown Copyright. Produced by Land Registry. Reproduction in whole or in part is prohibited without the prior written permission of Ordnance Survey. Licence Number 100026316

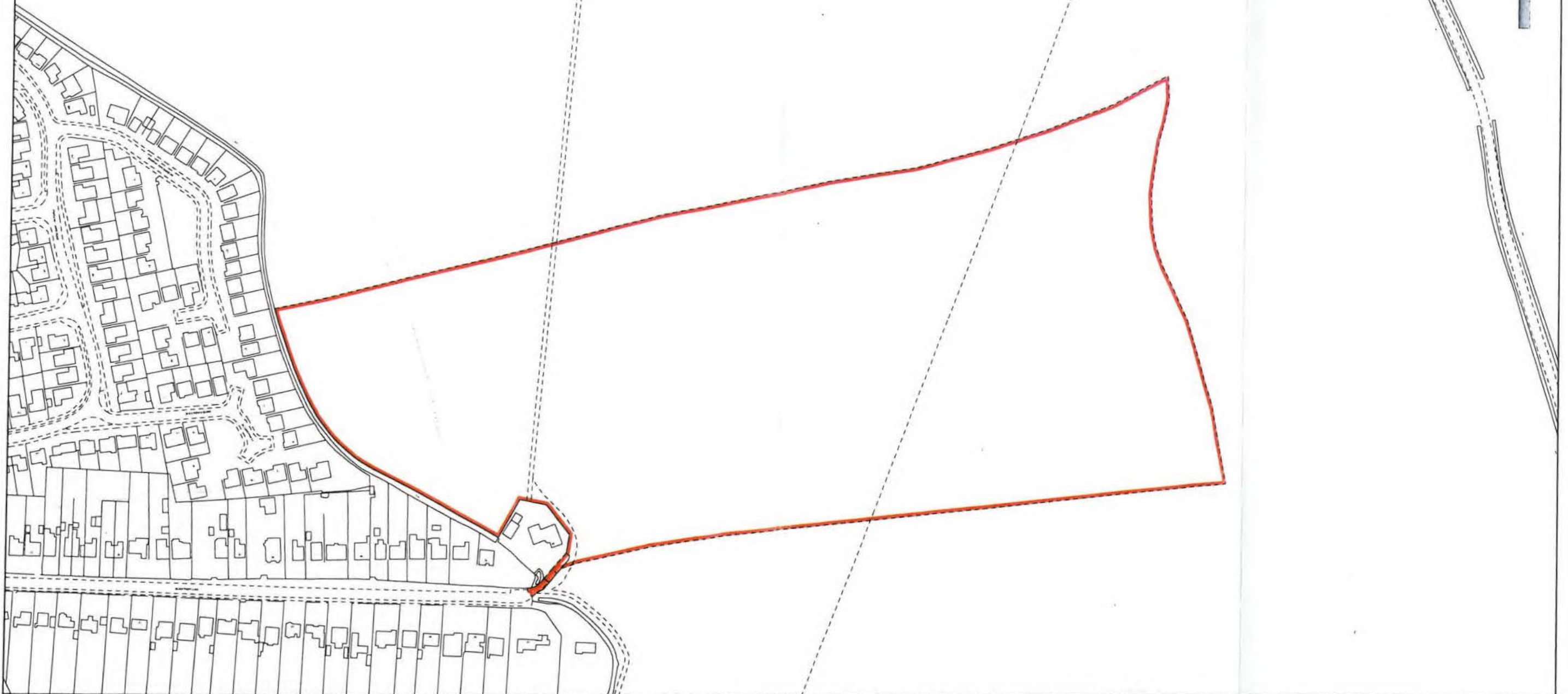

This official copy issued on 10 June 2010 shows the state of this title plan on 10 June 2010 at 10:39:53. It is admissible in evidence to the same extent as the original (s.67 Land Registration Act 2002).

This title plan shows the general position, not the exact line, of the boundaries. It may be subject to distortions in scale. Measurements scaled from this plan may not match measurements between the same points on the ground. See Land Registry Public Guide 19 - Title Plans and Boundaries.

This title is dealt with by Land Registry, Kingston upon Hull Office.

DEPOSIT OF STATEMENT AND MAP

SECTION 31(6) OF THE HIGHWAYS ACT 1980
(as amended by the Countryside and Rights of Way Act 2000)

TO: LINCOLNSHIRE COUNTY COUNCIL

1. I have been since 29th May 2009 the owner within the meaning of the above section of the land known as Willoughby House Farm, Willoughby Hills, Fishtoft, Boston Lincolnshire more particularly delineated on the map accompanying this statement and thereon edged red.
2. The aforementioned land lies in the Parish of Fishtoft.
3. No ways over the land had been dedicated as highways.
4. The deposit shall comprise this statement and accompanying map.

Signed (landowner) ... 

Name (of landowner - please print) RICHARD HARDY

Address (of landowner - please print) WILLOUGHBY HOUSE, WILLOUGHBY HILLS, FISHTOFT,
BOSTON, LINCOLNSHIRE PE21 9SA

Date ... 11/05/11



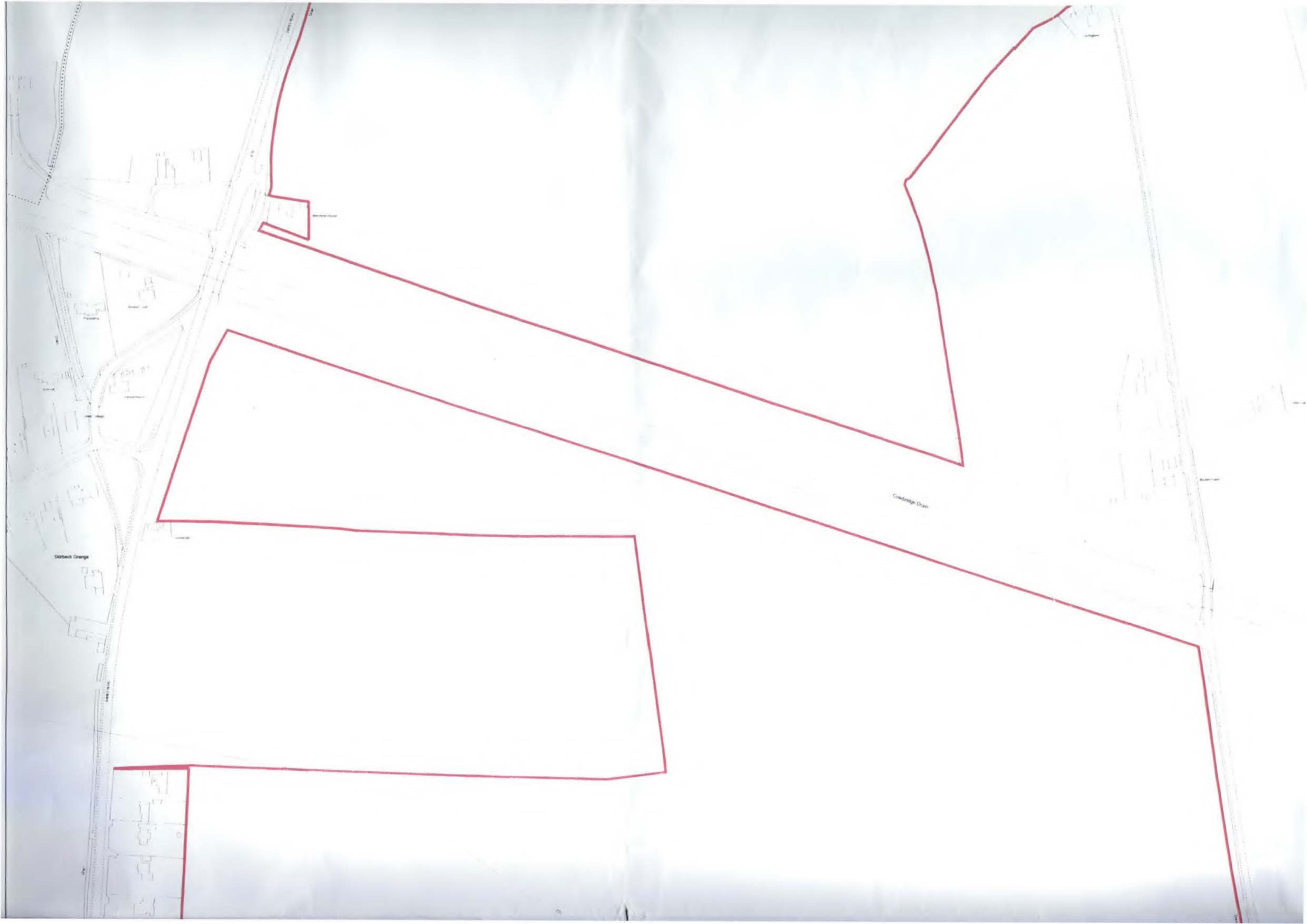

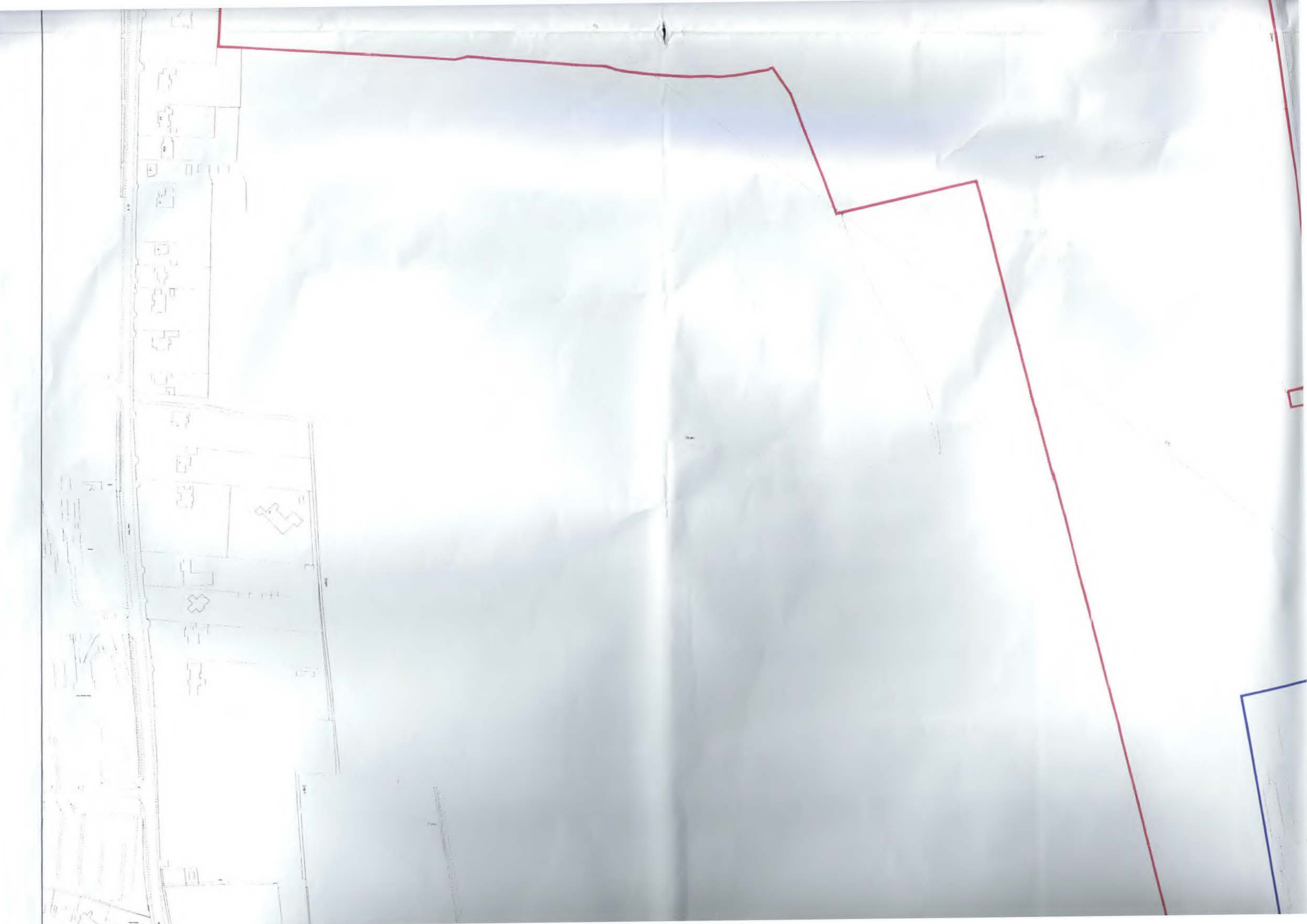



This official copy issued on 8 October 2010 shows the state of this title plan on 8 October 2010 at 13:29:15. It is admissible in evidence to the same extent as the original (s.67 Land Registration Act 2002).

This title plan shows the general position, not the exact line, of the boundaries. It may be subject to distortions in scale. Measurements scaled from this plan may not match measurements between the same points on the ground. See Land Registry Public Guide 1

This title is dealt with by Land Registry, Kingston upon Hull Office.

Land Registry
Official copy of
title plan

Title number **LL307709**
Ordnance Survey map reference **TF3446SE**
Scale **1:2500**
Administrative area **Lincolnshire: Boston**



© Crown Copyright Produced by Land Registry Reproduction in whole or in part is prohibited without the prior written permission of Ordnance Survey Licence Number 100026316

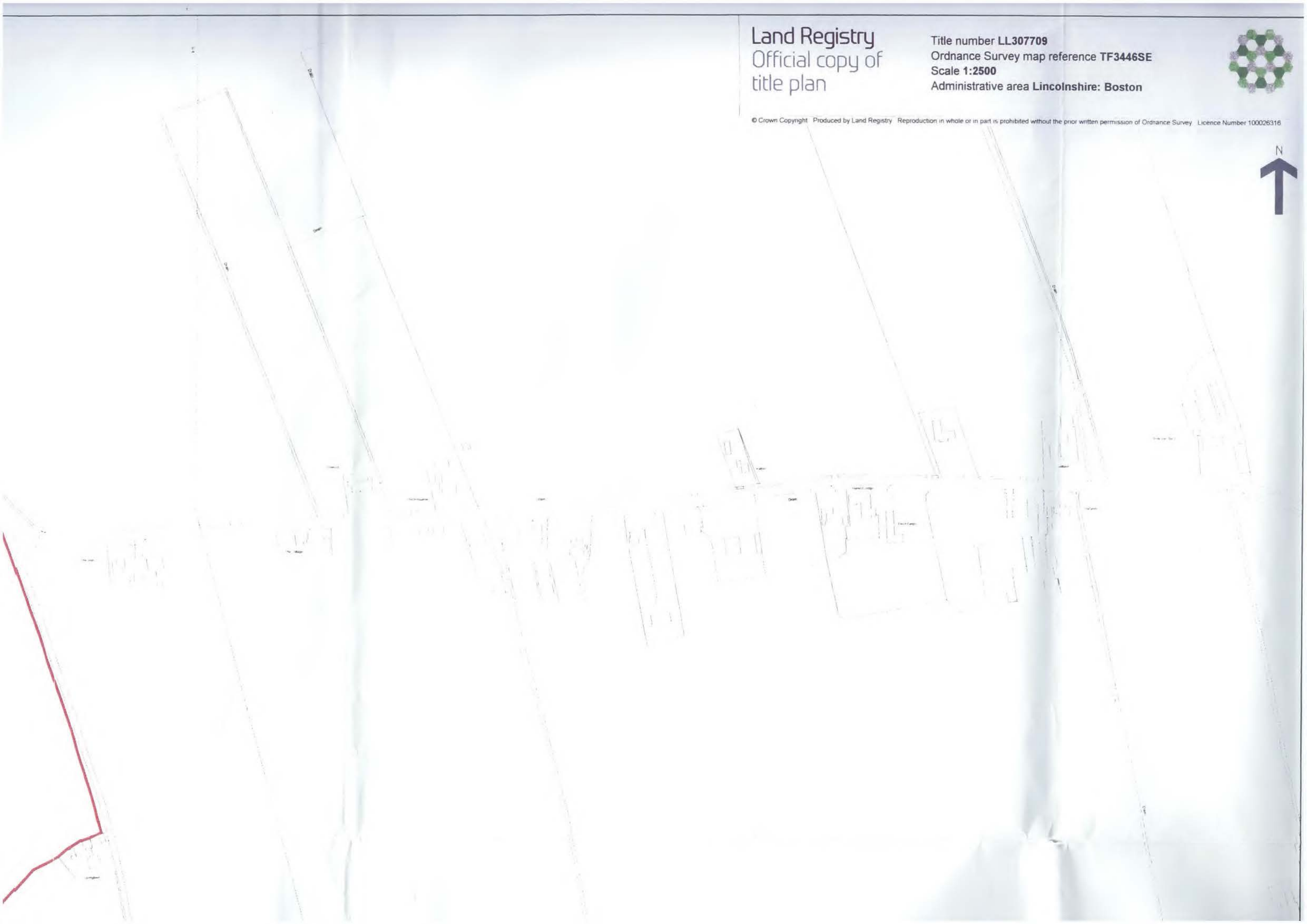

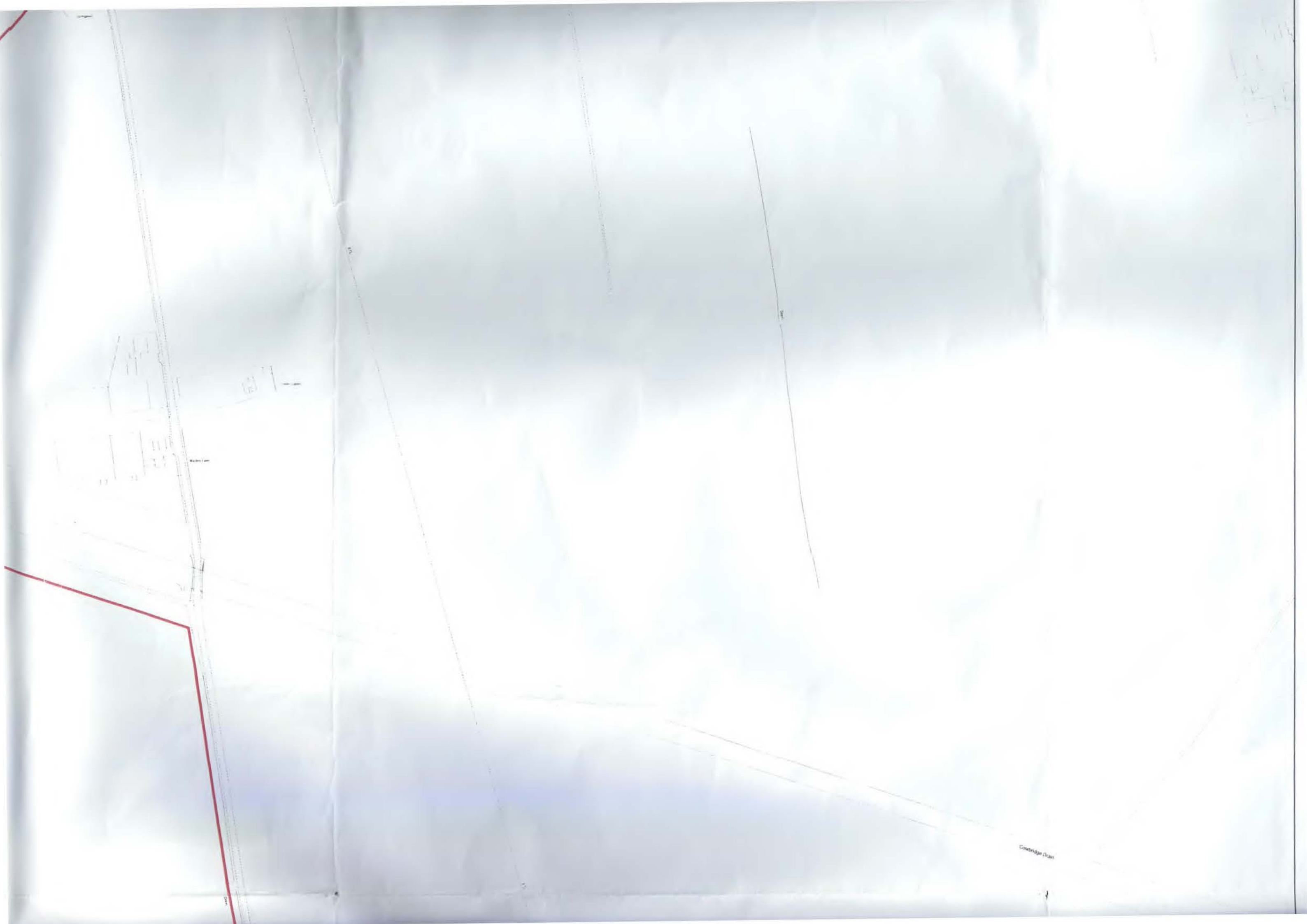

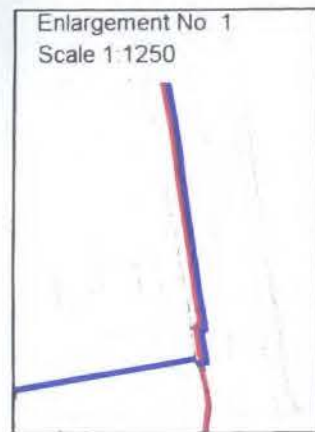

See Enlargement



DEPOSIT OF STATEMENT AND MAP

SECTION 31(6) OF THE HIGHWAYS ACT 1980
(as amended by the Countryside and Rights of Way Act 2000)

TO: LINCOLNSHIRE COUNTY COUNCIL

1. I have been since 3rd December 2001 the owner within the meaning of the above section of the land known as land on the east site of Sibsey Road, Fishtoft, Boston, Lincolnshire more particularly delineated on the map accompanying this statement and thereon edged red.
2. The aforementioned land lies in the Parish of Fishtoft.
3. No ways over the land had been dedicated as highways.
4. The deposit shall comprise this statement and accompanying map.

Signed (landowner) 

Name (of landowner - please print) RICHARD HARDY

Address (of landowner - please print) WILLOUGHBY HOUSE, WILLOUGHBY HILLS, FISHTOFT,
BOSTON, LINCOLNSHIRE PE21 9SA

Date ...10/11/11.....

Land Registry
Official copy of
title plan

Title number **LL207119**
Ordnance Survey map reference **TF3445NW**
Scale **1:1250**
Administrative area **LINCOLNSHIRE : BOSTON**



© Crown Copyright. Produced by Land Registry. Reproduction in whole or in part is prohibited without the prior written permission of Ordnance Survey. Licence Number 100026316.

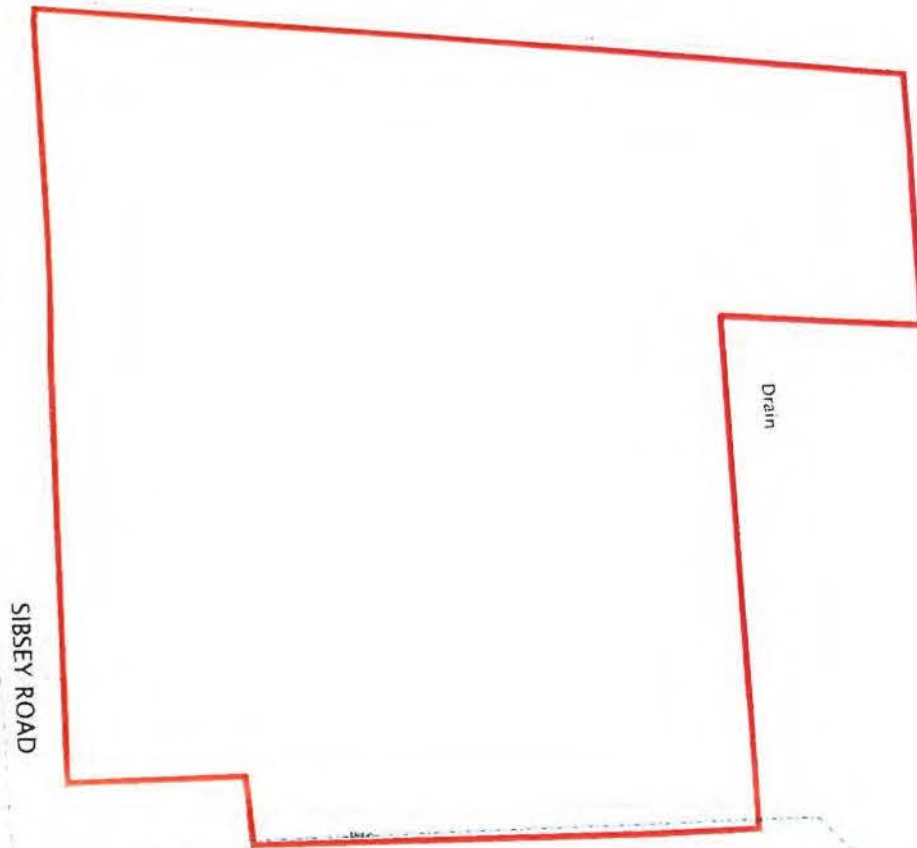

SIBSEY ROAD

Drain

Pond

Burton Hall

WAINLIFT ROAD

Drain

PART A: Information relating to the applicant and land to which the application relates
(all applicants must complete this Part)

1. Name of appropriate authority to which the application is addressed:

Lincolnshire County Council

2. Name and full address (including postcode) of applicant:

**Richard Hardy of Willoughby House, Willoughby Hills, Fishtoft, Boston, Lincolnshire
PE21 9SA**

3. Status of applicant (tick relevant box or boxes):

I am

(a) ☒ the owner of the land described in paragraph 4.

(b) ☐ making this application and the statements/declarations it contains on behalf of [insert name of owner] who is the owner of the land(s) described in paragraph 4 and in my capacity as [insert details].

4. Insert description of the land(s) to which the application relates (including full address and postcode):

Various parcels of land in Boston, Lincolnshire.

- 1. Land on the north east side of Blackthorn Lane, Fishtoft, Boston, Lincolnshire;**
- 2. Land at Willoughby House Farm, Willoughby Hills, Fishtoft, Boston, Lincolnshire;**
- 3. Land at the east site of Sibsey Road, Fishtoft, Boston, Lincolnshire.**

5. Ordnance Survey six-figure grid reference(s) of a point within the area of land(s) to which the application relates (if known):

6. This deposit comprises the following statement(s) and/or declarations (*delete Parts B, C, or D where not applicable*):

PART C: Declaration under section 31(6) of the Highways Act 1980

1. I am the owner of the land described in paragraph 4 of Part A of this form and shown edged red on the maps accompanying this declaration and also lodged with Lincolnshire Council on 28th November 2011.

2. On the 28th November 2011 I deposited with Lincolnshire County Council, being the appropriate council, statements dated 10th November 2011 (parcels 1 and 3) and 15th November 2011 (parcel 2) and accompanied by maps showing my property edged red which stated that

no ways had been dedicated as highways over our property.

4. No additional ways have been dedicated over the land edged red on the maps accompanying this declaration and referenced at in paragraph 1 above since the statements dated 10th November 2011 and 15th November 2011 referred to in paragraph 2 above and at

the present time I have no intention of dedicating any more public rights of way over the property.

PART D: Statement under section 15A(1) of the Commons Act 2006

I am the owner of the land described in paragraph 4 of Part A of this form and shown edged red on the maps accompanying this statement.

I wish to bring to an end any period during which persons may have indulged as of right in lawful sports and pastimes on the whole or any part of the land shown edged red on the accompanying maps.

PART E: Additional information relevant to the application
(insert any additional information relevant to the application)

PART F: Statement of Truth
(all applicants must complete this Part)

WARNING: If you dishonestly enter information or make a statement that you know is, or might be, untrue or misleading, and intend by doing so to make a gain for yourself or another person, or to cause loss or the risk of loss to another person, you may commit the offence of fraud under section 1 of the Fraud Act 2006, the maximum penalty for which is 10 years' imprisonment or an unlimited fine, or both.

I BELIEVE THAT THE FACTS AND MATTERS CONTAINED IN THIS FORM ARE TRUE

Signature (of the person making the statement of truth):

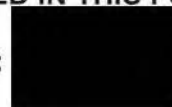

Print full name: Richard Hardy

Date: 30/10/13

You should keep a copy of the completed form

Data Protection Act 1998 – Fair Processing Notice

The purpose of this Fair Processing Notice is to inform you of the use that will be made of your personal data, as required by the Data Protection Act 1998.

The appropriate authority (see explanation of definition in above guidance notes) in England is the data controller in respect of any personal data that you provide when you complete this form.

The information that you provide will be used by the appropriate authority in its duties to process applications to deposit statements, maps and declarations under section 31(6) the Highways Act 1980 and statements under section 15A(1) of the Commons Act 2006. The information you provide will also be used by the appropriate authority in its duty to update the registers in which details of such deposits are recorded under the Dedicated Highways (Registers under Section 31A of the Highways Act 1980) (England) Regulations 2007 and the Commons (Registration of Town or Village Greens) and Dedicated Highways (Landowner Statements and Declarations) (England) Regulations 2013.

The appropriate authority is required by the legislation above to maintain a register which holds information provided in this form, which can be inspected online or in person by members of the public on request. It may also be required to release information, including

Land Registry
Official copy of
title plan

Title number LL317584
Ordnance Survey map reference TF3444NE
Scale 1:2500
Administrative area Lincolnshire: Boston



© Crown Copyright. Produced by Land Registry. Reproduction in whole or in part is prohibited without the prior written permission of Ordnance Survey. Licence Number 100026316

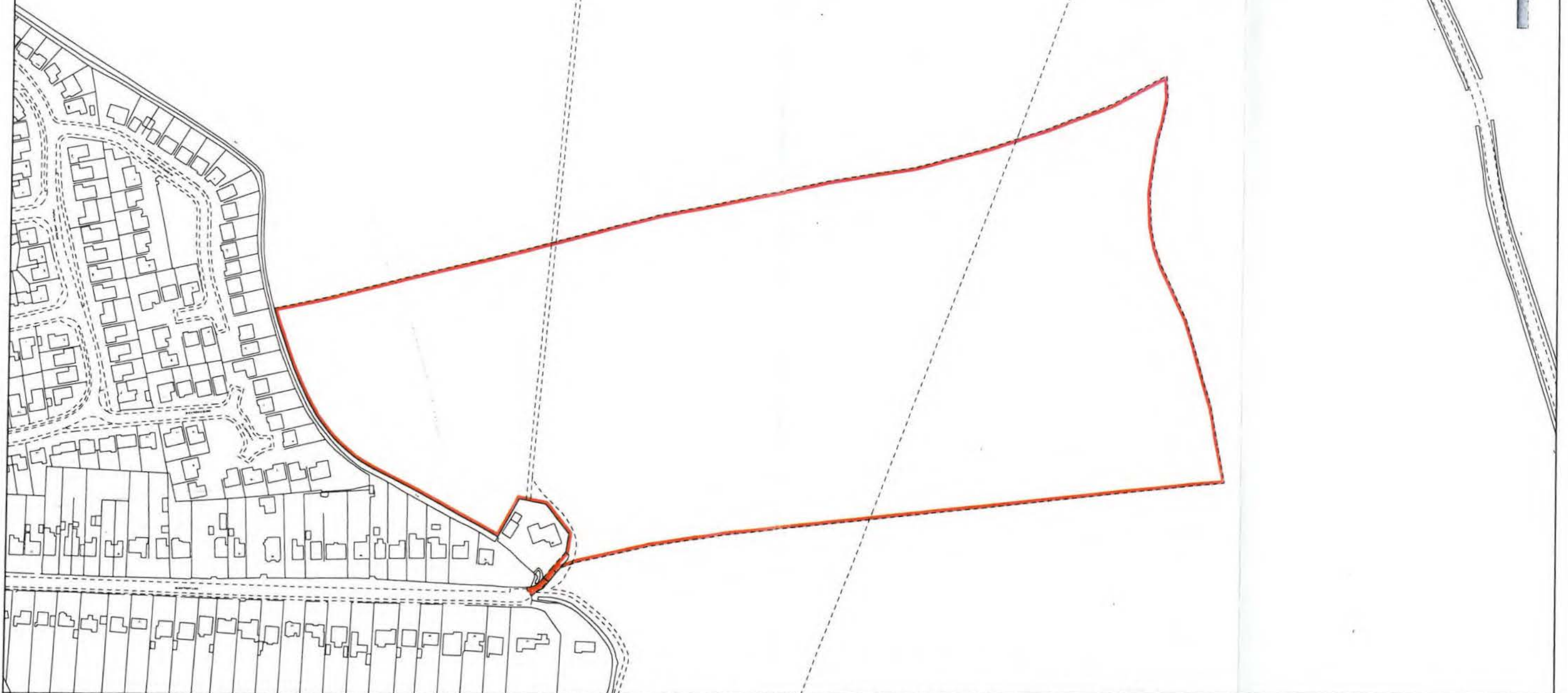

This official copy issued on 10 June 2010 shows the state of this title plan on 10 June 2010 at 10:39:53. It is admissible in evidence to the same extent as the original (s.67 Land Registration Act 2002).

This title plan shows the general position, not the exact line, of the boundaries. It may be subject to distortions in scale. Measurements scaled from this plan may not match measurements between the same points on the ground. See Land Registry Public Guide 19 - Title Plans and Boundaries.

This title is dealt with by Land Registry, Kingston upon Hull Office.



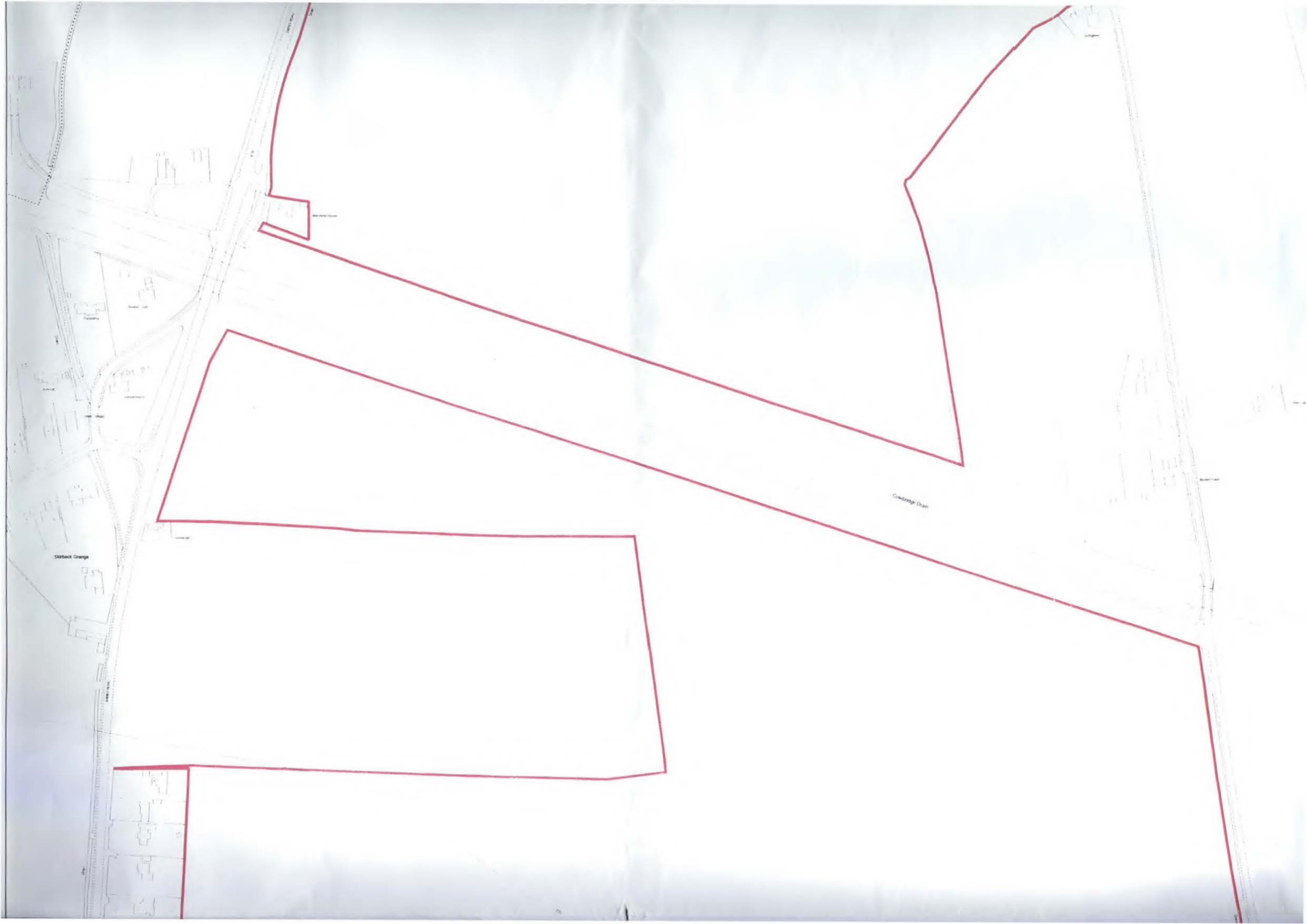

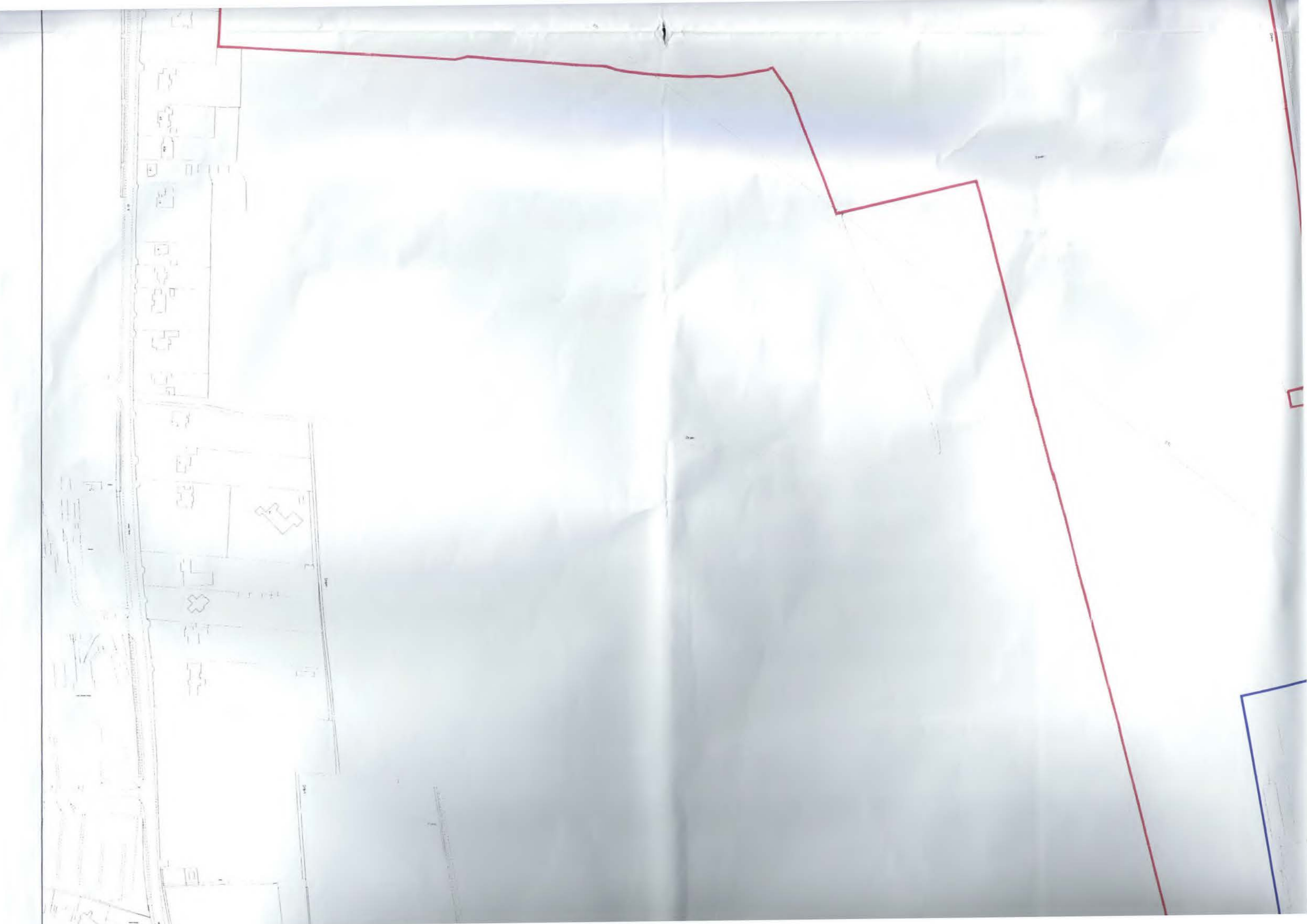



This official copy issued on 8 October 2010 shows the state of this title plan on 8 October 2010 at 13:29:15. It is admissible in evidence to the same extent as the original (s.67 Land Registration Act 2002).

This title plan shows the general position, not the exact line, of the boundaries. It may be subject to distortions in scale. Measurements scaled from this plan may not match measurements between the same points on the ground. See Land Registry Public Guide 1

This title is dealt with by Land Registry, Kingston upon Hull Office.

Land Registry
Official copy of
title plan

Title number **LL307709**
Ordnance Survey map reference **TF3446SE**
Scale **1:2500**
Administrative area **Lincolnshire: Boston**



© Crown Copyright Produced by Land Registry Reproduction in whole or in part is prohibited without the prior written permission of Ordnance Survey Licence Number 100026316

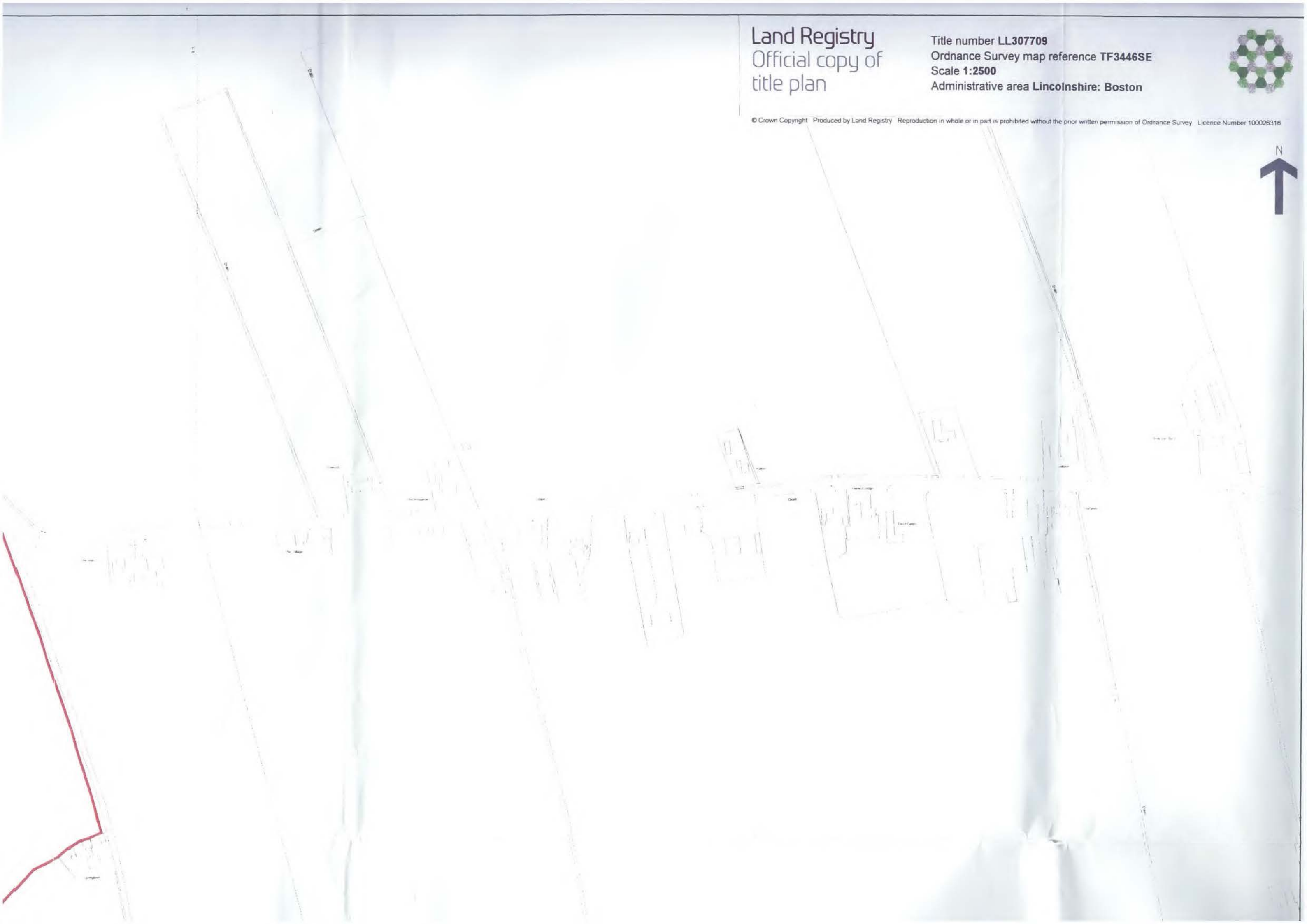

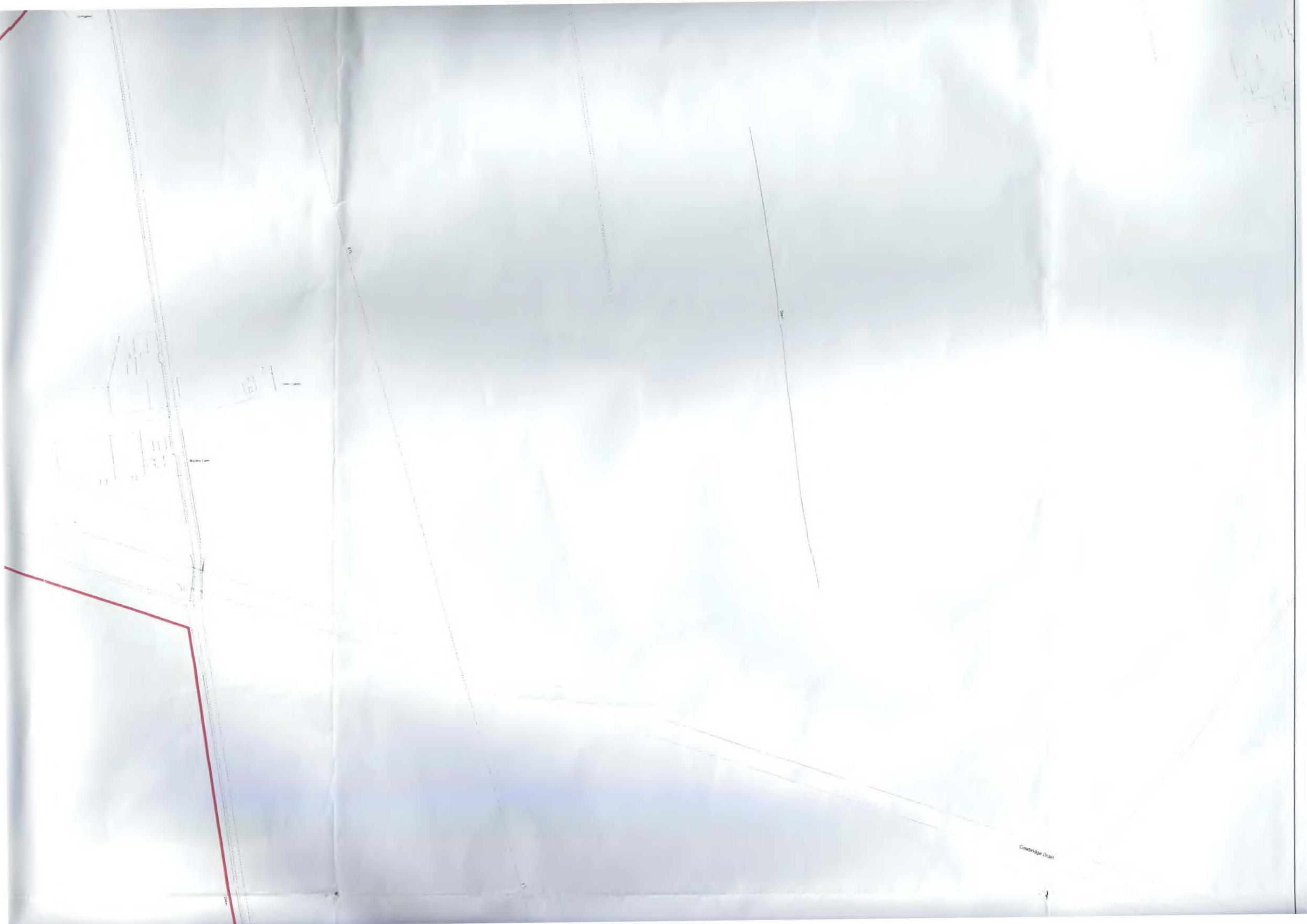

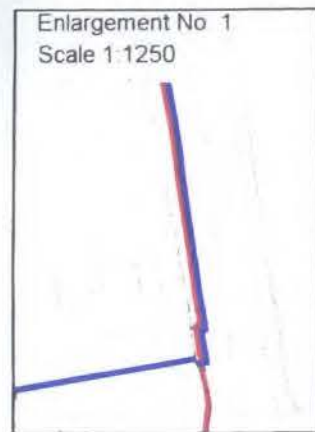

See Enlargement



Land Registry
Official copy of
title plan

Title number **LL207119**
Ordnance Survey map reference **TF3445NW**
Scale **1:1250**
Administrative area **LINCOLNSHIRE : BOSTON**



© Crown Copyright. Produced by Land Registry. Reproduction in whole or in part is prohibited without the prior written permission of Ordnance Survey. Licence Number 100026316.

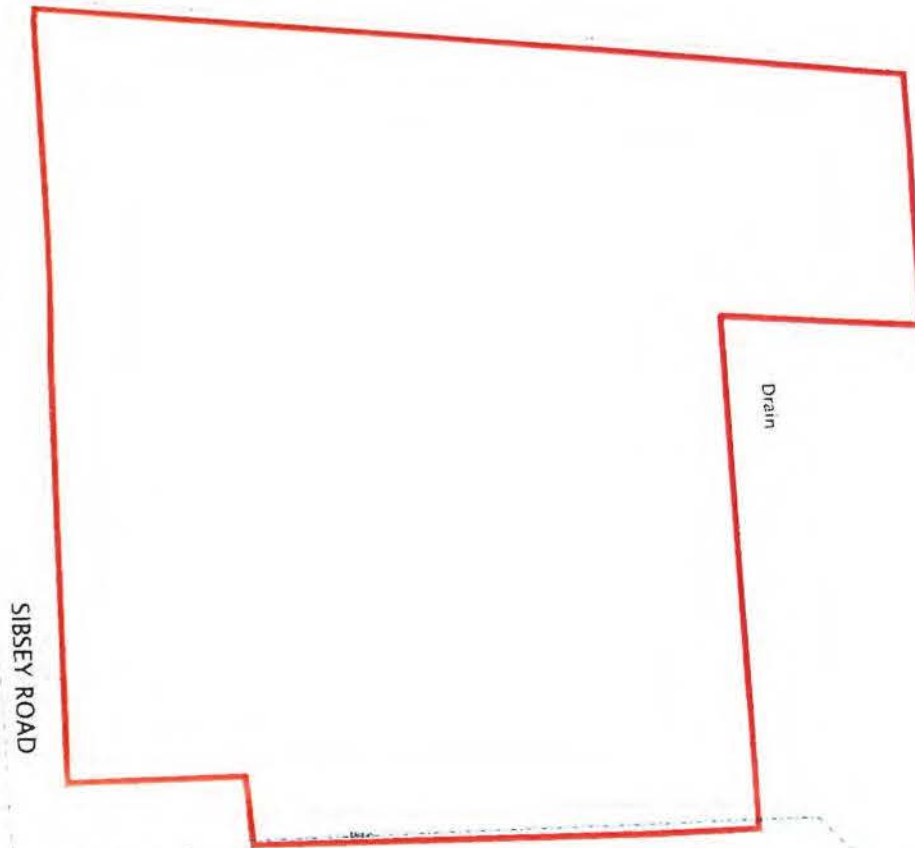

Drain

Pond

Burton Hall

WAINLIFT ROAD

Drain