

Public Notice

Notice is hereby given that Lincolnshire County Council proposes to grant a licence, under powers contained in the Business and Planning Act 2020.

Indre Estrameckyte gave notice on 19 May 2026 by applying to Lincolnshire County Council for a 'Pavement Licence' at: 10 South Street, Boston, PE21 6HE known as Sushi Crush.

The application is for:

- Tables: 3
- Chairs: 6
- Patio heaters: 0
- Parasols or umbrellas: 0
- Planters: 1/2
- Litter bins: 0
- Barriers or balustrades: 0
- Sales counters: 0

In an enclosure measuring:

- Length in metres: 3.2
- Width in metres: 1

Between the following hours:

- Monday: 10am to 10pm
- Tuesday: 10am to 10pm
- Wednesday: 10am to 10pm
- Thursday: 10am to 10pm
- Friday: 10am to 10pm
- Saturday: 10am to 10pm
- Sunday: 10am to 10pm

Public consultation will end in 14 days.

[Please use this link to provide feedback.](#)

Reference number: PCL000390

Access code: wI9-cZw-jUH

Sushi Crush – Pavement Café Licence Plans

Submitted documents for pavement café licence application
10 South Street, Boston, PE21 6HE

1. Furniture Plan (Scale 1:100)

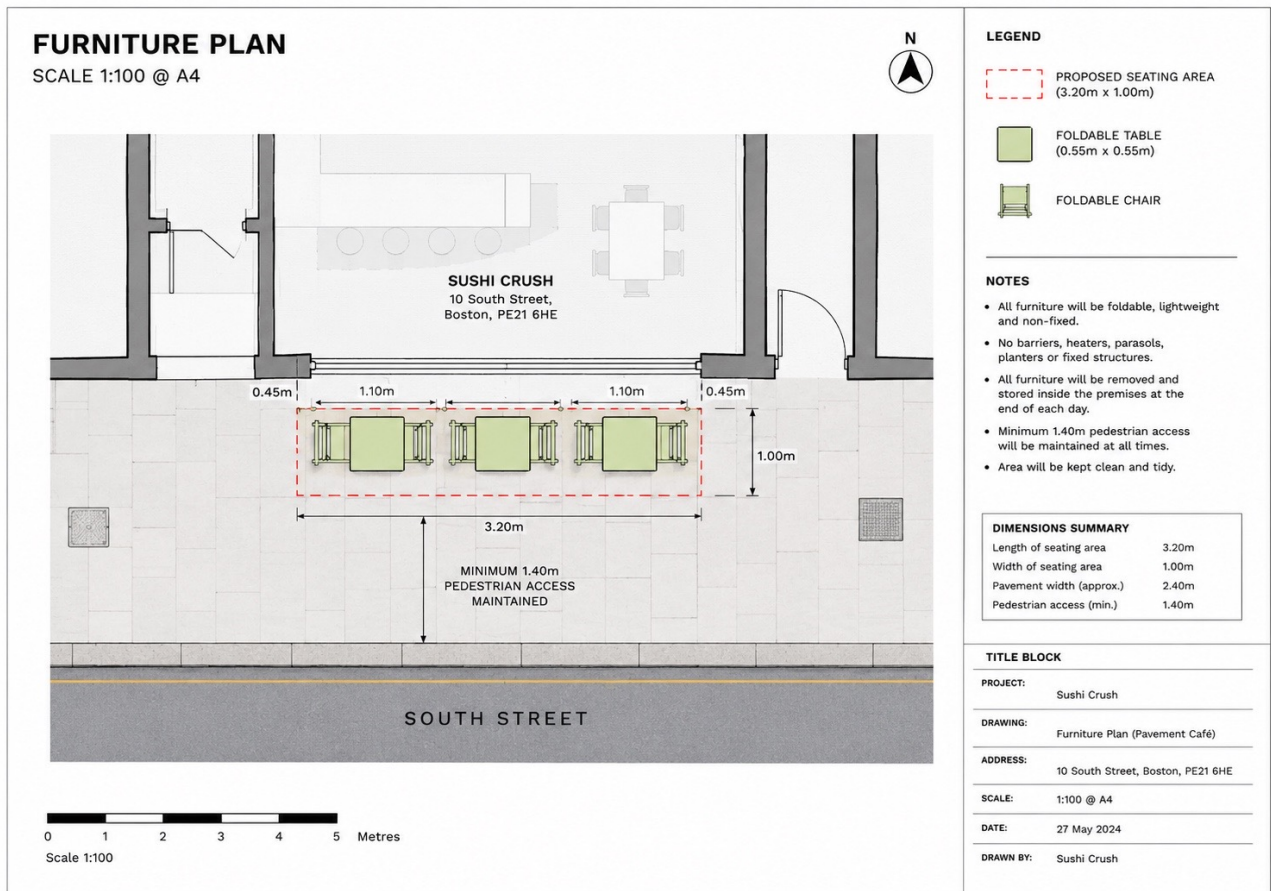

2. OS Base Site Location Plan (Scale 1:1250)

OS BASE SITE LOCATION PLAN

SCALE 1:1250 @ A4

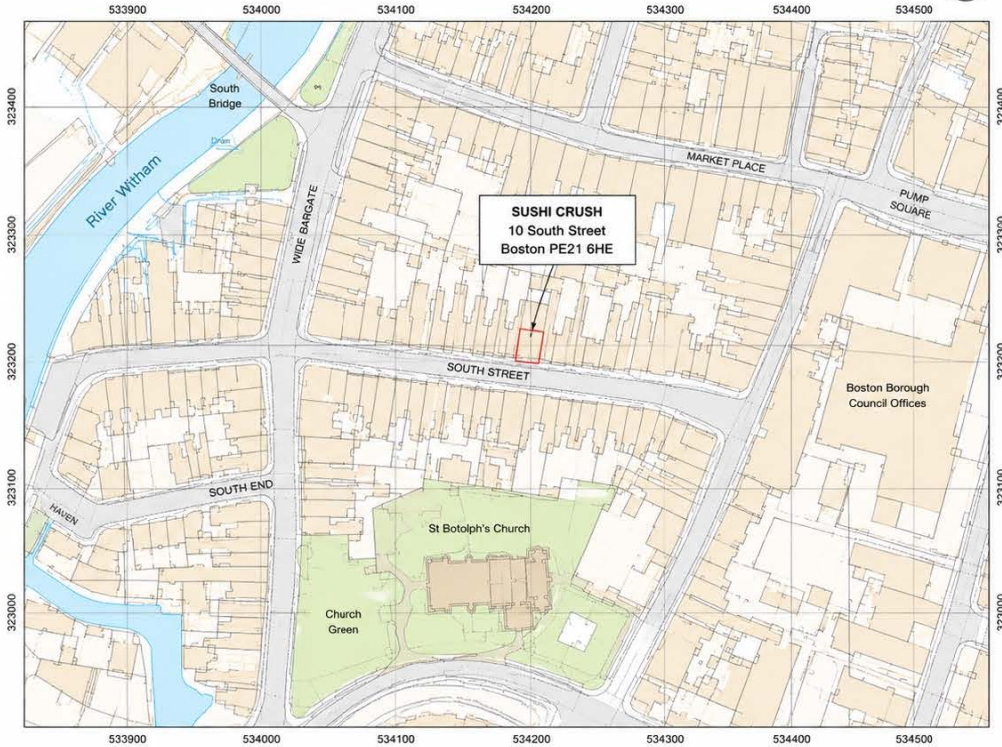

Scale 1:1250

© Crown copyright and database rights 2024 Ordnance Survey 0100031673.
You are not permitted to copy, sub-license, distribute or sell any of this data to third parties in any form.

LEGEND

 SITE LOCATION
10 South Street,
Boston PE21 6HE

SITE LOCATION

The site is located on the north side of South Street, Boston.

Grid Reference (approx. centre of site):
534200, 323200

TITLE BLOCK

PROJECT: Sushi Crush
DRAWING: OS Base Site Location Plan
ADDRESS: 10 South Street
Boston PE21 6HE
SCALE: 1:1250 @ A4
DATE: 27 May 2024
DRAWN BY: Sushi Crush

NOTES

This plan is based on Ordnance Survey OS MasterMap Topography.
All rights reserved.
Licence number 0100031673.