

**ROAD TRAFFIC REGULATION ACT 1984**  
**LINCOLNSHIRE COUNTY COUNCIL**  
**(INGOLDMELLS – ANCHOR LANE)**  
**(30MPH SPEED LIMIT) ORDER 2026**

The LINCOLNSHIRE COUNTY COUNCIL in exercise of their powers under Sections 84 (1) and (2) of the Road Traffic Regulation Act 1984, (hereinafter referred to as "the Act") and of all other enabling powers, after consultation with the Chief Officer of Police in accordance with Part III of Schedule 9 to the Act hereby make the following Order:-

1. This Order may be cited as the Lincolnshire County Council (Ingoldmells – Anchor Lane) (30mph Speed Limit) Order 2026 and shall come into operation on 20.
2. No person shall drive any motor vehicle at a speed exceeding 30mph on the length of road specified in the Schedule to this Order.
3. No speed limit imposed by this Order applies to vehicles falling within regulation 3 (4) of the Road Traffic Exemptions (Special Forces) (Variation and Amendment) Regulations 2011 when used in accordance with regulation 3 (5) of those regulations.

THE COMMON SEAL of the LINCOLNSHIRE )  
COUNTY COUNCIL was hereunto affixed )  
in the presence of:- )

Authorised Officer

## SCHEDULE

### Anchor Lane

From its junction with the A52 to a point 655m northeast of its junction with Merrills Way

DRAFT

DATED

ROAD TRAFFIC REGULATION ACT 1984

LINCOLNSHIRE COUNTY COUNCIL

(INGOLDMELLS – ANCHOR LANE)

(30MPH SPEED LIMIT) ORDER 2026

DRAFT

Lincolnshire County Council

County Offices

Lincoln

# **PUBLIC NOTICE**

## **LINCOLNSHIRE COUNTY COUNCIL (INGOLDMELLS – ANCHOR LANE) (30MPH SPEED LIMIT) ORDER 2026**

NOTICE IS HEREBY GIVEN that the Lincolnshire County Council propose to make an Order under their powers contained in the Road Traffic Regulation Act 1984, the effect of which will be to restrict the speed of vehicles to 30mph along Anchor Lane, Ingoldmells.

A copy of the plan showing the lengths of road concerned along with a Statement of Reasons for proposing to make the Order may be inspected on our website: [www.lincolnshire.gov.uk/trafficorders](http://www.lincolnshire.gov.uk/trafficorders)

If you are unable to view our website the documents can be supplied to you by contacting us using the contact details below or calling our Customer Service Centre on 01522 782070 during office hours.

Objections or representations to the proposals, together with the grounds on which they are made, must be made in writing to Chief Executive - Lincolnshire County Council, Lancaster House, 36 Orchard Street, Lincoln, LN1 1XX or Email: TRO@lincolnshire.gov.uk (For the attention of: Miss K Fraser, Traffic Orders Section) by **Monday 6<sup>th</sup> July 2026**

**LINCOLNSHIRE COUNTY COUNCIL  
(INGOLDMELLS – ANCHOR LANE)  
(30MPH SPEED LIMIT) ORDER 2026**

**STATEMENT OF REASONS**

- When comparing the conditions to the current speed limit policy, a 30mph speed limit is recommended.
- Therefore, in accordance with the County Council's Policy, it is proposed to introduce a 30mph speed limit as per the schedule in the Order.
- The Chief Constable, Ingoldmells Parish Council and East Lindsey District Council have been consulted, along with other local groups/companies.



Key:

	Proposed 30mph Speed Limit
	Existing 30mph Speed Limit
	Existing 40mph Speed Limit

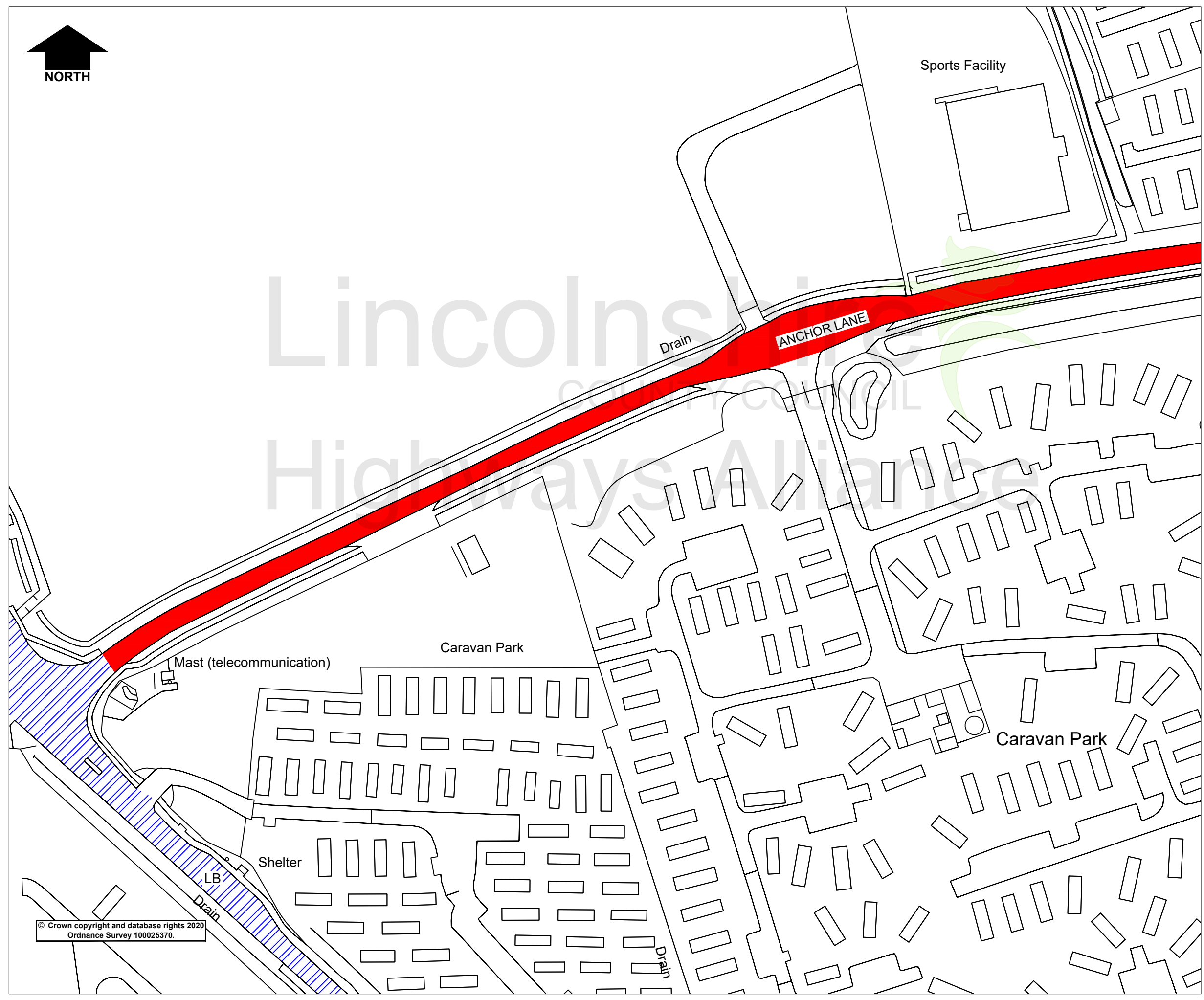

© Crown copyright and database rights 2020  
Ordnance Survey 100025370.

Rev.	Description	Drawn	Ch'kd	Auth	Date
Project <b>Anchor Lane, Ingoldmells</b>					
Status		Project No. <b>2222</b>			
Drawing Title <b>Proposed 30mph Speed Limit</b>					
Scale		Drawn <b>KF</b>		Date <b>26/02/26</b>	
NTS @A3		Ch'kd		Date	
		Auth		Traced	
Drawing No. <b>H/KF/2222/001</b>				Rev. <b>0</b>	

**Lincolnshire**  
COUNTY COUNCIL   
**Highways Alliance**  
Lancaster House, 36 Orchard Street,  
Lincoln, LN1 1XX



**Key:**

- Proposed 30mph Speed Limit
- Existing 30mph Speed Limit
- Existing 40mph Speed Limit

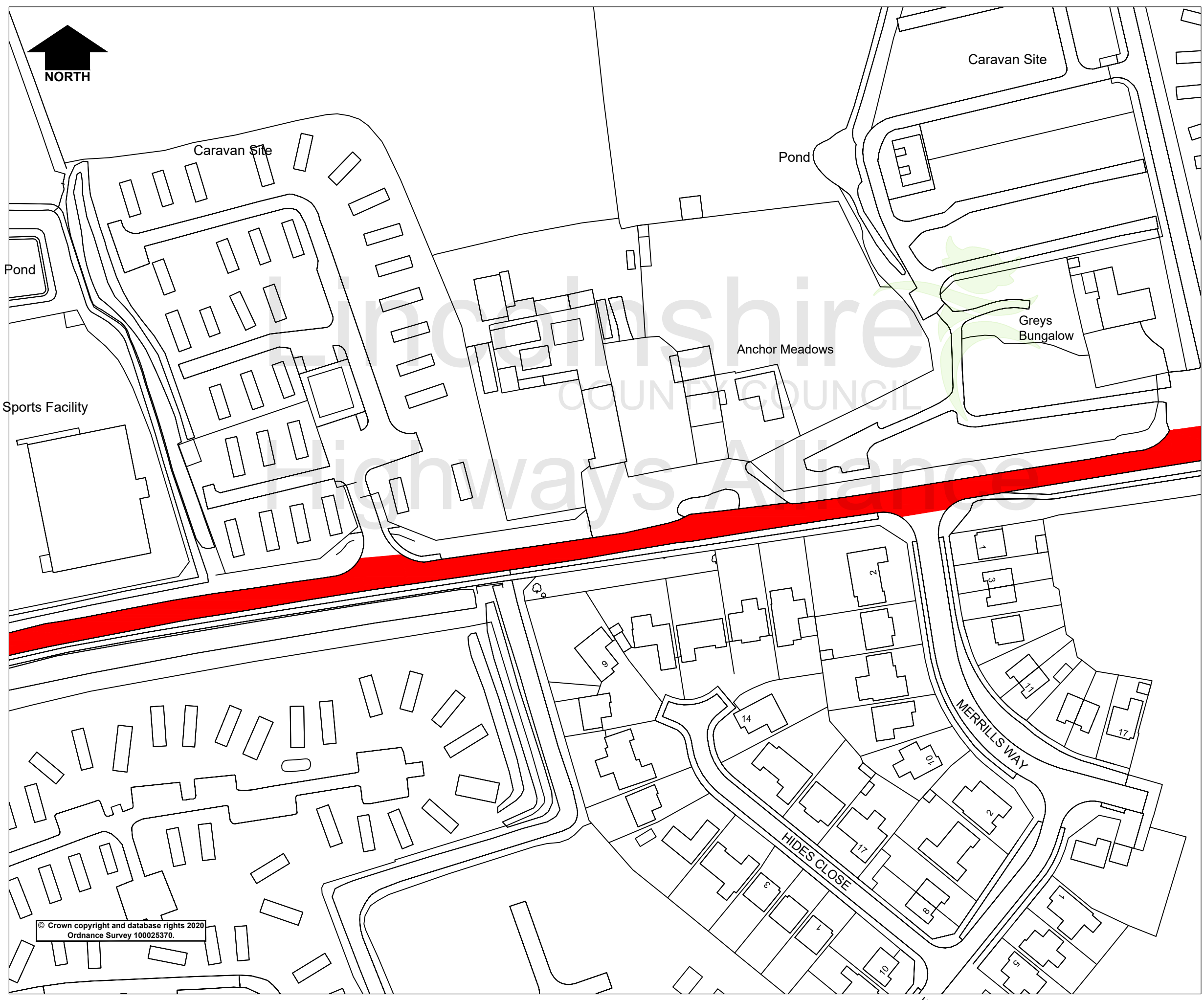

© Crown copyright and database rights 2020  
Ordnance Survey 100025370.

Rev.	Description	Drawn	Ch'kd	Auth	Date
Project <b>Anchor Lane, Ingoldmells</b>					
Status		Project No. <b>2222</b>			
Drawing Title <b>Proposed 30mph Speed Limit</b>					
Scale		Drawn <b>KF</b>		Date <b>26/02/26</b>	
<b>NTS @A3</b>		Ch'kd		Date	
		Auth		Traced	
Drawing No. <b>H/KF/2222/002</b>				Rev. <b>0</b>	

**Lincolnshire**  
COUNTY COUNCIL

**Highways Alliance**

Lancaster House, 36 Orchard Street,  
Lincoln, LN1 1XX

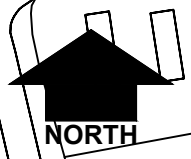

Country Meadows  
Caravan Park

Play Area

The Beeches

ANCHOR LANE

ESS

Ppg  
Sta

Drain

Drain

© Crown copyright and database rights 2020  
Ordnance Survey 100025370.

**Key:**

- Proposed 30mph Speed Limit
- Existing 30mph Speed Limit
- Existing 40mph Speed Limit

Rev.	Description	Drawn	Ch'kd	Auth	Date
<b>Anchor Lane, Ingoldmells</b>					
Project					
Status		Project No. 2222			
<b>Proposed 30mph Speed Limit</b>					
Scale		Drawn KF		Date 26/02/26	
NTS @A3		Ch'kd		Date	
Drawing No.		Auth		Traced	
H/KF/2222/003				Rev. 0	

**Lincolnshire**  
COUNTY COUNCIL

**Highways Alliance**

Lancaster House, 36 Orchard Street,  
Lincoln, LN1 1XX



**Key:**

- Proposed 30mph Speed Limit
- Existing 30mph Speed Limit
- Existing 40mph Speed Limit

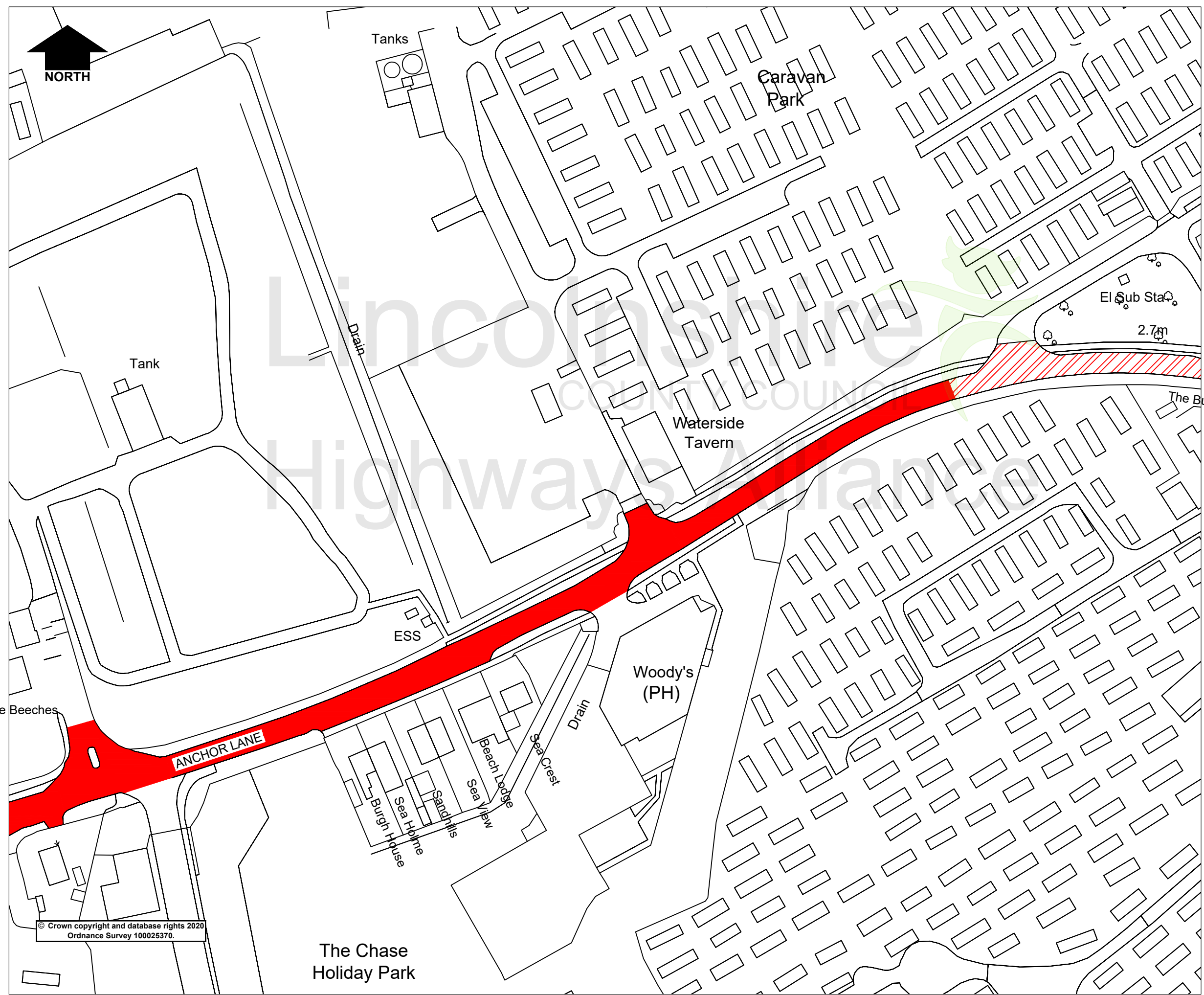

Rev.	Description	Drawn	Ch'kd	Auth	Date
Project: <b>Anchor Lane, Ingoldmells</b>					
Status: Project No. <b>2222</b>					
Drawing Title: <b>Proposed 30mph Speed Limit</b>					
Scale: <b>NTS @A3</b>		Drawn: <b>KF</b>	Date: <b>26/02/26</b>		
Drawing No.: <b>H/KF/2222/004</b>		Ch'kd:		Rev.: <b>0</b>	

© Crown copyright and database rights 2020  
Ordnance Survey 100025370.

**Lincolnshire**  
COUNTY COUNCIL

**Highways Alliance**

Lancaster House, 36 Orchard Street,  
Lincoln, LN1 1XX