

✓

STATUTORY DECLARATION
SEC 31(6) HIGHWAYS ACT 1980

I, Peter David Rushmer FRICS FAAV, for and on behalf of the SECRETARY OF STATE FOR DEFENCE and acting under the authority conferred upon me by the said Secretary of State DO SOLEMNLY AND SINCERELY DECLARE THAT:

1. The land known as RAF Holbeach in the County of Lincolnshire and shown edged in red colour on the map attached hereto is vested in the said Secretary of State for Defence.

2. The route shown on the map and marked in purple is a public footpath dedicated to the public and that there is no other route over the land shown on the map which is dedicated to the public.

3. I make this statement for the purposes of Section 31(6) of the Highways Act 1980 AND I MAKE this solemn declaration conscientiously believing the same to be true and by virtue of the Statutory Declarations Act 1835.

DECLARATION MADE AT)
1 Oxford Street Nottingham)
this twenty eighth day of)
November 1995)
Before [redacted])
A practising Solicitor)
or Commissioner for Oaths)

[redacted]
Signature

for and on behalf of
The Secretary of State for Defence

SECT3105.NCB

23NCB12Y.11

54000m

LONG
0 05 E

LINCOLNSHIRE

PARTS OF HOLLAND ADMIN CO

The Wash

EAST ELLOE RD

HOLLAND WITH BOST

335000m

41

06

42

07

43

44

HOLBEACH CP

34

33

Mud

Bombing Range

Sea Bank

Old Sea Bank

Lawyers Farm

Thimbleby House

St Matthew's Church

Pumping Station

NTL

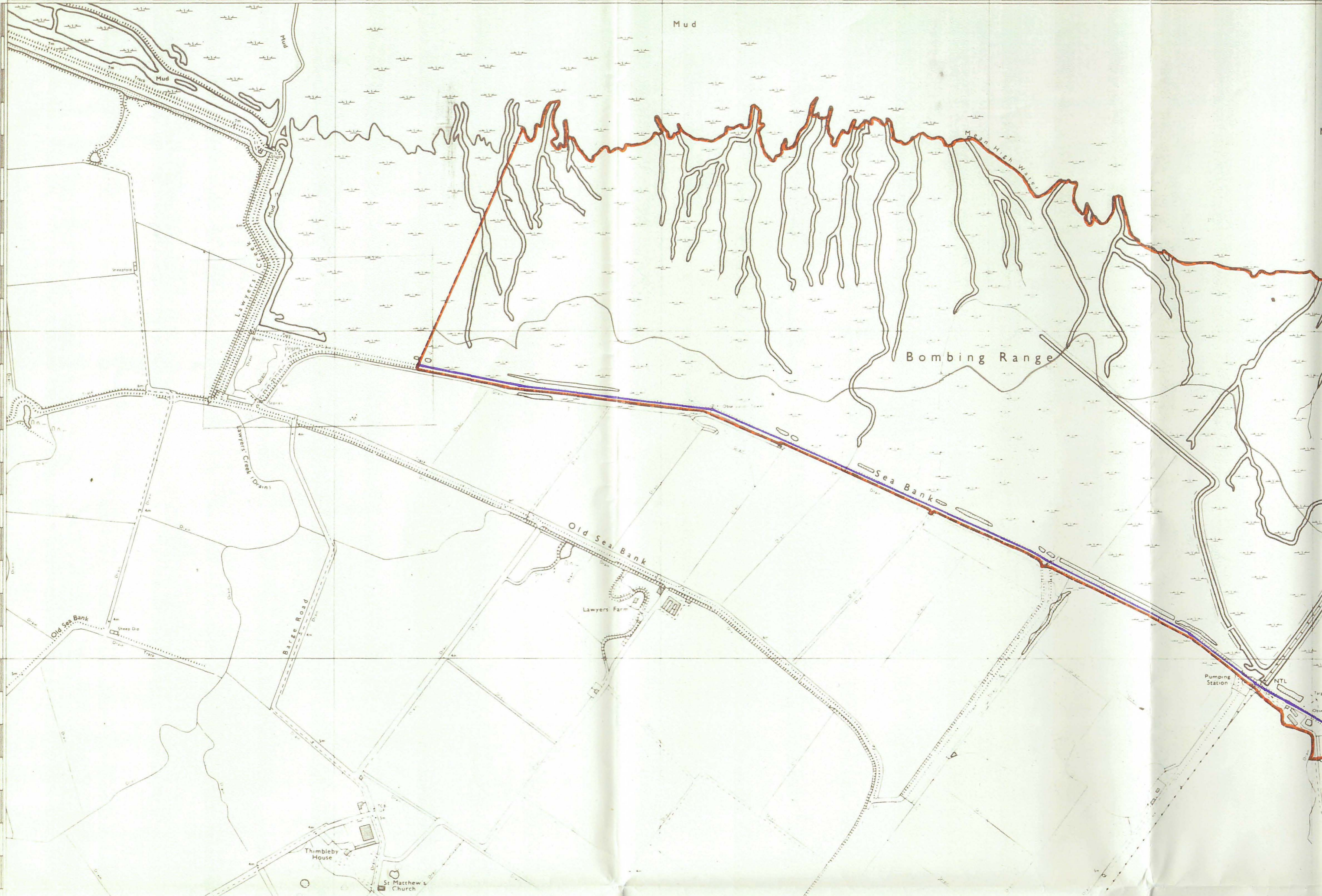





HIGHWAYS ACT 1980, SECTION 31 (6)

MINISTRY OF DEFENCE FREEHOLD ESTATE

Extent of Public Rights recognised by Secretary of State for Defence

LEGEND

RAF HOLBEACH, LINCOLNSHIRE

- MOD Boundary 
- Footpaths 
- Bridleways
- Roads used as public footpaths
- Byways open to all traffic
- Public roads other than byways

Scale 1 : 10,000

Compiled from OS
National Grid Sheet:
TF 43 SW & TF 43 SE

**IMPORTANT: THIS PLAN MUST
NOT BE COPIED OR REPRODUCED
WITHOUT PRIOR WRITTEN CONSENT
FROM THE OFFICE OF ORIGIN**

Reproduced from the Ordnance Survey plan
with the permission of the Controller of H. M.
Stationary Office. Crown Copyright Reserved.
GD 03146G

Produced by:
DLS (East), Nottingham, Spur E, Block 5, Government Buildings
Chalfont Drive, Nottingham NG8 3RP

NOTE: PLAN TO BE READ IN CONJUNCTION WITH STATUTORY DECLARATION DATED 28.11.95...

PLAN ... of ...

32

31

LAT
52 51

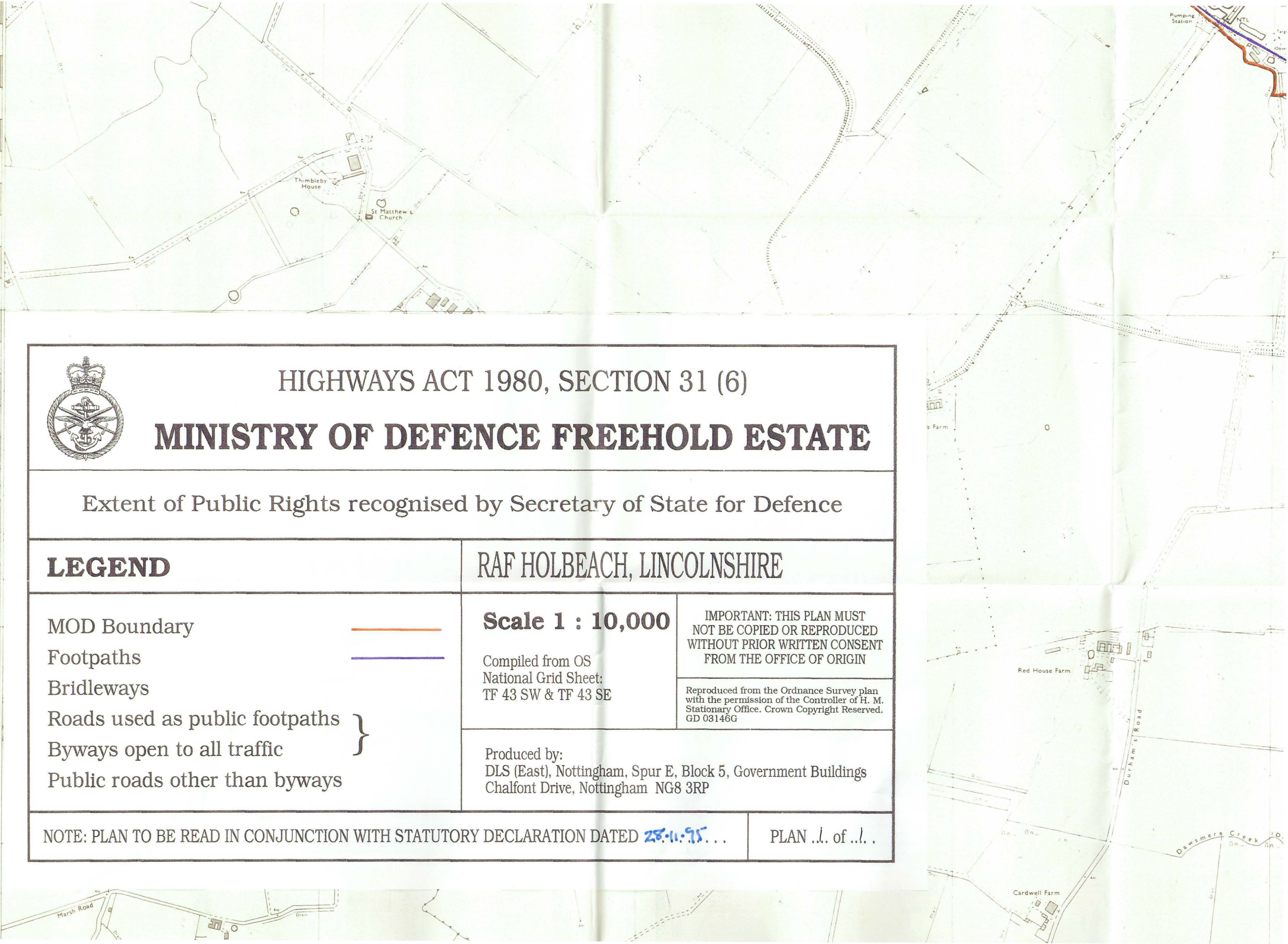

Mud

Mud

Mud

Mud

Mud

Mud

Old Sout

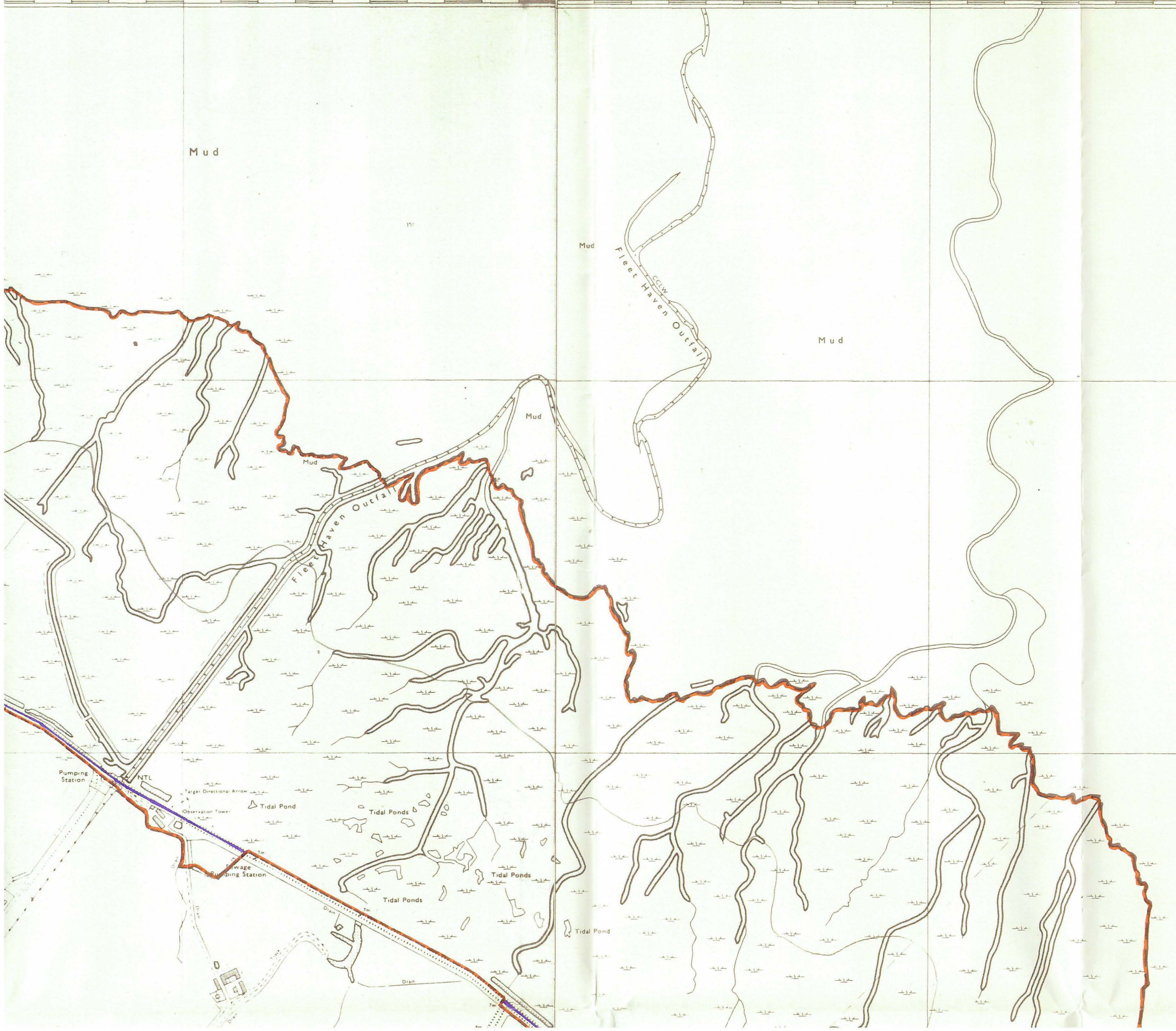

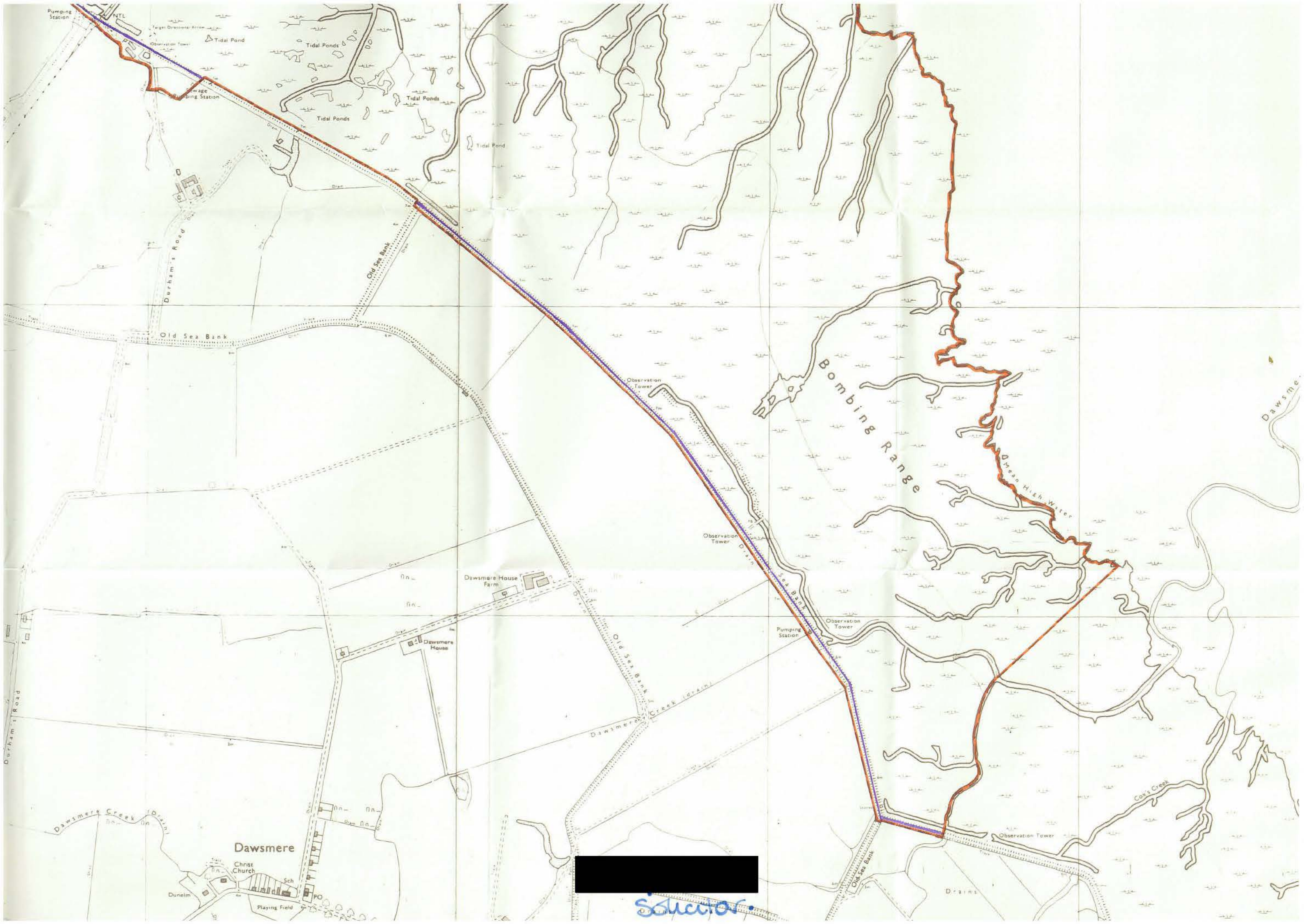

[Redacted]

solution

**FORM OF STATUTORY DECLARATION USED IN PRESERVING
MOD RIGHTS IN ITS PRIVATE ROADS AND FOOTPATHS USED BY
THE GENERAL PUBLIC
(See MM19(2)1204)**

I, ROBIN STUART BERRY, for and on behalf of THE SECRETARY OF STATE FOR DEFENCE, and acting under the authority conferred upon me by the said Secretary of State DO SOLEMNLY AND SINCERELY DECLARE as follows:

1. The Secretary of State for Defence on the 23rd day of March 2001 in accordance with Section 31(6) of the Highways Act 1980 caused to be deposited with the Lincolnshire Council Council a map of certain Establishments vested in the said Secretary of State within the area administered by such Council together with a statement indicating what ways (if any) over that land the said Secretary of State admitted to have been dedicated as highways.

2. No additional way other than the ways described in the Schedule herein contained and indicated on the plan annexed to this Declaration over the land delineated on the map so deposited with the Council has been dedicated as a highway since the 28th day of November 1995 being the date of the lodgement in accordance with the said Section of a previous Declaration made in respect of the said land
AND I MAKE this solemn declaration conscientiously believing the same to be true and by virtue of the provisions of the Statutory Declarations Act 1835

THE SCHEDULE above referred to

The ways shown on the plan annexed hereto by a line the extent of the public right[s] granted by the dedication being as indicated by the legend on the said plan

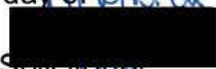
DECLARED at 18 THE BROADWAY
S. IVSA (Andrew J. Roberts) G. B. H. H. C.
this 23rd day of March 2001)
Before me, )
A Practising Solicitor)
Commissioner for Oaths)

ANDREW J. ROBERTS

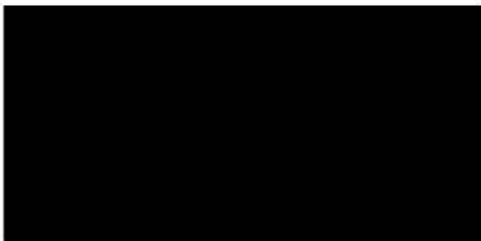

[Signature of Declarant]
for and on behalf of THE
SECRETARY OF STATE FOR
DEFENCE

541000

542000

543000

544000

545000

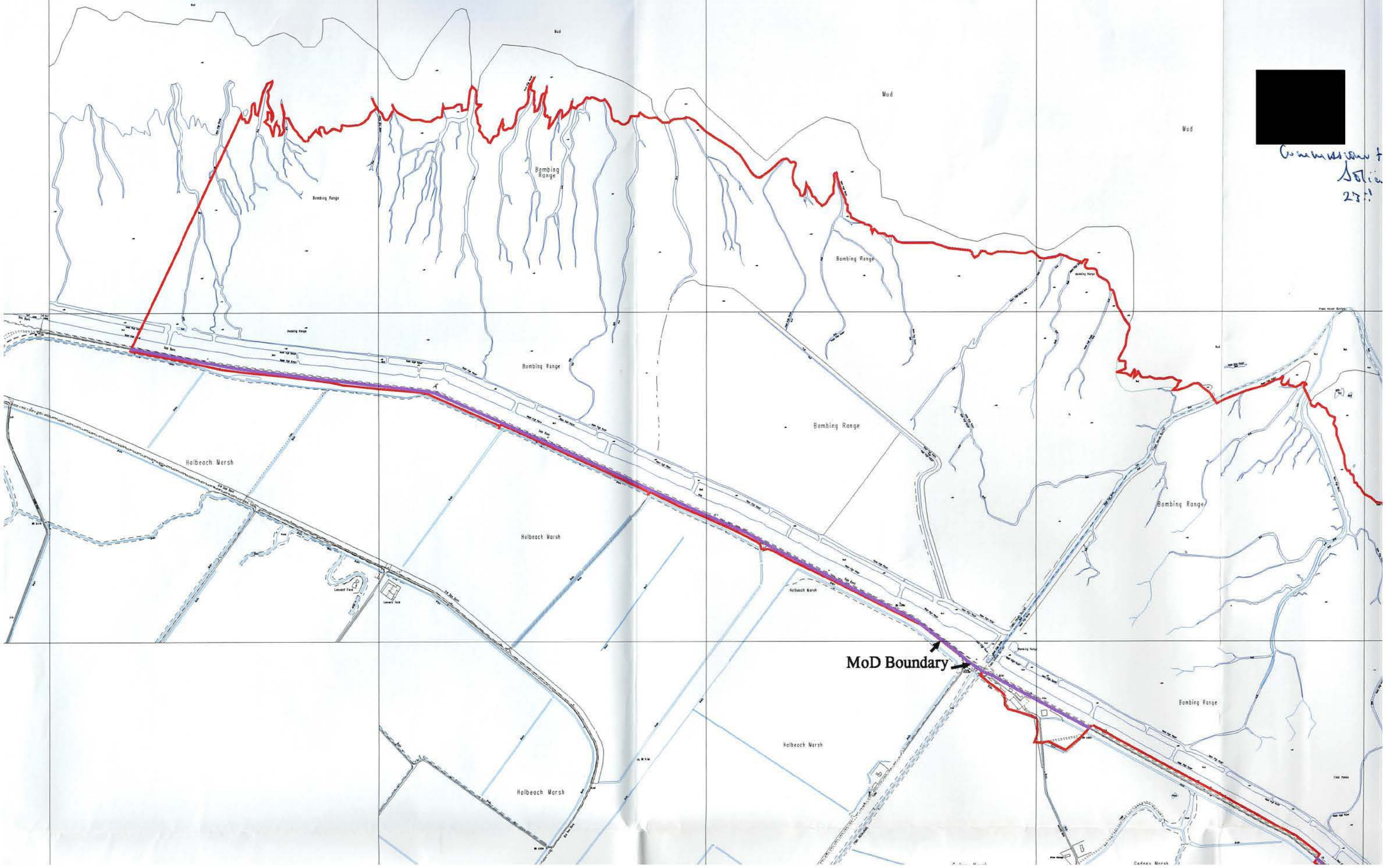

*Coastal Defence
Solic
23!*

MoD Boundary

Bombing Range

Halbeach Marsh

Halbeach Marsh

Halbeach Marsh

Halbeach Marsh

Bombing Range

Bombing Range

Cadeau Marsh

Mud

Mud

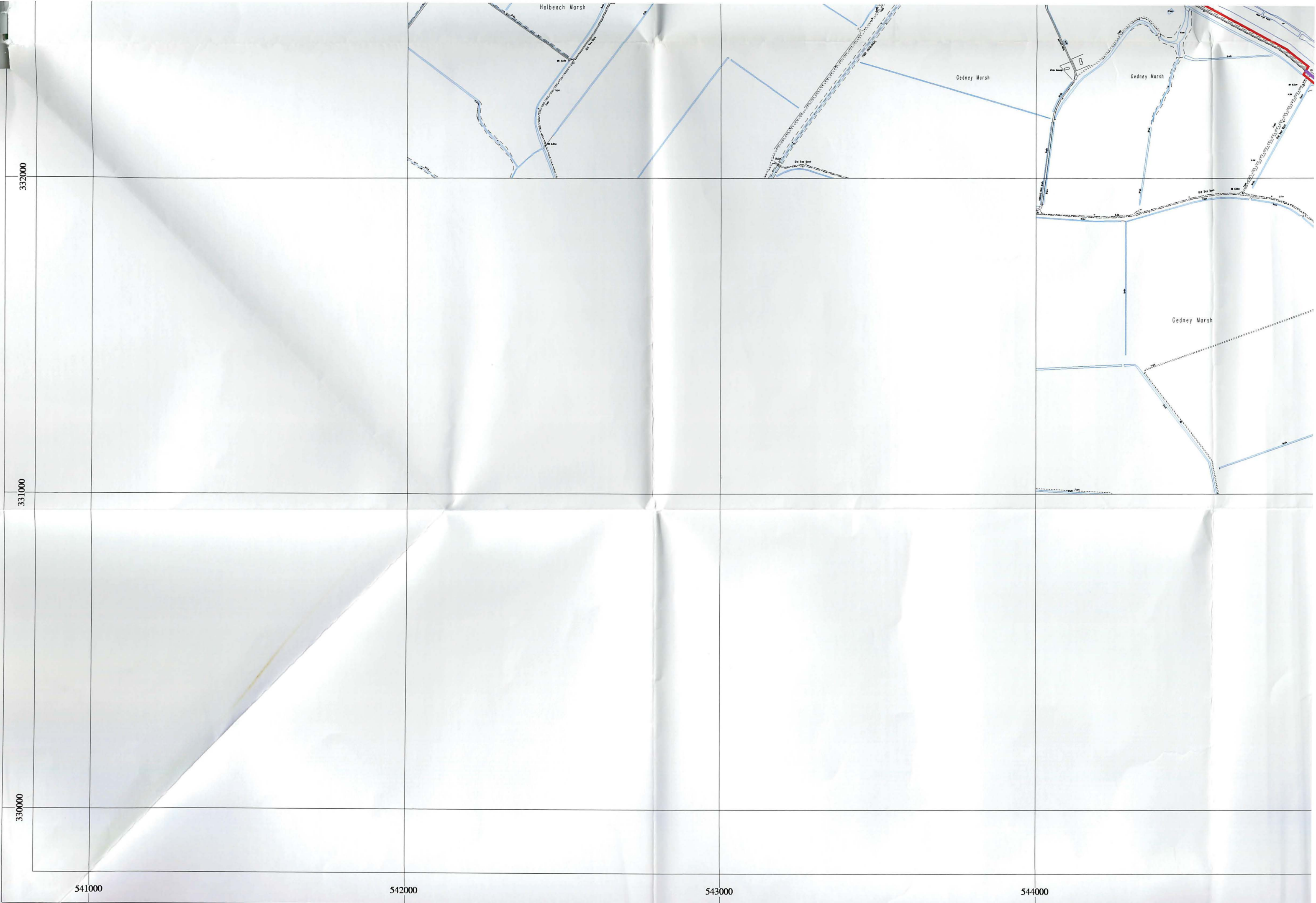

545000

546000

547000

335000

334000

333000

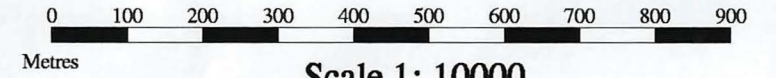

Scale 1: 10000



Handwritten:
 Submission for Oath
 Solicitor
 23rd March 2001.

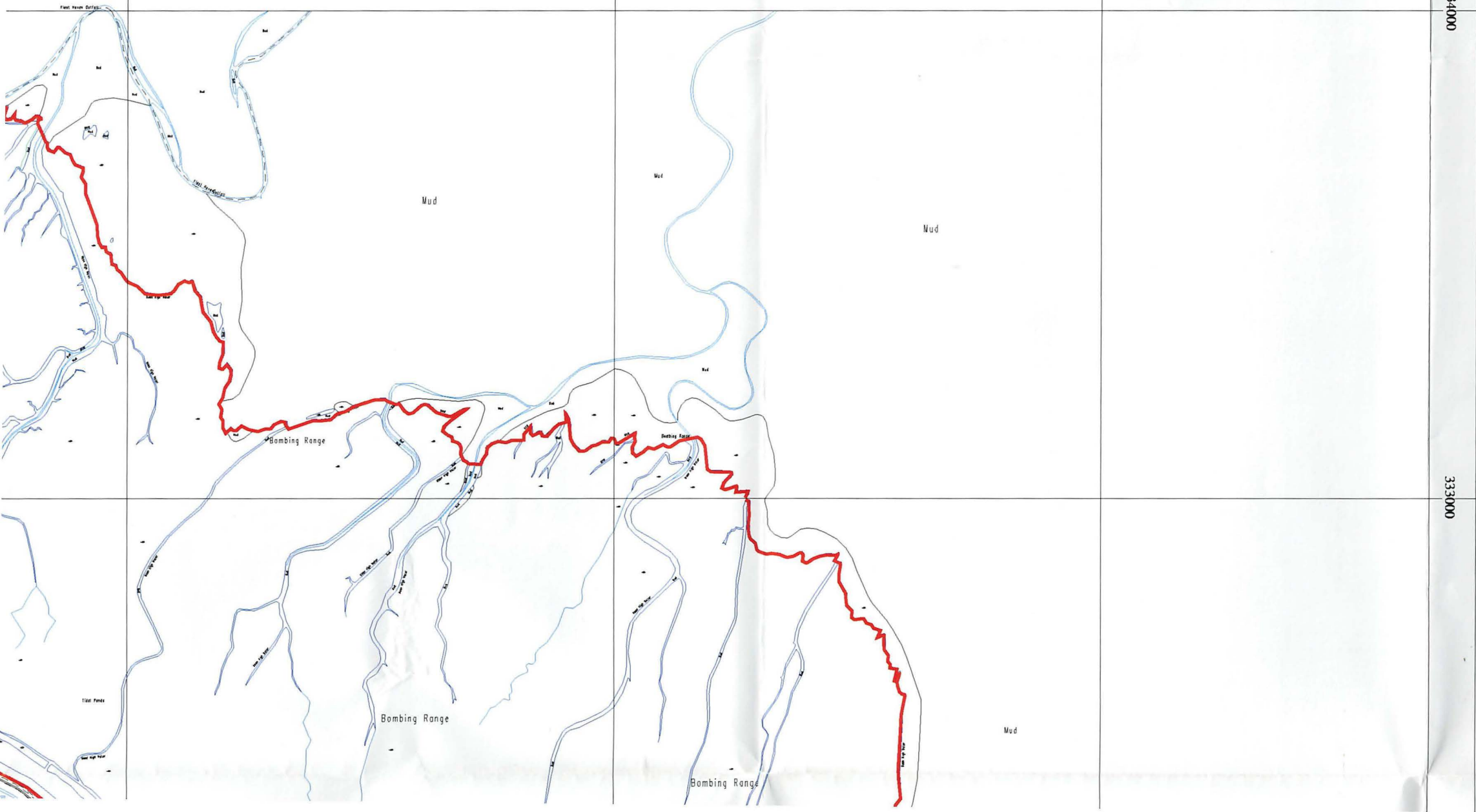

HIGHWAYS ACT 1980, SECTION 31 (6)
Ministry of Defence Freehold Estate

Extent of Public Rights recognised by
 the Secretary of State for Defence

Legend

MOD Boundary

Footpaths

Bridleways

Roads used as public footpaths



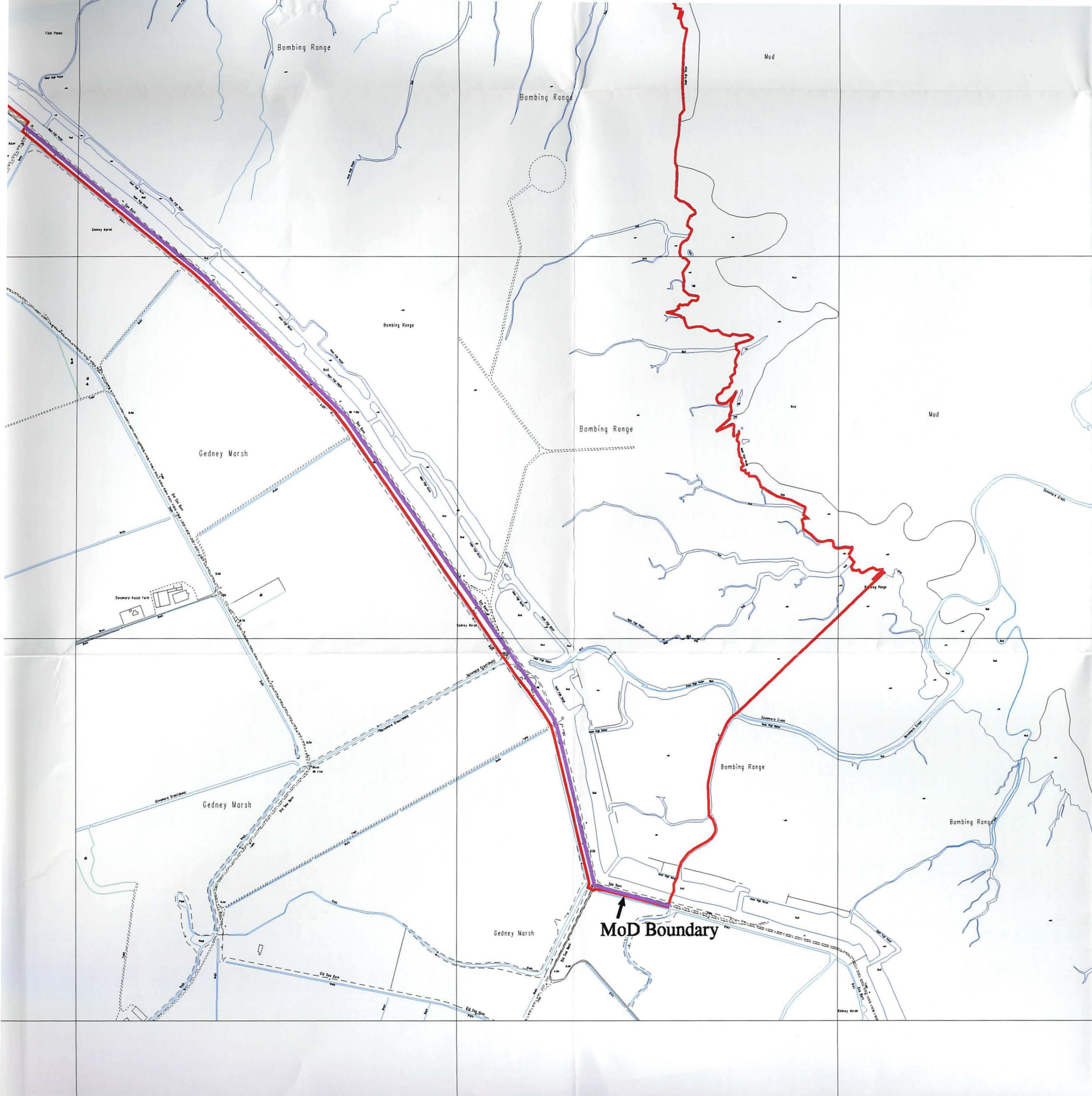

- Footpaths
- Bridleways
- Roads used as public footpaths }
- Byways open to all traffic }
- Public roads other than byways

NOTE:
 PLAN TO BE READ IN CONJUNCTION WITH
 STATUTORY DECLARATION DATED.....



Public Rights of Way
RAF Holbeach
 Lincolnshire
 Grid Ref: TF 4432
 Scale 1: 10000

**MINISTRY OF DEFENCE
 DEFENCE ESTATES (EAST)
 STIRLING HOUSE, DENNY END ROAD
 WATERBEACH, CAMBS. CB5 9QE**

This map is reproduced from The Ordnance Survey map by Defence Estates with the permission of the Controller of Her Majesty's Stationery Office, © Crown Copyright. Unauthorised reproduction infringes Crown Copyright and may lead to prosecution or civil proceedings.
 Licence Number GD3189G