

Parish: Theddlethorpe All Saints
Title: Land at Theddlethorpe All Saints
Reference number: CA/7/1/106

**DEPOSIT OF MAP AND STATEMENT UNDER SECTION 31(6) OF THE HIGHWAYS
ACT 1980**

Details about the Deposit

Landowner's name: Mr R Unsworth
Landowner's address: White House Farm, Saltfleetby, Louth, Lincs LN11 7SN
Date of deposit of the map and statement: 10 April 1996
Date on which the map and statement expires: 09 April 2002

Geographic Location

Grid Reference: TF 459 871
Address(es) and postcode of any buildings on the land:
Postcodes covering the area land: LN12 1
Principal city or town nearest to land: Louth
Parish: Theddlethorpe All Saints
Electoral Division: Louth Marsh
District: East Lindsey

**DEPOSIT OF A STATUTORY DECLARATION UNDER SECTION 31(6) OF THE
HIGHWAYS ACT 1980**

Landowner's name: Mr R Unsworth
Landowner's address: White House Farm, Saltfleetby, Louth, Lincs LN11 7SN
Date on which the Statutory Declaration expires: 22 April 2002

**DEPOSIT OF A STATUTORY DECLARATION UNDER SECTION 31(6) OF THE
HIGHWAYS ACT 1980**

Landowner's name: Mr R Unsworth
Landowner's address: White House Farm, Saltfleetby, Louth, Lincs LN11 7SN
Date on which the Statutory Declaration expires: 15 March 2022

COUNTY COUNCIL'S CONTACT DETAILS

Section: Public Rights of Way and Countryside Access Section
Department: Communities
Address: Lincolnshire County Council, 4th Floor, City Hall, LINCOLN LN1 1DN
Telephone: 01522 782070
E-mail: countryside_access@lincolnshire.gov.uk

ELECTRONIC REGISTER

Government legislation requires that details of maps and statements and Statutory Declarations deposited with Lincolnshire County Council under Section 31(6) of the Highways Act 1980 be made available for viewing by the public on the authority's website. This Register will be updated with any new deposits lodged with the County Council. The Register is also available to be viewed in hard copy format together with the actual documents at City Hall. If you have any queries about this register or the details contained in it, please telephone 01522 782070.

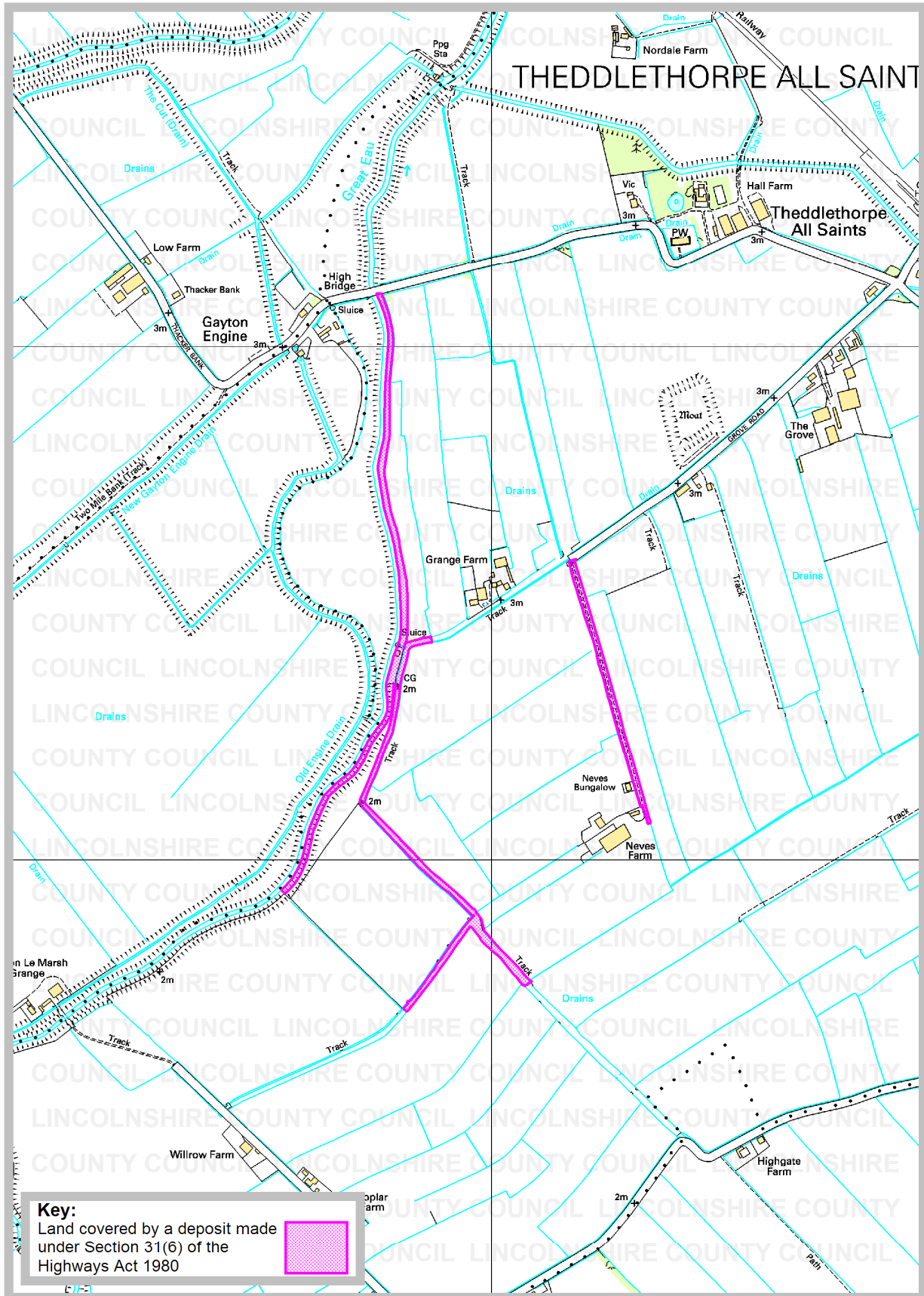

Key:
 Land covered by a deposit made
 under Section 31(6) of the
 Highways Act 1980



Rights of Way & Countryside Access
 Director of Development: RA Wills
 City Hall, Orchard Street,
 Lincoln LN1 1DN

Title: Land at Theddlethorpe All Saints

Ref: CA/7/1/106
 Grid Ref: TF 459 871
 Scale: approx. 1:10000