

DATE OF DEPOSIT 04/01/1994

DEPOSIT OF STATEMENT AND PLAN

SECTION 31(6) OF THE HIGHWAYS ACT 1980

To: Lincolnshire County Council
County Offices
Newland
Lincoln
LN1 1YL

1. Midland Bank Pension Trust Limited whose Registered Office is at Poultry, London, EC2 is, and has been since 28 July 1981, the owner within the meaning of the above Section of the land known as Home Farm, Ashby de la Launde, Lincoln, more particularly delineated on the plan accompanying this statement and thereon edged red.
2. I Bennett Alan Felix Swayne, Partner in the firm of Smiths Gore of The King's Lodging, Minster Precincts, Peterborough, PE1 1XT, am the managing land agent for the owner and have managed the property on its behalf since 28 July 1981 and I am fully familiar with all matters relating to the Title of the property including rights of way affecting it.
3. The aforementioned land lies in the parishes of Ashby de la Launde and Bloxholm and Digby.
4. The way coloured blue on the said plan has been dedicated as Highway with vehicular status.
5. The ways coloured yellow on the said plan have been dedicated as footpaths.
6. The deposit shall comprise this statement and accompanying plan.

Signature



Date

30 December 1993

Name: Bennett Alan Felix Swayne

Address: The King's Lodging, Minster Precincts, Peterborough, PE1 1XT

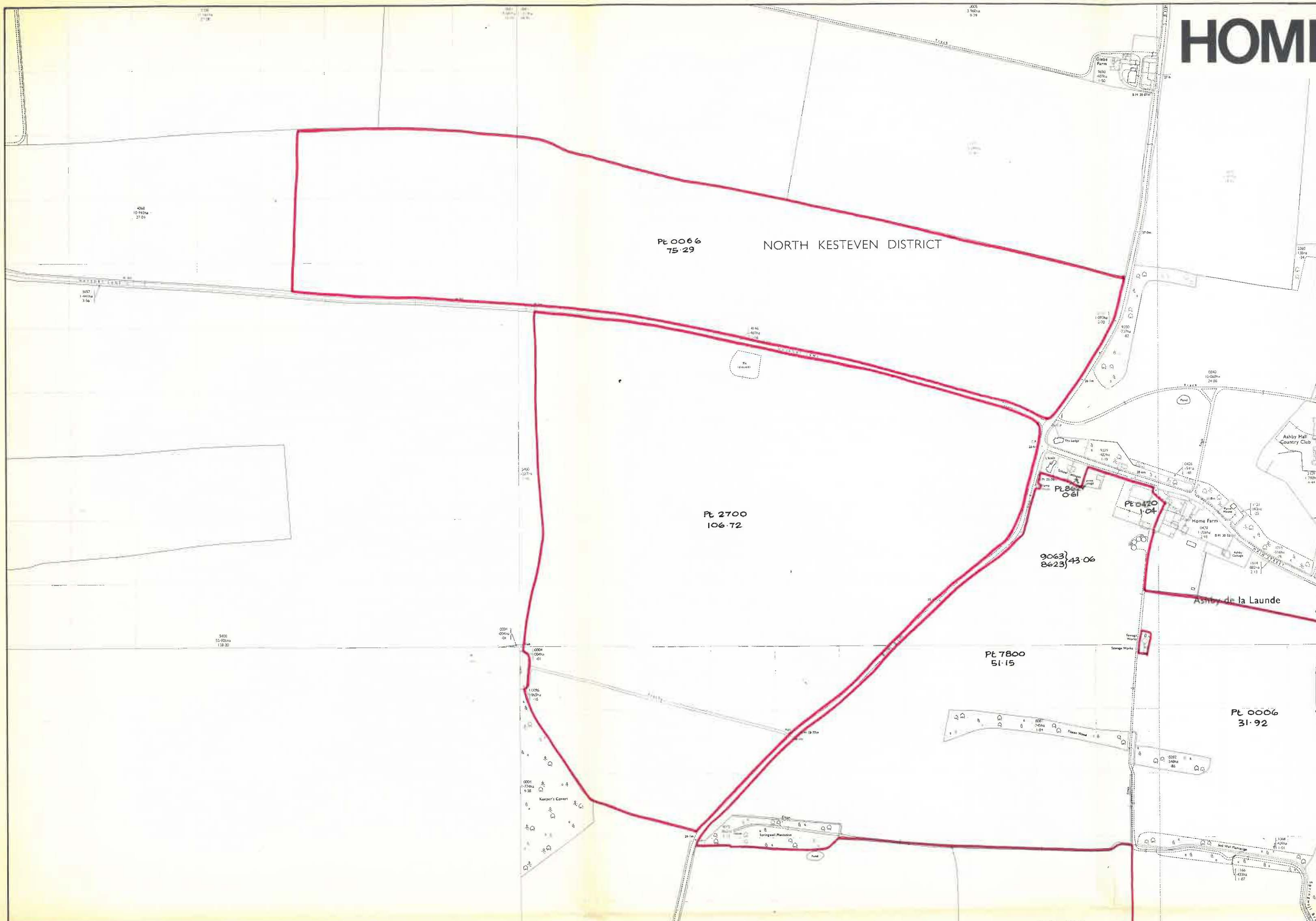

Pt 0066
75.29

NORTH KESTEVEN DISTRICT

Pt 2700
106.72

Pt 7800
51.15

Pt 0006
31.92

Pt 0420
1.04

9063
8623 } 43.06

Pt 8606
0.61

Ashby de la Launde

Home Farm

Ashby Hall
Country Club

ASHBY DE LA LAUNDE AND BLOXHOLM C P

0005
55.80



SCALE 1:5,000

Based upon the Ordnance Survey map by Cook, Hammond & Kell with the permission of the Controller of Her Majesty's Stationery Office. Crown Copyright reserved.

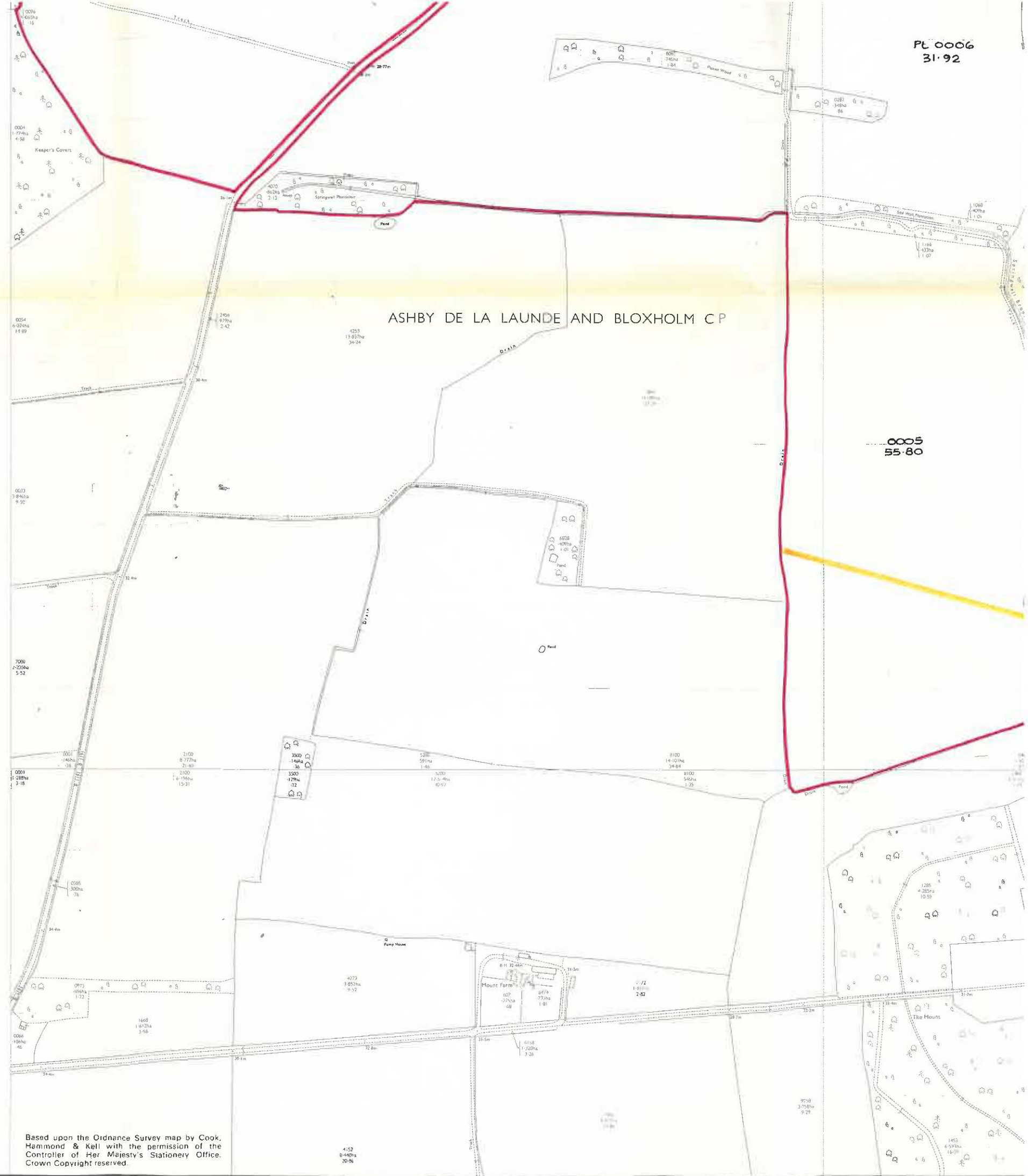

HOME FARM, ASHBY DE LA LAUNDE

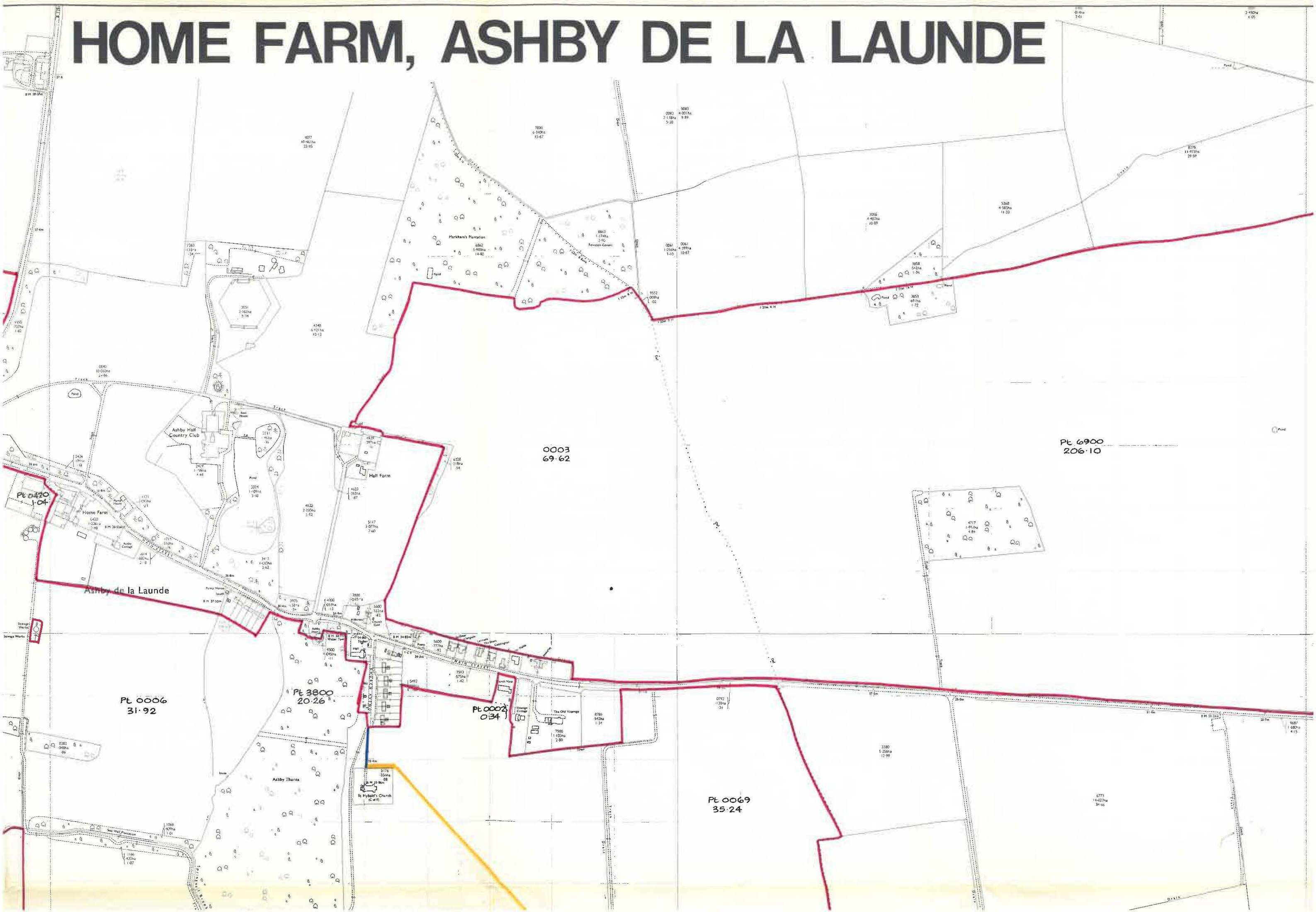

Pt 0006
31-92

Pt 3800
20-26

Pt 0002
0-34

Pt 0069
35-24

0005
55-80

Pt 0002
155-56

8300
2-38

Bloxholm
5170
3-01ha
7-46

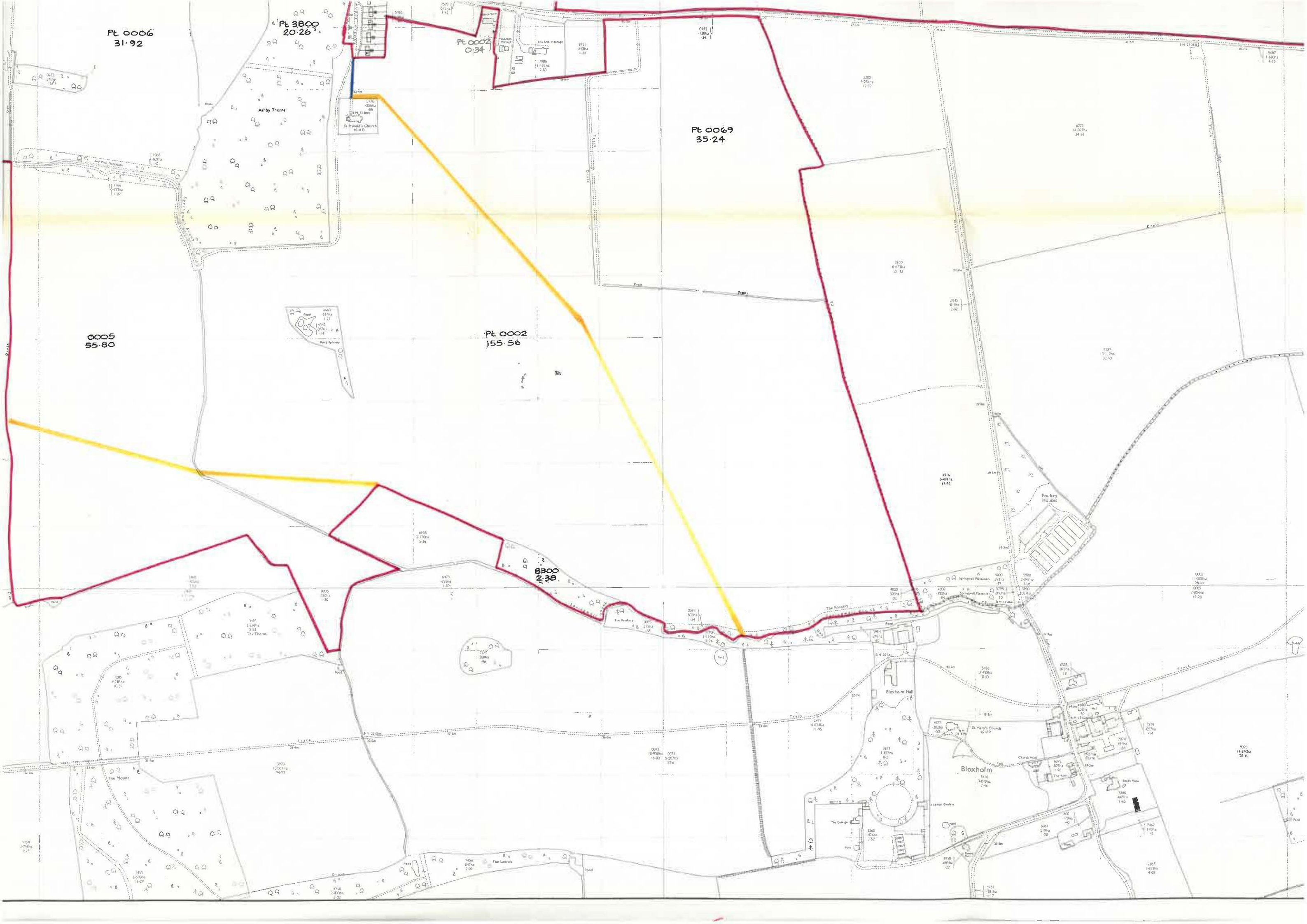

DE LA LAUNDE

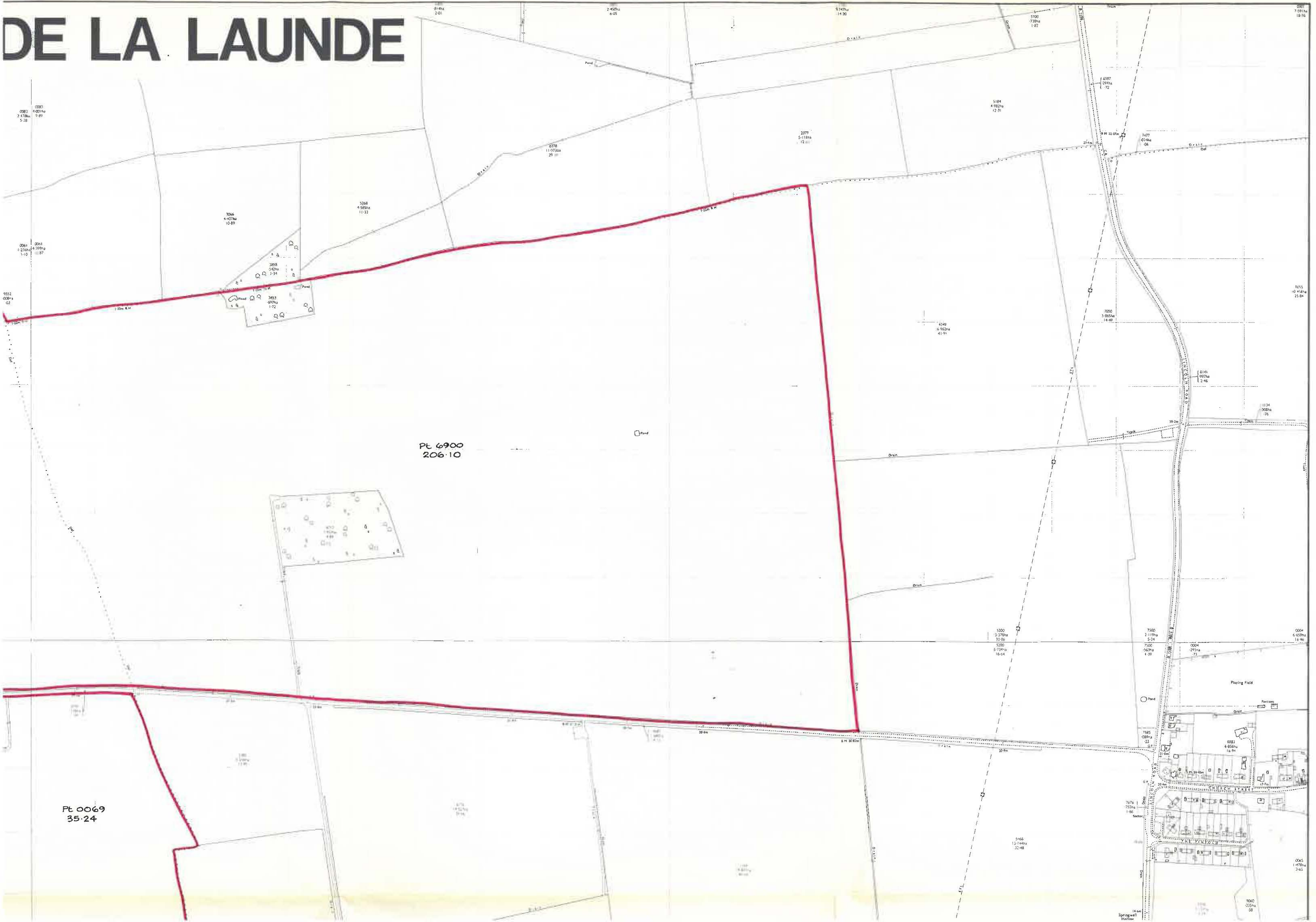

PL 0069
35-24

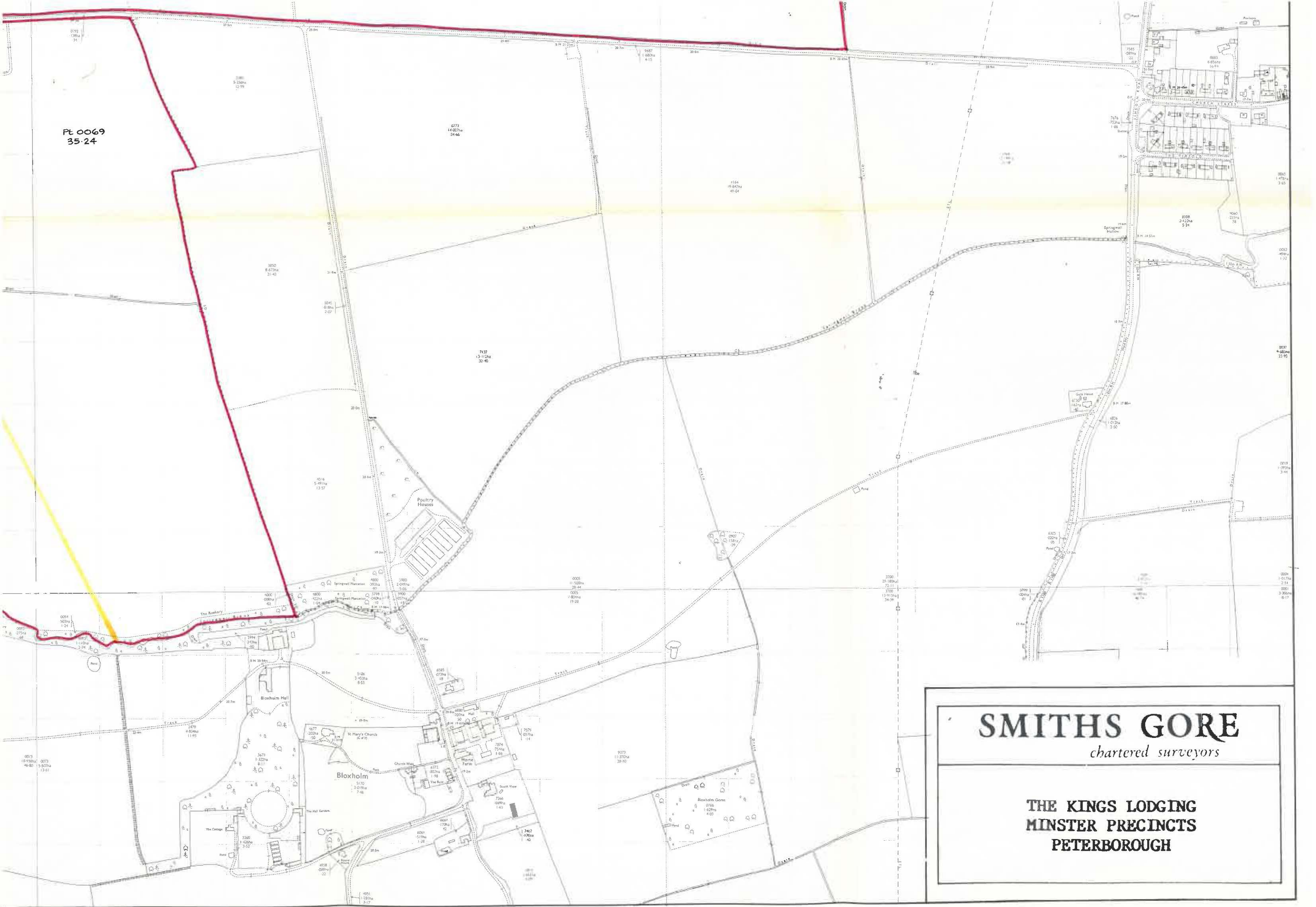

SMITHS GORE
chartered surveyors

**THE KINGS LODGING
MINSTER PRECINCTS
PETERBOROUGH**

STATUTORY DECLARATION

SECTION 31 (6) OF THE HIGHWAYS ACT 1980

I, BENNETT ALAN FELIX SWAYNE, A PARTNER IN THE FIRM OF SMITHS GORE, AGENTS FOR MIDLAND BANK PENSION TRUST LIMITED (THE OWNERS) DO SOLEMNLY AND SINCERELY DECLARE as follows:

- 1. I am and have been since 28th July 1981, the date of purchase of the property, the Agent for the Owners of the land known as Home Farm, Ashby de la Launde, Lincoln, more particularly delineated on the plan accompanying this Declaration and thereon edged red.

- 2. On the 29th day of December 1993 I deposited with Lincolnshire County Council, being the appropriate Council, a Statement accompanied by a plan delineating the property by red edging which stated that the way coloured blue on the said plan and on the plan accompanying this Declaration had been dedicated as a Highway with vehicular status and that the ways coloured yellow on the said plan and on the plan accompanying this Declaration had been dedicated as footpaths.

- 3. No additional ways have been dedicated over the land edged red on the plan accompanying this Declaration since the Statement dated 29th December 1993 referred to in 2 above.

AND I MAKE this solemn Declaration on 4th day of May 1995 conscientiously believing it to be true and by virtue of the Statutory Declarations Act 1835.

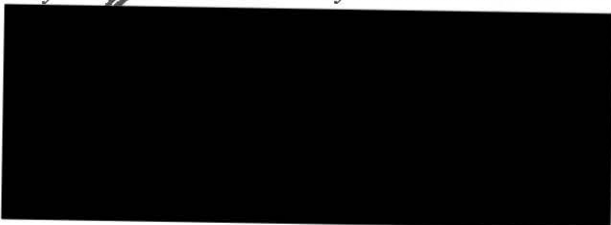
Declared at 

*111 Mustert Precincts
Peterborough
Cambridgeshire*

Before me
(Commissioner for Oaths or a
Justice of the Peace or Solicitor)

*Solicitor
A. J. E CHRISTMAS*

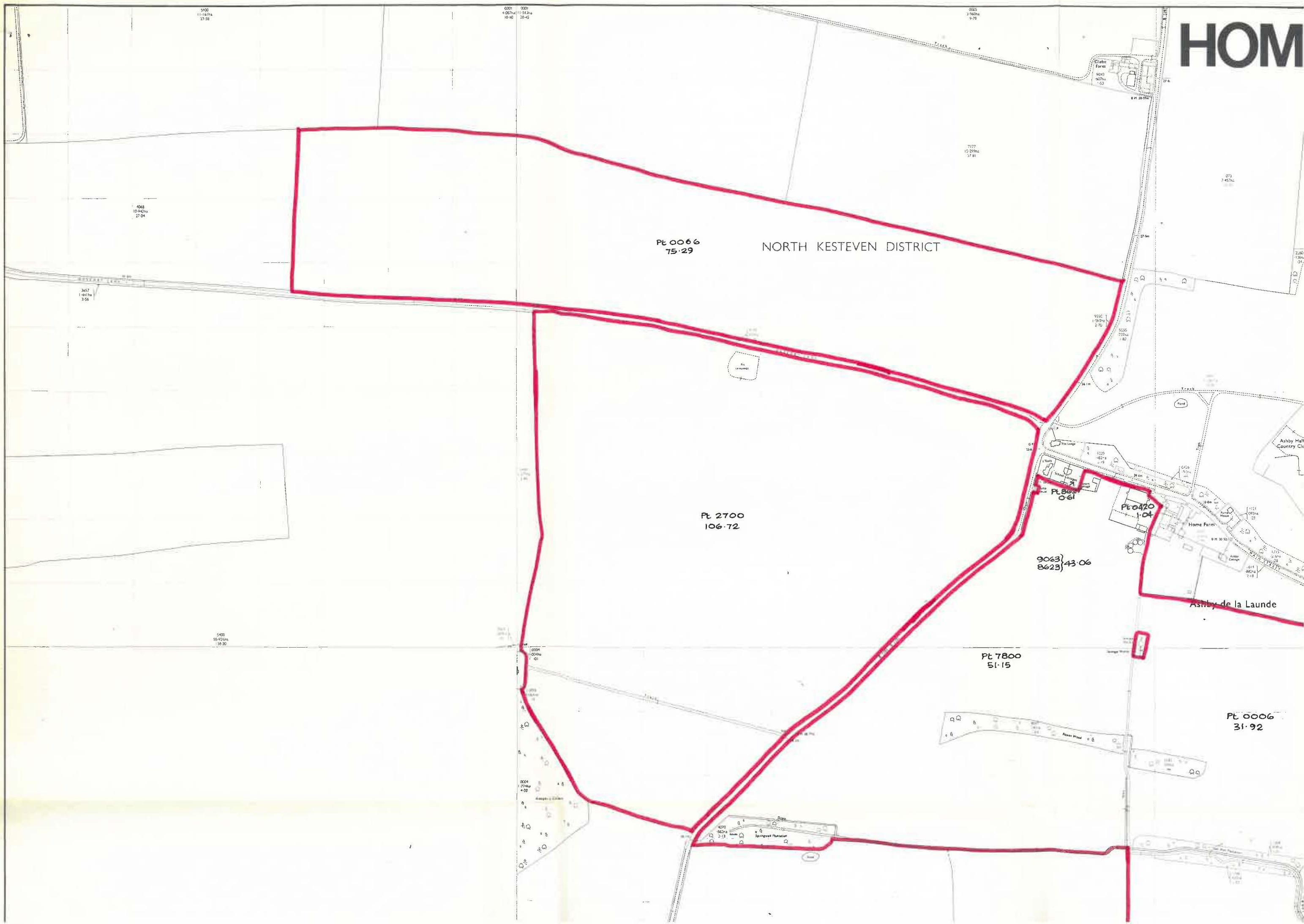

ASHBY DE LA LAUNDE AND BLOXHOLM C P

0005
55.80

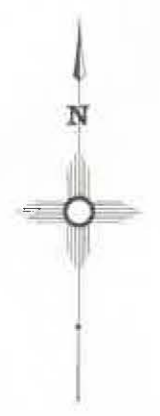

SCALE 1:5,000

Based upon the Ordnance Survey map by Cook, Hammond & Kell with the permission of the Controller of Her Majesty's Stationery Office. Crown Copyright reserved.

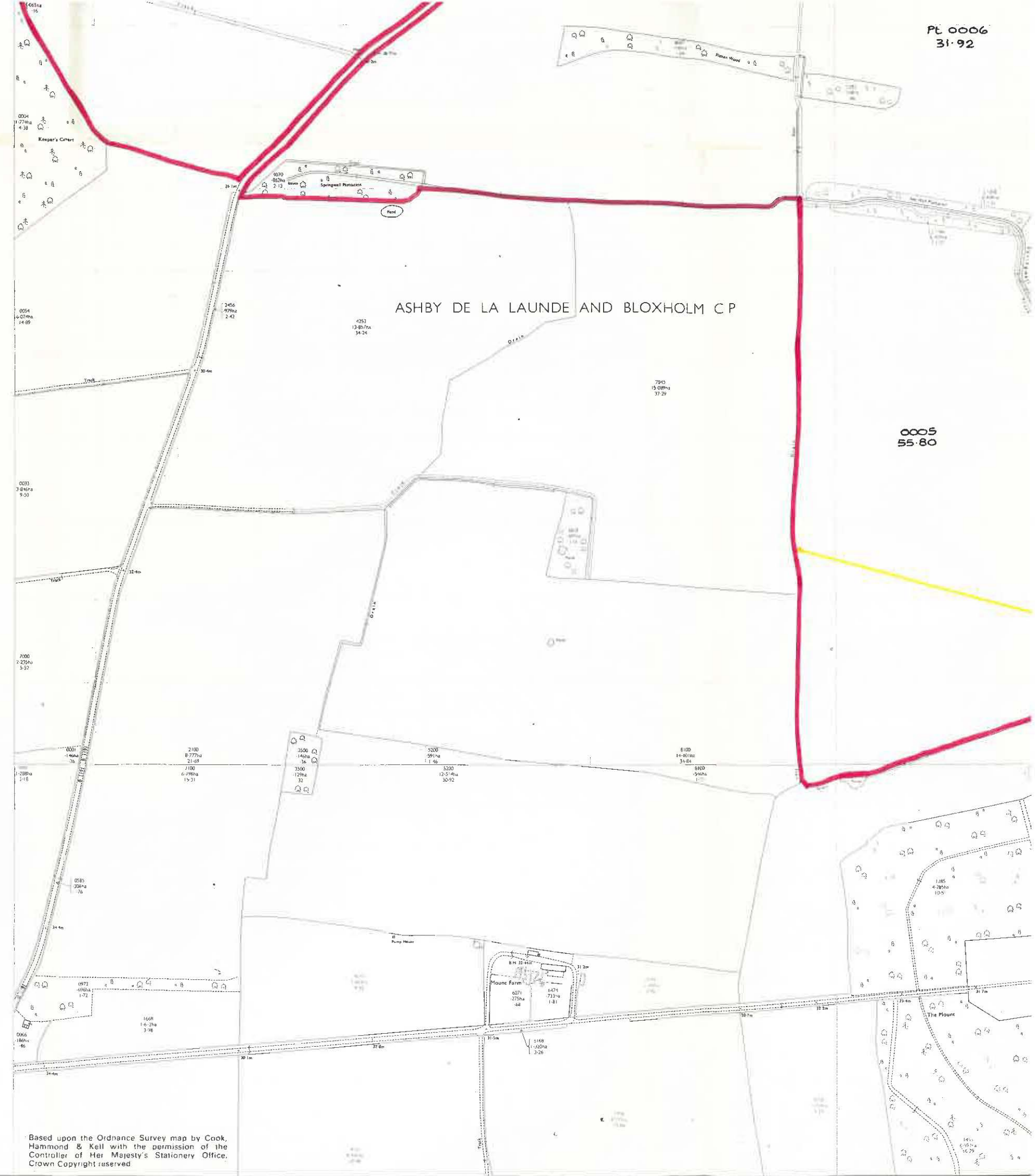

HOME FARM, ASHBY DE LA LAUNDE

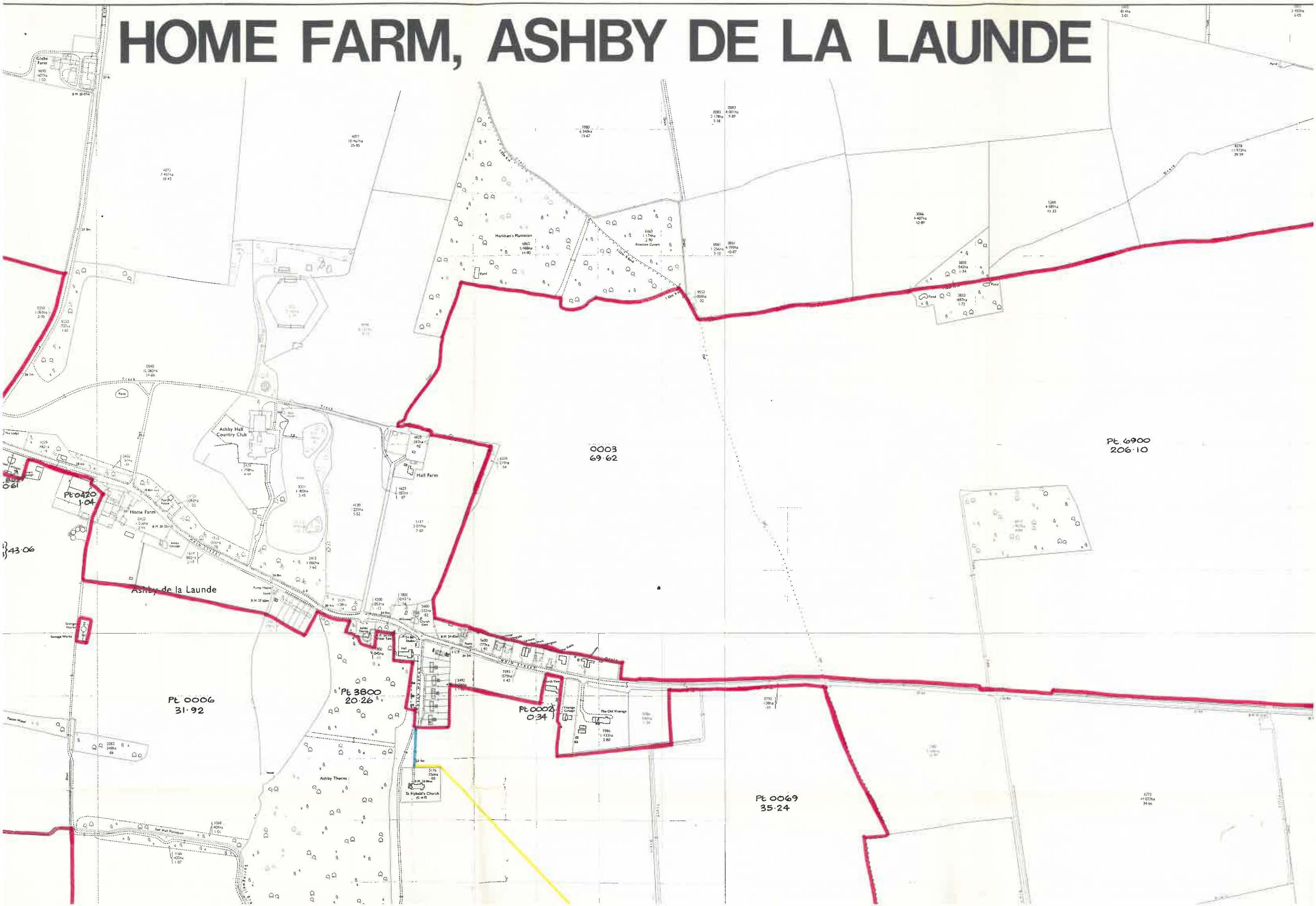

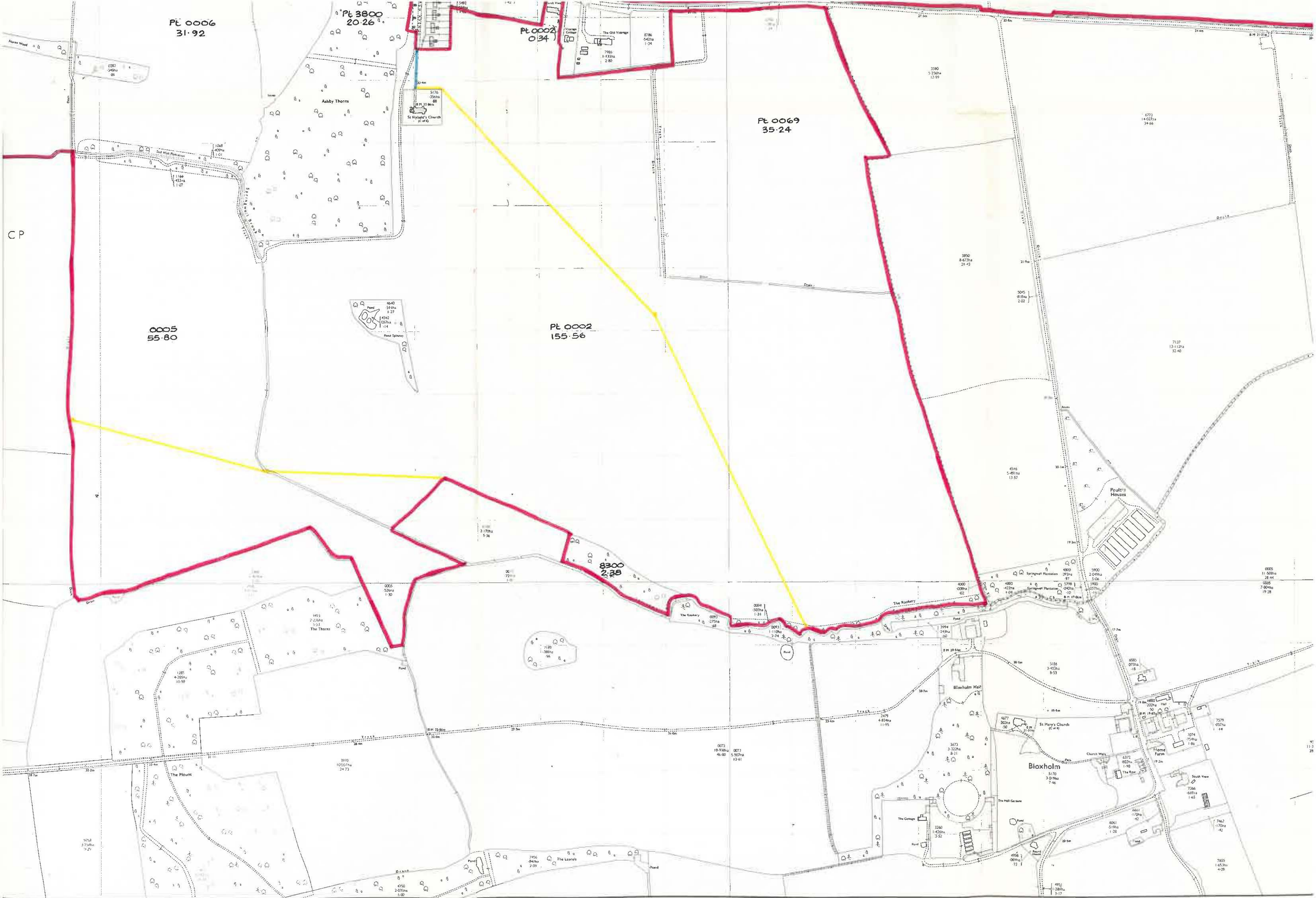

Pt 0006
31.92

Pt 3800
20.26

Pt 0002
0.34

Pt 0069
35.24

Pt 0002
155.56

0005
55.80

Aaby Thorns

St Mary's Church
(C of E)

8300
2.28

Bloxholm

Poul's Houses

The Mount

The Laurels

Bloxholm Hall

St Mary's Church
(C of E)

Home Farm

South View

CP

DE LA LAUNDE

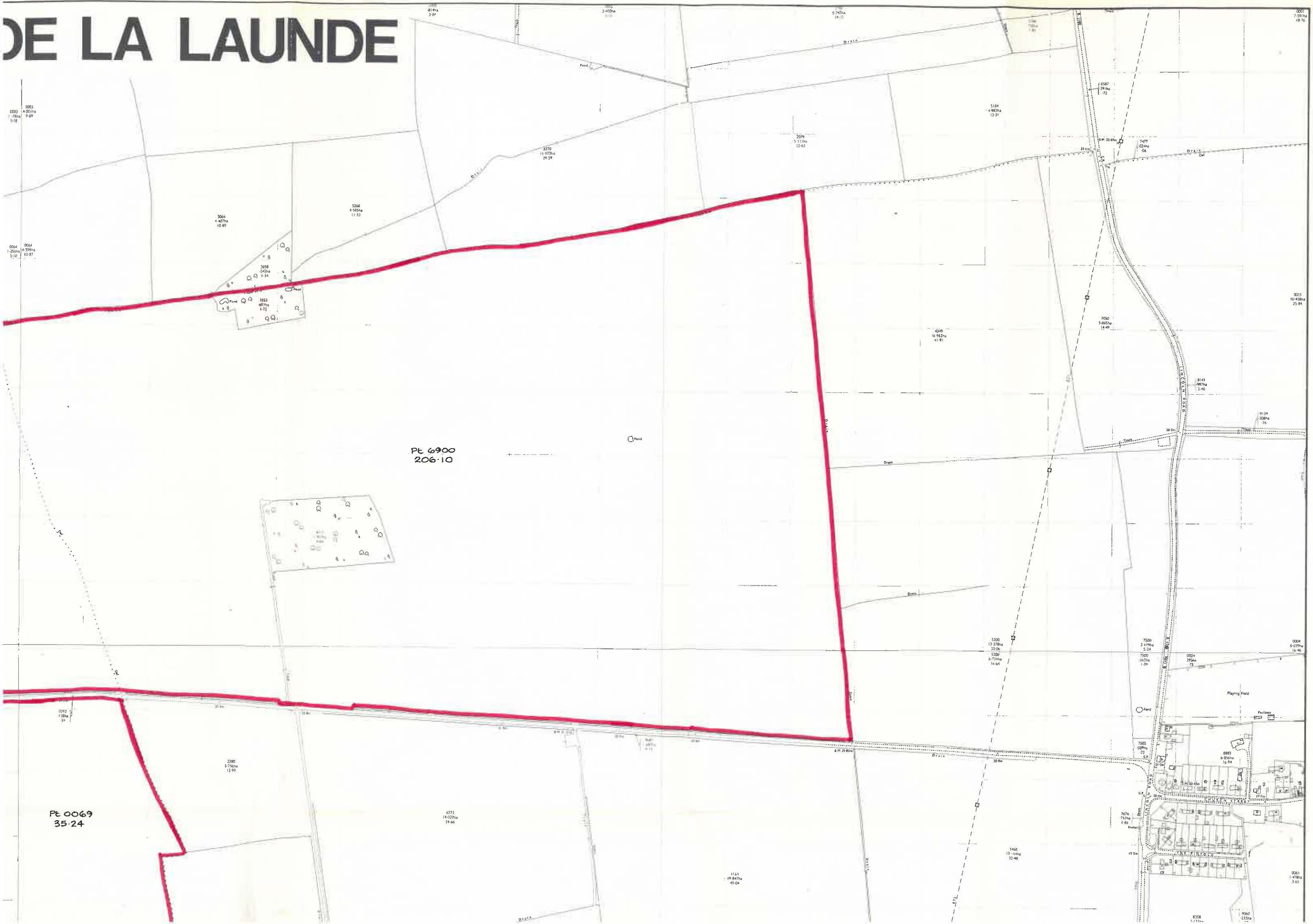

PE 6900
206.10

PE 0069
35.24

0089
1.001ha
7.08
5.38

0084
1.256ha
3.10
10.87

3064
4.407ha
10.87

3268
4.509ha
11.32

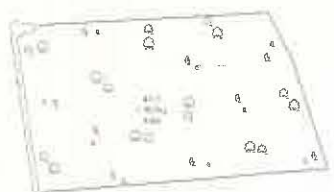

0972
1.38ha
34

3380
5.756ha
12.99

6771
14.027ha
14.46

3155
19.847ha
49.04

5300
13.378ha
31.06

5300
6.724ha
16.64

7500
2.119ha
5.24

7500
3.633ha
1.39

0004
2.95ha
73

7505
0.87ha
22

7674
7.53ha
1.88

5460
13.744ha
32.48

8258
1.133ha

9060
2.23ha

0001
7.391ha
18.76

0055
10.458ha
25.94

0004
6.559ha
16.46

0060
1.478ha
3.65

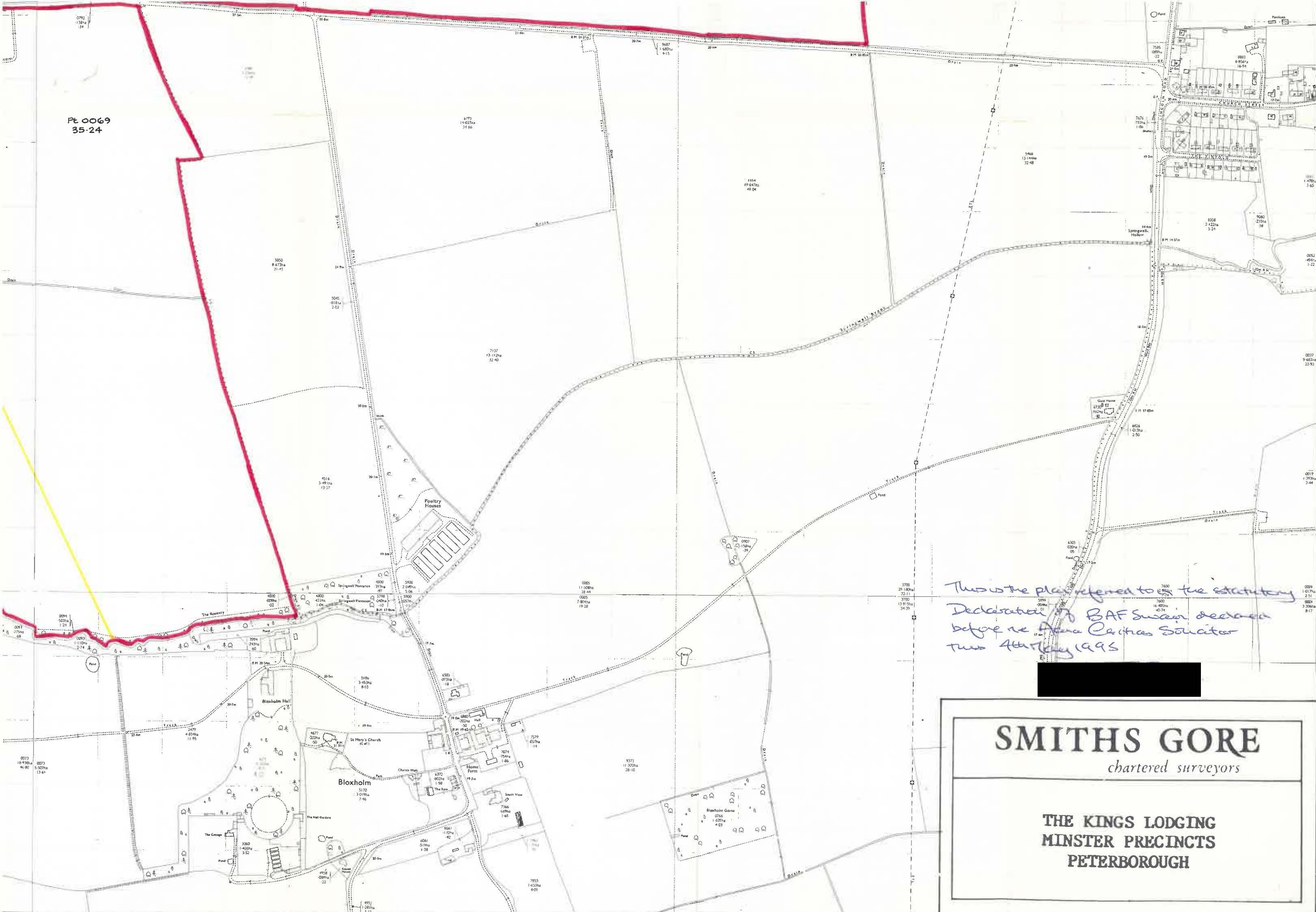

Pt 0069
35.24

*This is the plan referred to in the statutory
Declaration of BAF Success declared
before the Anna Cecilia Solicitor
this 4th day 1995*



SMITHS GORE
chartered surveyors

**THE KINGS LODGING
MINSTER PRECINCTS
PETERBOROUGH**

STATUTORY DECLARATION

SECTION 31 (6) OF THE HIGHWAYS ACT 1980

I, BENNETT ALAN FELIX SWAYNE, A PARTNER OF THE FIRM OF SMITHS GORE, AGENTS FOR HSBC BANK PENSION TRUST (UK) LIMITED (THE OWNERS), DO SOLEMNLY AND SINCERELY DECLARE as follows

- 1. I am and have been since 28 July 1981, the date of purchase of the property, the Agent for the Owners of the land known as Home Farm, Ashby de la Launde, Lincoln, more particularly delineated on the plan accompanying this Declaration and thereon edged red.
- 2. With effect from 27 September 1999 the name of the Owner of the property changed from Midland Bank Pension Trust Limited to HSBC Bank Pension Trust (UK) Limited.
- 3. On 29 December 1993 I deposited with Lincolnshire County Council, being the appropriate Council, a Statement accompanied by a plan delineating the property by red edging which stated that the way coloured blue on the said plan and on the plan accompanying this Declaration had been dedicated as a highway with vehicular status and that the ways coloured yellow on the said plan and on the plan accompanying this Declaration had been dedicated as footpaths.
- 4. No additional ways have been dedicated over the land edged red on the plan accompanying this Declaration since the Statement dated 29 December 1993 referred to in 3 above.

AND I MAKE this solemn Declaration on 28th day of March 2001 conscientiously believing it to be true and by virtue of the Statutory Declarations Act 1835.

Declared at



Smiths Gore, The King's Lodging, Minster Precincts
Peterborough PE1 1XT

Before me
(Commissioners for Oaths or a
Justice of the Peace or Solicitor)



Solicitor.

1 Minster Precincts,
Peterborough

HOM

Pt 0066
75.29

NORTH KESTEVEN DISTRICT

Pt 2700
106.72

9063 }
8623 } 43.06

Pt 7800
51.15

Pt 0006
31.92

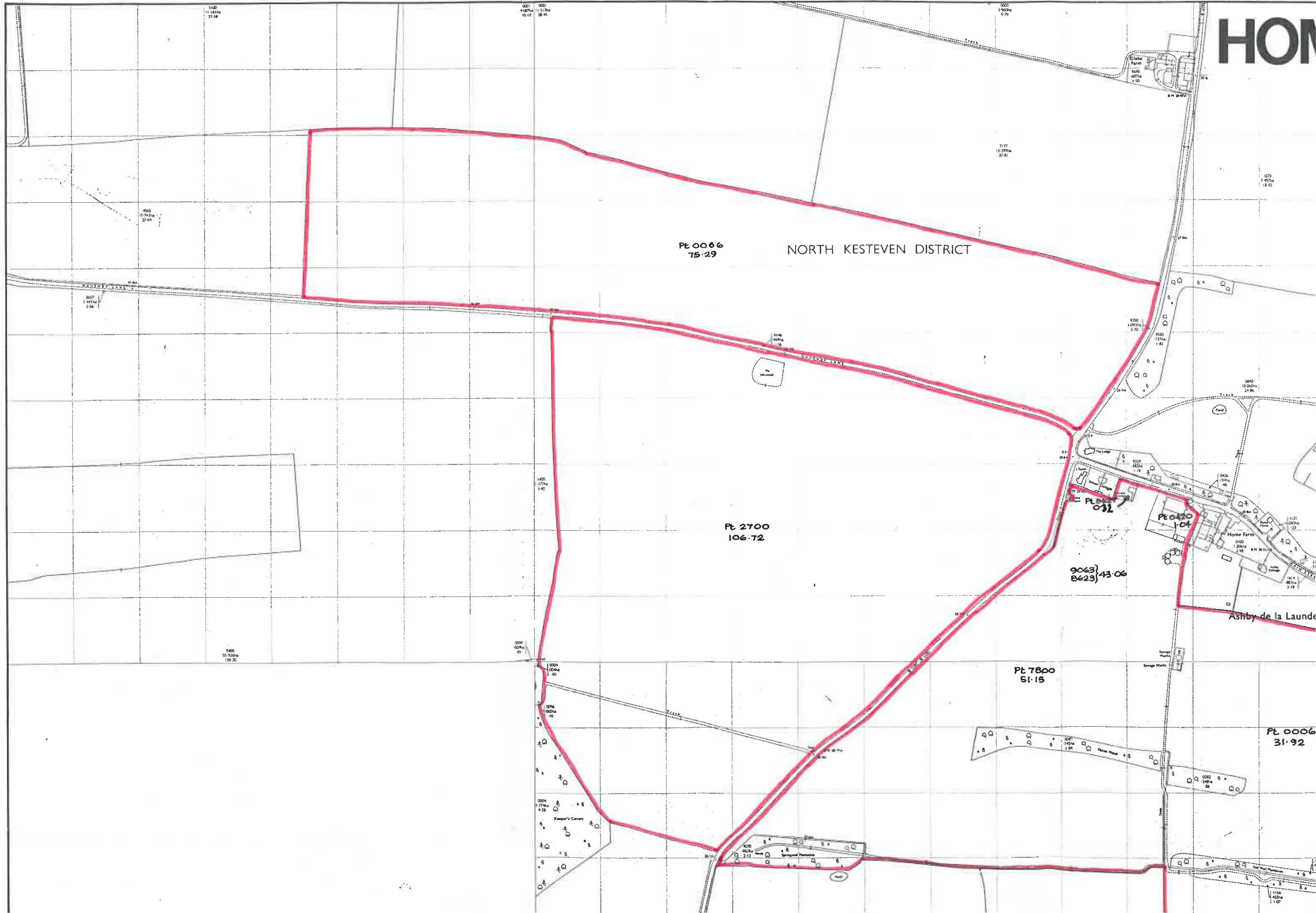

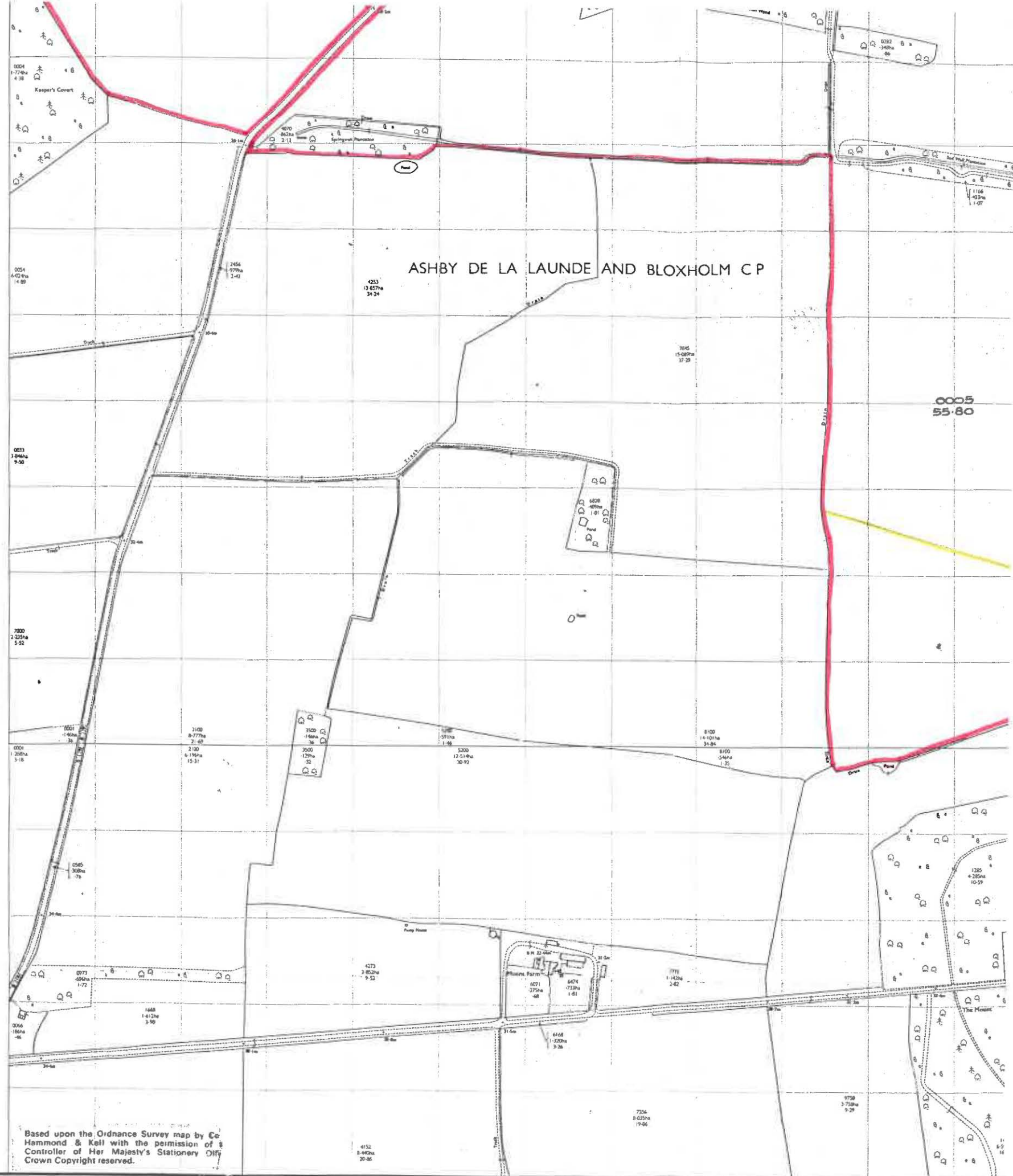

ASHBY DE LA LAUNDE AND BLOXHOLM C P



SCALE 1:5,000

Based upon the Ordnance Survey map by Co
Hammond & Kell with the permission of
Controller of Her Majesty's Stationery Office
Crown Copyright reserved.

HOME FARM, ASHBY DE LA LAUNDE

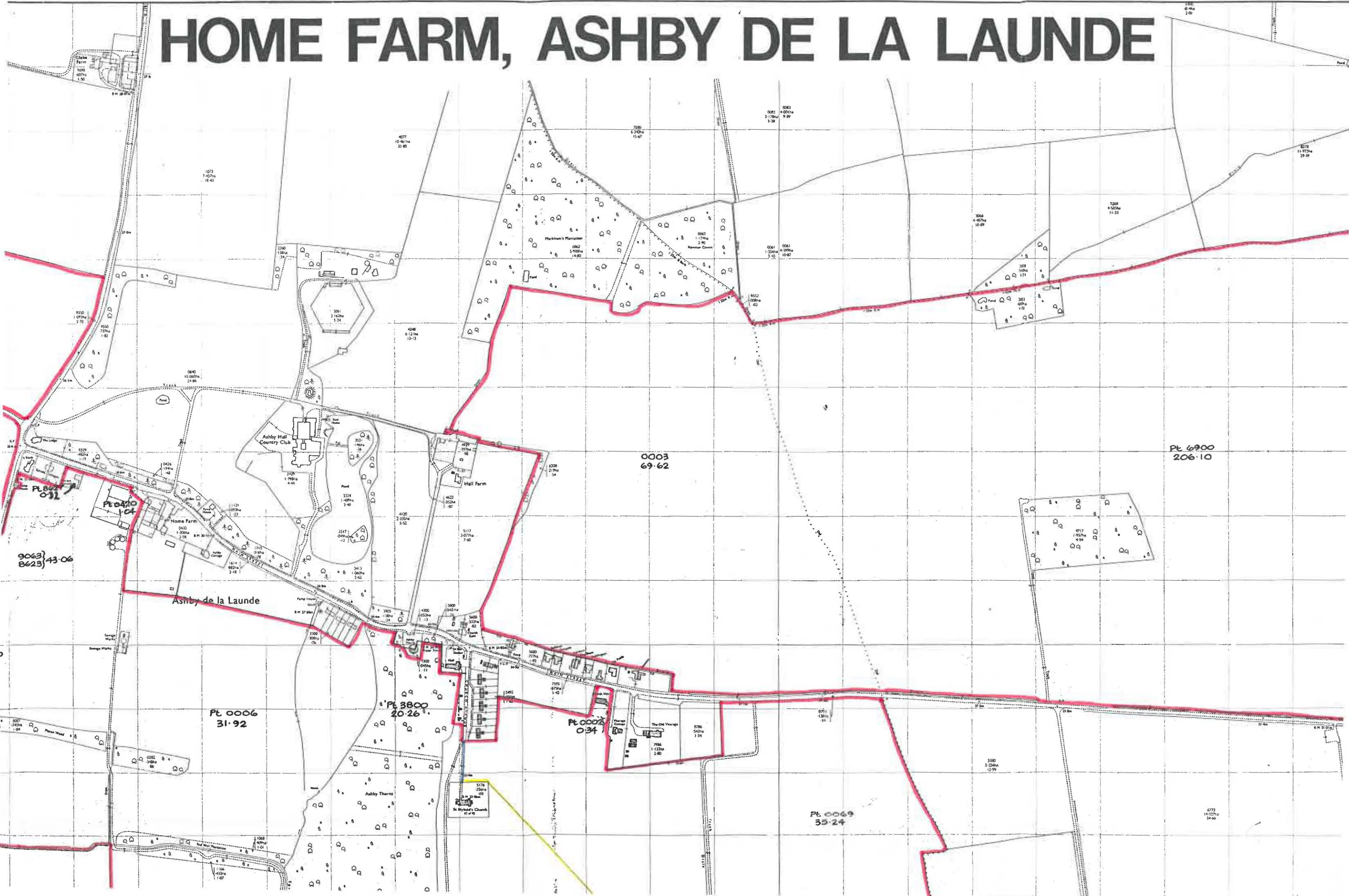

OXHOLM CP

0005
55.80

Pt 0002
155.56

Pt 0069
35.24

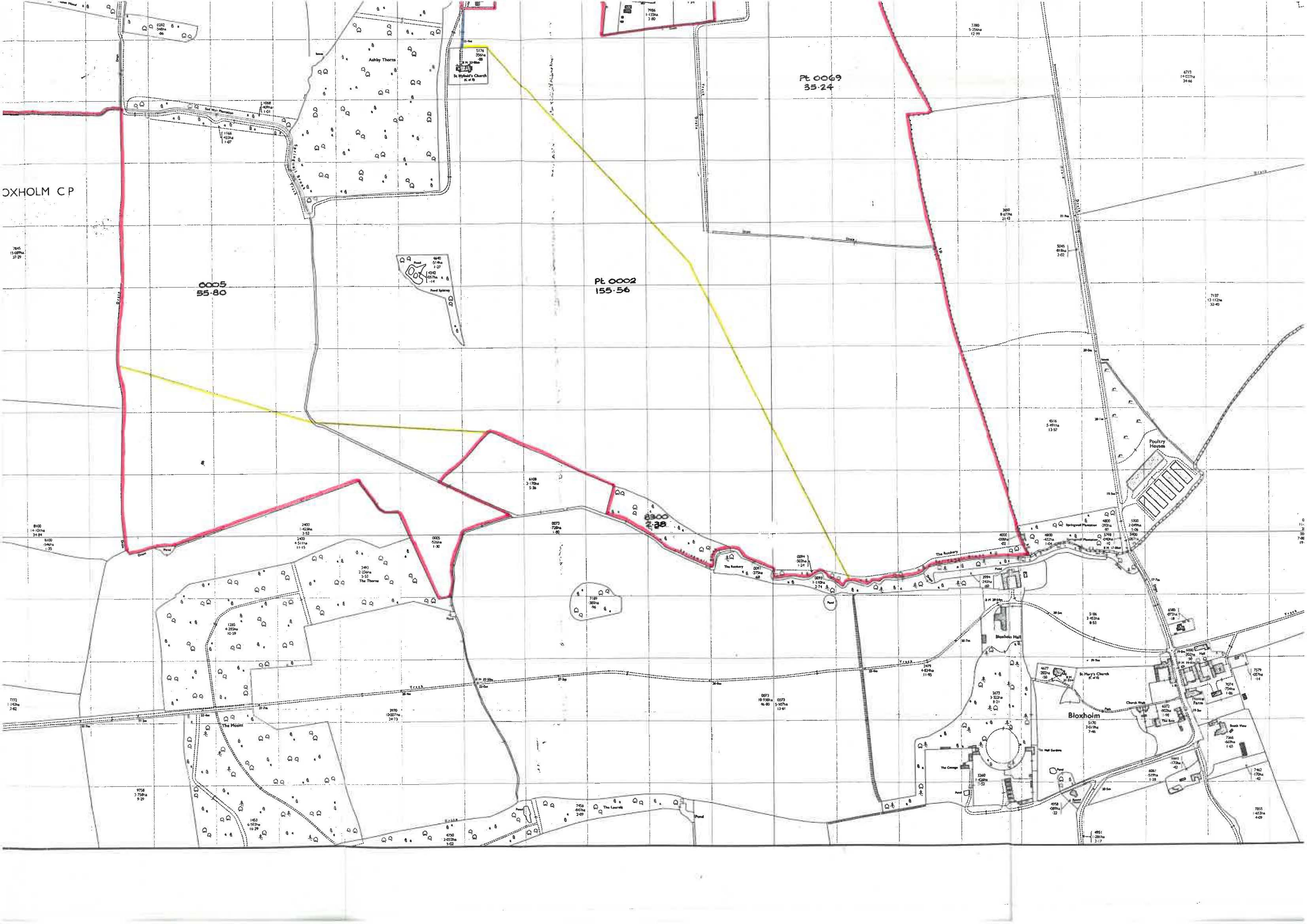

DE LA LAUNDE

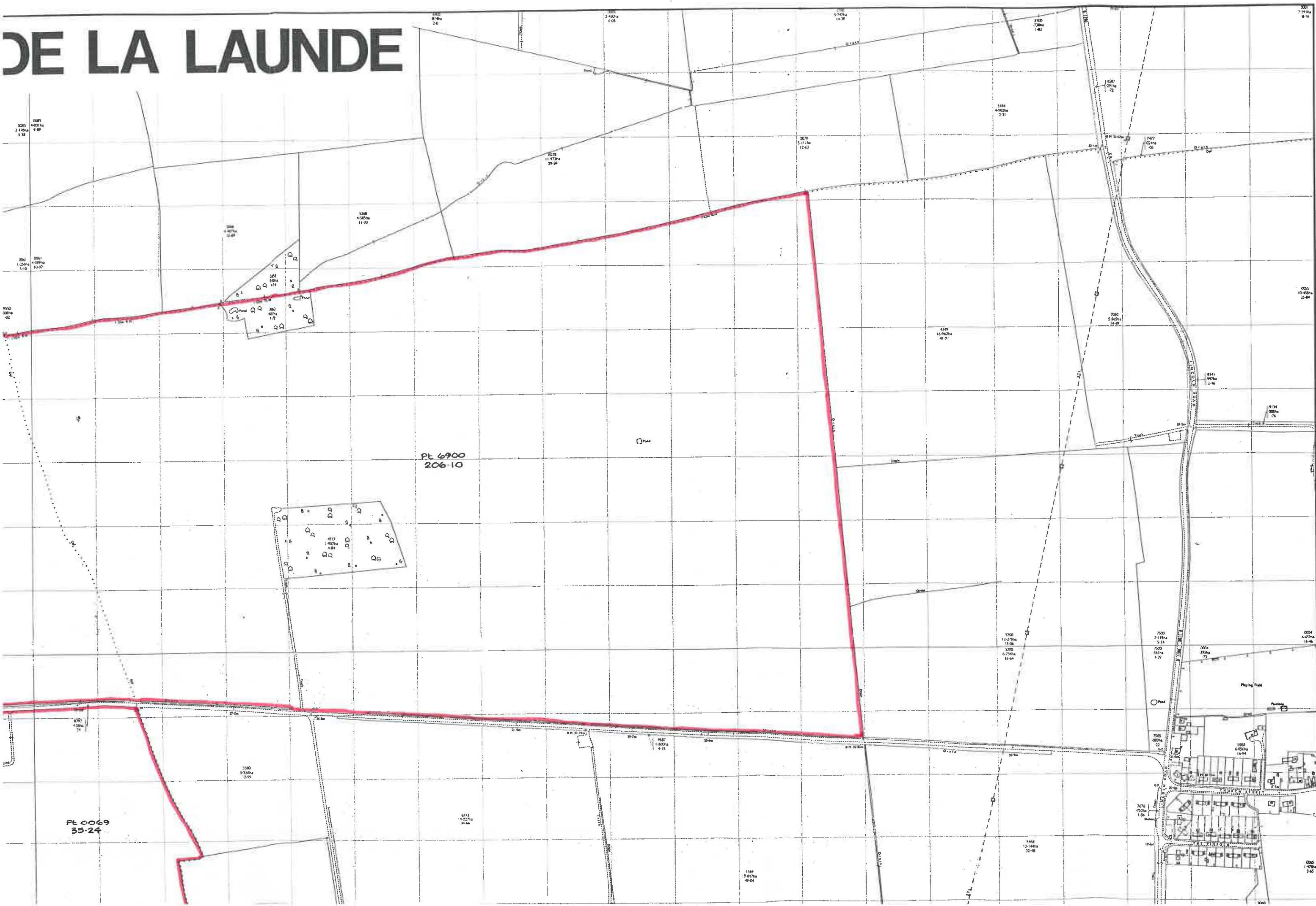

Pt 0069
35-24

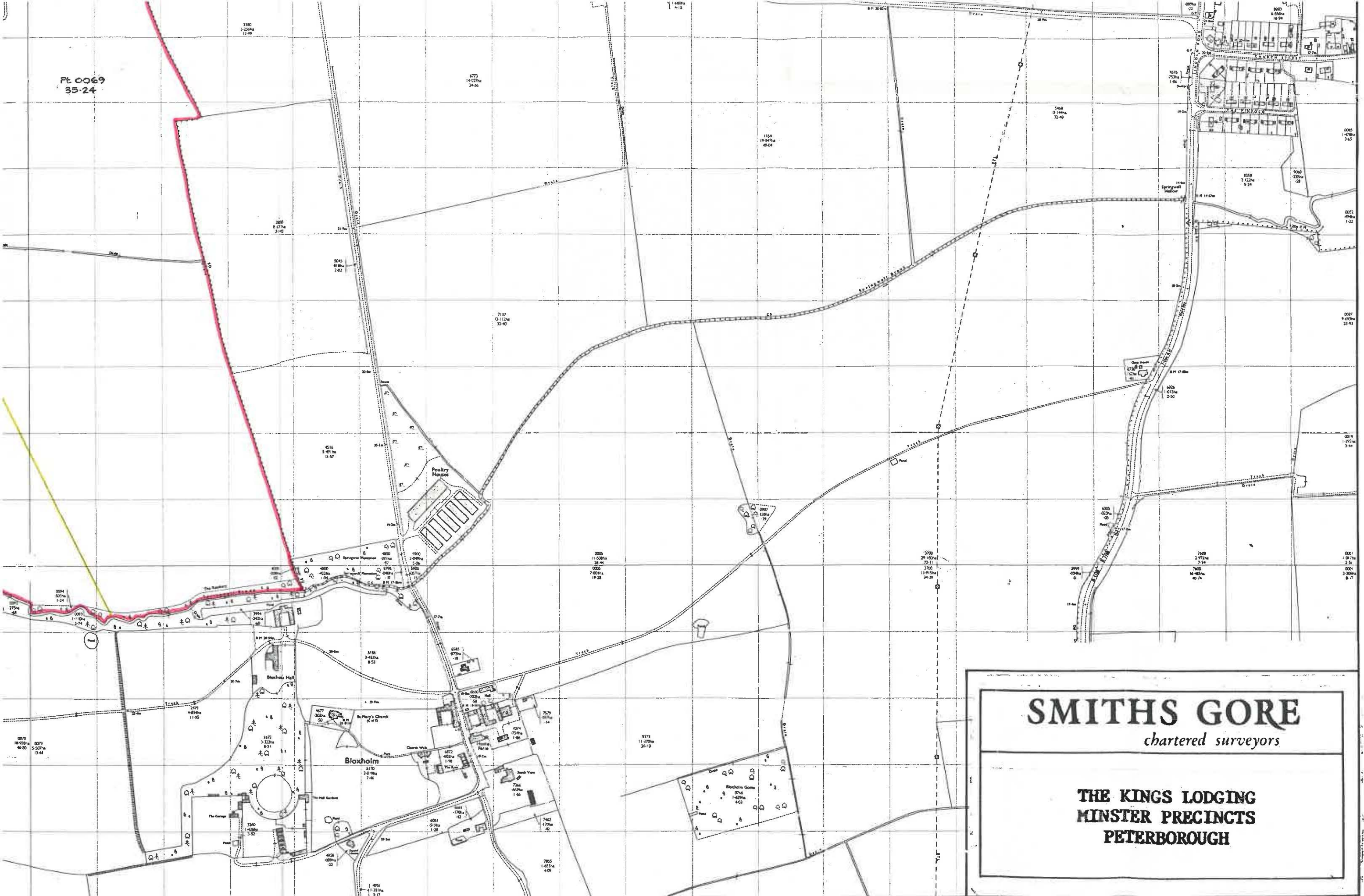

SMITHS GORE
chartered surveyors

**THE KINGS LODGING
MINSTER PRECINCTS
PETERBOROUGH**

*This is the plan referred to in the declaration
of B.A.F. Swayne sworn before me this
28th March 2001*

Solicitor

STATUTORY DECLARATION

SECTION 31 (6) OF THE HIGHWAYS ACT 1980

WE, ERIC MICHAEL WILKINSON AND
JENNIFER ANNE WILKINSON

OF HOME FARM, ASHBY-DE-LA-LAUNDE, LINCOLN LN4 3JG

DO SOLEMNLY AND SINCERELY DECLARE AS FOLLOWS:

1. On the 29th day of December 1993 our predecessor in title (HSBC Bank Pension Trust (UK) Ltd.) deposited with Lincolnshire County Council a map of our land known as Home Farm, Ashby de la Launde, Lincolnshire together with a statement indicating those highways then dedicated to the public (if any).
2. Since the map and statement were deposited;

No ways additional to those shown on such map and described in such statement (if any) for use of the public as highways have been dedicated by us or our predecessor in title.

AND WE MAKE this solemn Declaration on *19th* day of *January 2004* conscientiously believing the same to be true and by virtue of the Statutory Declarations Act of 1835.

.....
[Redacted Signature]
.....
[Redacted Signature]
.....

Declared at
27/31 Northgate
Steepleford
Lincoln. NG34 7RW

Before me [Redacted]
(Commissioner for Oaths or a
Justice of the Peace or Solicitor)

9. An application must be accompanied by the requisite fee – please ask the appropriate authority for details.

10. 'Appropriate authority' means (a) in relation to a map or statement deposited or declaration lodged under section 31(6) of that Act, an appropriate council (as defined in section 31(7) of the Highways Act 1980); and (b) in relation to a statement and map deposited under section 15A(1) of the 2006 Act, a commons registration authority (defined in section 4 of the Commons Act 2006 and section 2 of the Commons Registration Act 1965). In practice, the appropriate council and commons registration authority will usually be the same body.

PART A: Information relating to the applicant and land to which the application relates

(all applicants must complete this Part)

1. Name of appropriate authority to which the application is addressed:

Lincolnshire County Council

2. Name and full address (including postcode) of applicant(s):

Eric Michael Wilkinson and Jennifer Anne Wilkinson
Home Farm
Ashby de la Launde
Lincoln
LN4 3JG

3. Status of applicant(s) (tick relevant box or boxes):

We are

(a) the owner(s) of the land(s) described in paragraph 4.

(b) making this application and the statements/declarations it contains on behalf of [insert name of owner] who is the owner of the land(s) described in paragraph 4 and in my capacity as [insert details].

4. Insert description of the land(s) to which the application relates (including full address and postcode):

Land known as Home Farm in the Parishes of Ashby de la Launde and Digby, Lincolnshire, LN4

5. Ordnance Survey six-figure grid reference(s) of a point within the area of land(s) to which the application relates (if known):

Not known

6. This deposit comprises the following statement(s) and/or declarations (*delete Parts B, C, or D where not applicable*):

Parts C and D (Part B deleted)

PART C: Declaration under section 31(6) of the Highways Act 1980

1. We are the owners of the land described in paragraph 4 of Part A of this form and shown

on the map lodged with Lincolnshire County Council on the 4th day of January 1993.

2. On the 4th day of January 1993 our predecessor in title Midland Bank Pension Trust Ltd deposited with Lincolnshire County Council, being the appropriate Council, a statement accompanied by a map showing our property which indicated any highways then dedicated to the public (if any).

3. On the 10th day of May 1995 our predecessor in title Midland Bank Pension Trust Ltd deposited with Lincolnshire County Council, being the appropriate Council, a declaration stating that no additional ways had been dedicated as highways since the deposit of the statement and map referred to in 2 above.

4. On the 6th day of April 2001 our predecessor in title HSBC Bank Pension Trust deposited with Lincolnshire County Council, being the appropriate Council, a declaration stating that no additional ways had been dedicated as highways since the deposit of the statutory declaration referred to in 3 above.

5. On the 19th day of January 2004 we deposited with Lincolnshire County Council, being the appropriate Council, a declaration stating that no additional ways had been dedicated as highways since the deposit of the statutory declaration referred to in 4 above.

6. No additional ways have been dedicated over the land on the map referenced in paragraph 1 above since the date of the declaration referred to in paragraph 5 above and at the present time we have no intention of dedicating any more public rights of way over our property.

PART D: Statement under section 15A(1) of the Commons Act 2006

We are the owners of the land described in paragraph 4 of Part A of this form and shown on the map deposited with Lincolnshire County Council on 4th day of January 1993.

We wish to bring to an end any period during which persons may have indulged as of right in lawful sports and pastimes on the whole or any part of the land shown on the map referenced above.

PART E: Additional information relevant to the application
(insert any additional information relevant to the application)

At the time this application was prepared the Lincolnshire County Council deposit reference number for the land described in paragraph 4 of Part A of this form was CA/7/17.

**PART F: Statement of Truth
(all applicants must complete this Part)**

WARNING: If you dishonestly enter information or make a statement that you know is, or might be, untrue or misleading, and intend by doing so to make a gain for yourself or another person, or to cause loss or the risk of loss to another person, you may commit the offence of fraud under section 1 of the Fraud Act 2006, the maximum penalty for which is 10 years' imprisonment or an unlimited fine, or both.

I BELIEVE THAT THE FACTS AND MATTERS CONTAINED IN THIS FORM ARE TRUE

Signature (of the person making the statement of truth):



Print full name: Eric Michael Wilkinson

Date: *08/11/2013*

Signature (of the person making the statement of truth):



Print full name: Jennifer Anne Wilkinson

Date: *8th November 2013.*

You should keep a copy of the completed form