

Deposit of Statement and Map

Section 31(6) of the highways act 1980

(as amended by the Countryside and Rights of Way Act 2000)

- 1) We have been since 2004 the owners/trustees within the meaning of the above section of the land known as Revesby Estate more particularly delineated on the map accompanying this statement and thereon edged red.
- 2) The aforementioned land lies in the Parishes of Revesby, Mareham Le Fen, Wood Enderby, Wilksby, Moorby and East Kirkby.
- 3) The ways coloured brown on the said map have been dedicated as highways with vehicular status.
- 4) The ways coloured purple on the said map have been dedicated as footpaths
- 5) No (other) ways over the land have been dedicated as highways
- 6) Page two contains a description of all highways/rights of way which correlates with the map.
- 7) The deposit shall comprise this statement and accompanying map.

Please note the Revesby Estate has two landowners/ Trustees.

Signed (landowner/ Trustee).....

[Redacted Signature]

Name (of landowner/ Trustee) : **T. E. J. Jones**

Address (of landowner/ Trustee): **Carter Jonas, 6-8 Hills Road, Cambridge, CB2 1NH.**

WITNESS LAURA LIM

[Redacted Witness Signature]

Solicitor

Signed (landowner/ Trustee).....

[Redacted Signature]

Name (of landowner/ Trustee) : **G.C. Smith**

Address (of landowner/ Trustee) : **Roythornes ,The malting, High Street, Burwell, Cambs, CB25 OHB**

WITNESS LAURA LIM

[Redacted Witness Signature]

Solicitor

Date.....

25/11/2009.

Deposit of Statement and Map

Section 31(6) of the highways act 1980

(as amended by the Countryside and Rights of Way Act 2000)

Description of highways/rights of way

Public Footpaths Purple.

No 181: From Revesby Corner, Mareham Le Fen to the A155 South of Shirewood, Revesby.

No 185: From West lane to Revesby Bridge.

No 186: From West Lane to Revesby village Alms houses.

No 196: From Wood Enderby to back lane Moorby Village.

No197: From East Kirkby Village to south west corner of field in which middle fen farm, Revesby is situated.

No200: From Park Lane Miningsby to Sall Holt Miningsby.

No214: From Manor Farm Miningsby to Miningsby Beck opposite the Grange.

Highways With vehicle status Brown

West lane from A155 Revesby to Moor houses.

Holt Lane, from A155 Mareham, le Fen to Low grounds Bridge.

Could you please acknowledge receipt of this either through a phone call or a email.

Phone number : 01507 568 395

Email : office@revesbyestate.co.uk



Revesby Estate

Scale: 1:10,039 @ A0

Drawn By: RAH

**CARTER
JONAS**

T: 01939 210171
South Pavilion, Sansaw Business Park, Hadnall, Shrewsbury SY4 4AS
E: shrewsbury@carterjonas.co.uk
carterjonas.co.uk

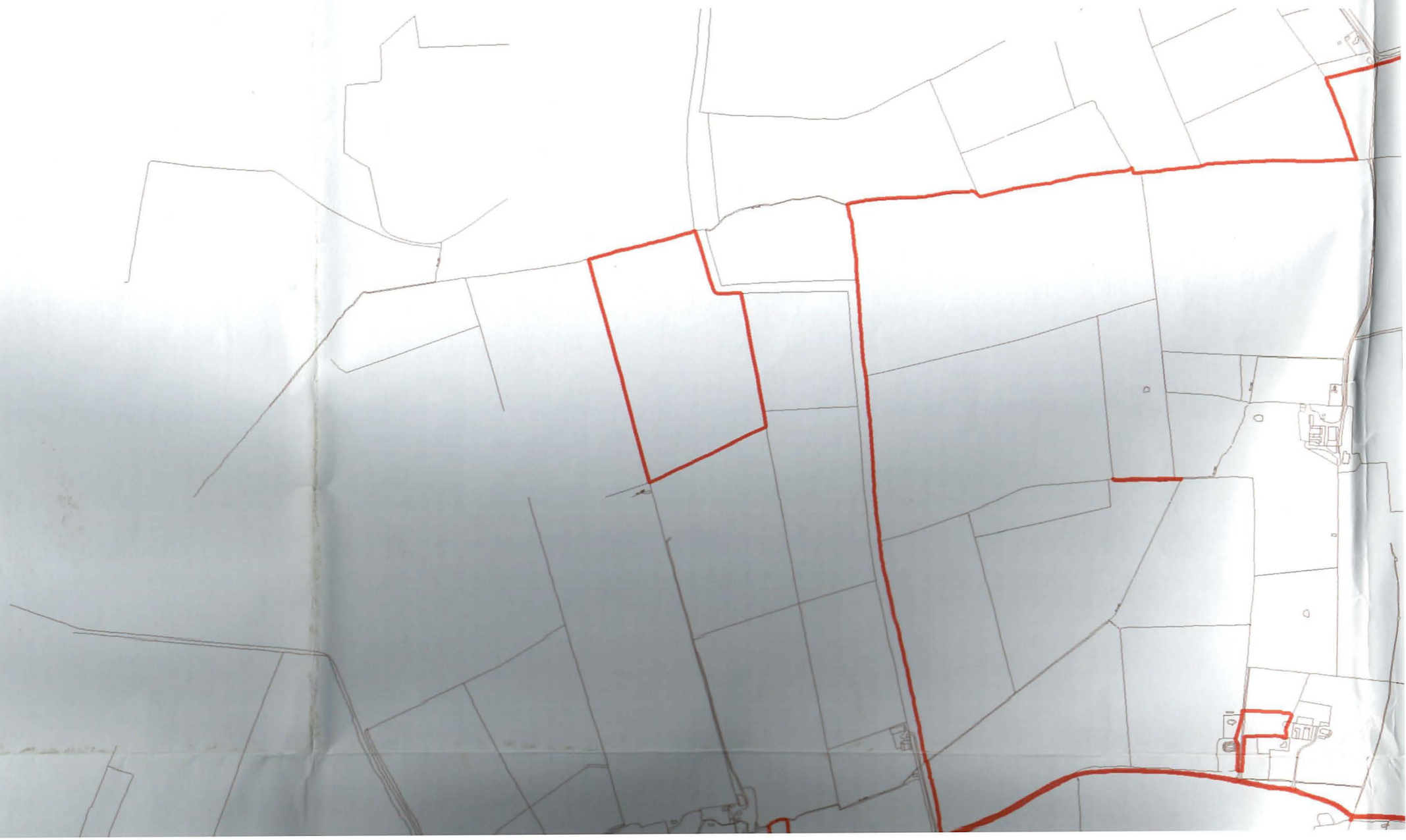



196



181

186

185

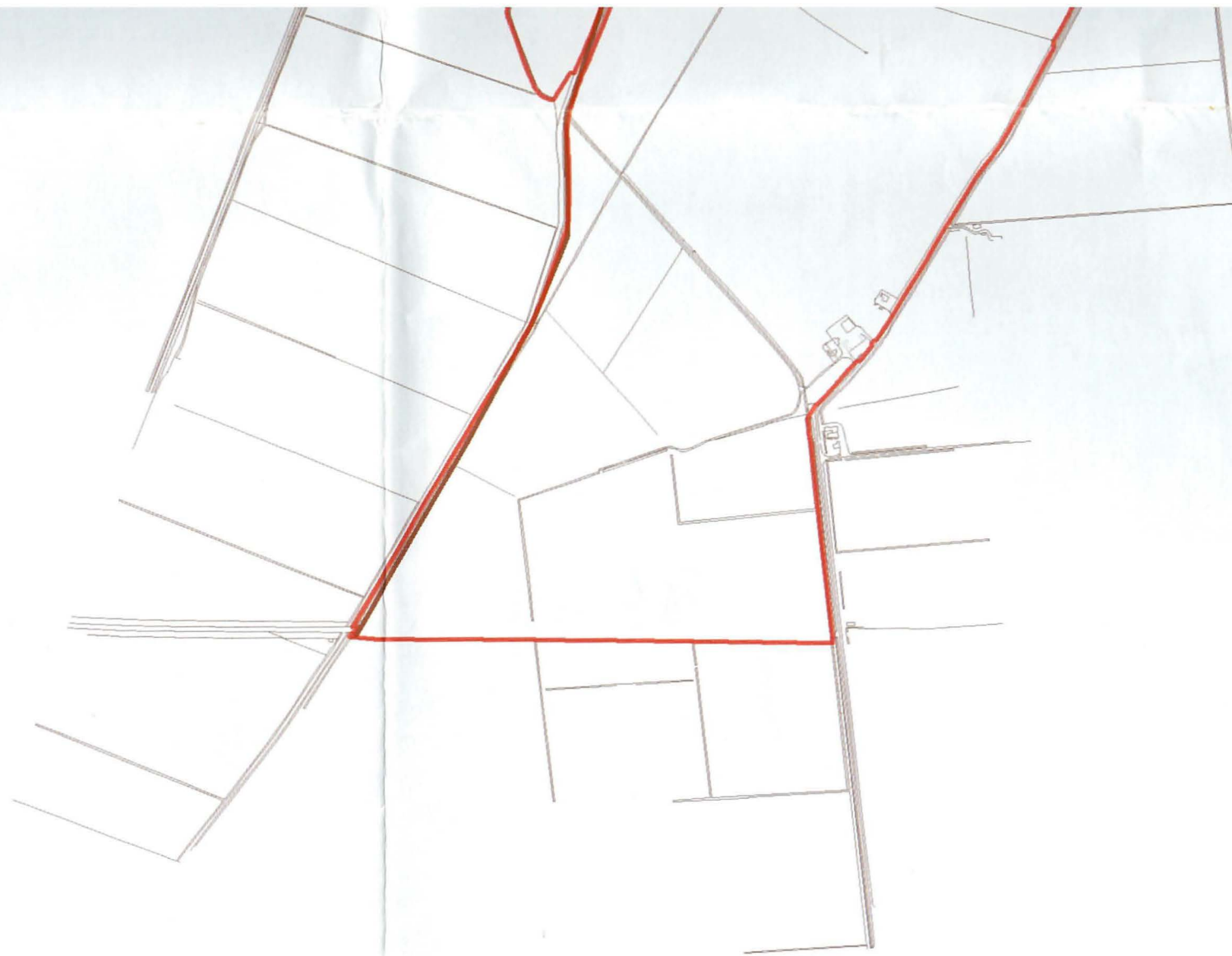



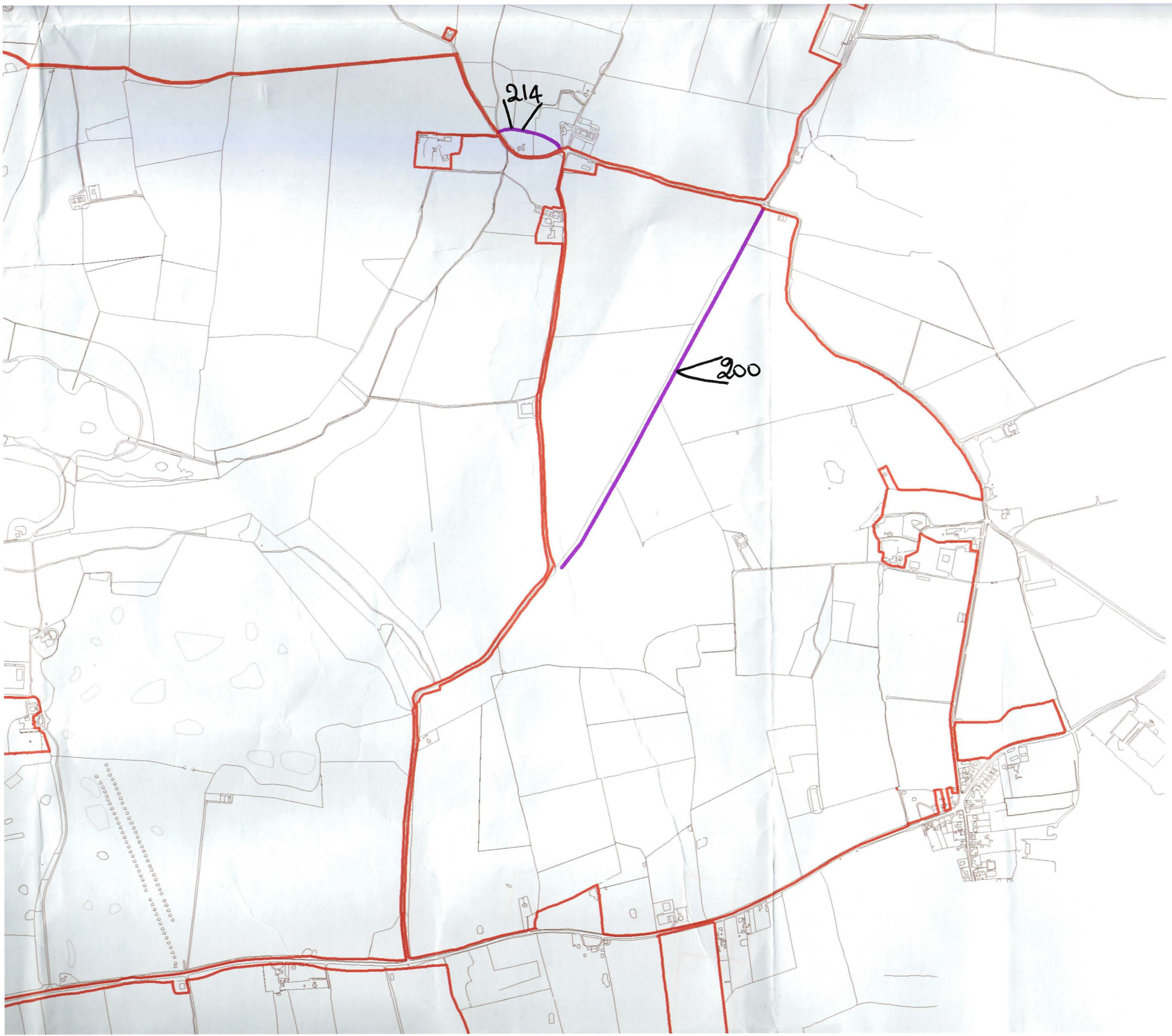

257.11.09

Legend

— CMR

— Foot Path

Statutory Declaration

Section 31 (6) of the highways Act 1980

(as amended by the Countryside and rights of Way act 2000)

- 1)We are and have been 2004 the owners/trustees of the land known as Revesby Estate more particularly delineated on the map accompanying this declaration and thereon edged red.
- 2) On the 25th day of November 2009 we deposited with Lincolnshire County Council, being the appropriate Council, a statement accompanied by a map delineating the property by red edging which stated that the ways coloured brown on the said map and on the map accompanying this declaration have been dedicated as highways with vehicular status. The ways coloured purple on the said map and map accompanying this declaration have been dedicated as footpaths. No other ways have been dedicated as highways over the property.
- 3)No additional ways have been dedicated over the land edged red on the map accompanying this declaration since the statement dated On the 25th day of November 2009 referred to in (2) above other than those highways with vehicular status) (footpaths) marked in the appropriate colour on the map accompanying this declaration. At the present time I have no intention of declaring any more public rights of way over my property.

AND WE MAKE this solemn declaration on the day of conscientiously believing it to be true and by virtue of the Statutory Declaration act 1835,

Please note the Revesby Estate has two landowners/ Trustees

Signed (landowner/ Trustee)... [Redacted Signature]

Name (of landowner/ Trustee) : **T. E. J. Jones**

Address (of landowner/ Trustee): **Carter Jonas, 6-8 Hills Road, Cambridge, CB2 1NH.**

WITNESS **LAURA LIM**

[Redacted Witness Signature]

SOLICITOR

Signed (landowner/ Trustee)... [Redacted Signature]

Name (of landowner/ Trustee) : **G.C. Smith**

Address (of landowner/ Trustee) : **Roythornes ,The malting, High Street, Burwell, Cambs, CB25 0HB**

WITNESS **LAURA LIM**

[Redacted Witness Signature]

SOLICITOR

Date: **25-11-09**

Please note we were under the impression that this process had been completed in March 2003, however no records were found at the Lincolnshire county council offices.

Deposit of Statement and Map

Section 31(6) of the highways act 1980

(as amended by the Countryside and Rights of Way Act 2000)

Description of highways/rights of way

Public Footpaths Purple.

No 181: From Revesby Corner, Mareham Le Fen to the A155 South of Shirewood, Revesby.

No 185: From West lane to Revesby Bridge.

No 186: From West Lane to Revesby village Alms houses.

No 196: From Wood Enderby to back lane Moorby Village.

No197: From East Kirkby Village to south west corner of field in which middle fen farm, Revesby is situated.

No200: From Park Lane Miningsby to Sall Holt Miningsby.

No214: From Manor Farm Miningsby to Miningsby Beck opposite the Grange.

Highways With vehicle status Brown

West lane from A155 Revesby to Moor houses.

Holt Lane, from A155 Mareham, le Fen to Low grounds Bridge.

Could you please acknowledge receipt of this either through a phone call or a email.

Phone number : 01507 568 395

Email : office@revesbyestate.co.uk



196



181

186

185







214

<200





25/11/09

Legend

— CMR

— Foot Path