

I, PHILIP HENRY GIBBONS of The Hall Holton le Moor in the County of Lincoln  
Solemnly and Sincerely Declare as follows:-

1. I have been familiar with and owned various land at Holton le Moor and  
Nettleton in the County of Lincoln since 1970 which are edged purple on the  
attached plan marked "P.H.G." - - - - -

2. During this time I confirm that the only Highways which have been used by  
the Public are shown on the attached plan marked Red and no further land has  
been dedicated to the Local Authority as Public Rights of Way - - - - -

3. I Depose as above from my knowledge and as Owner of the lands situate in  
Holton le Moor and Nettleton - - - - -

AND I make this solemn declaration conscientiously believing the same to be  
true by virtue of the provisions of the Statutory Declarations Act 1835 - - -

DECLARED at

*baistor*

this

*31*

day of

*Jan*

1990

Before me,

[REDACTED]

*J.P.*

[REDACTED]









Holton le Moor

Pt. 0082  
08  
Pt. 0081  
32  
Pt. 0081  
37  
Pt. 0001  
10-32

Pt. 0081  
124

Pt. 0081  
51  
0060  
49

0058  
3-04  
1563  
13

0044  
33-14

0004  
79-37

0070  
45-06

4955  
35-20

2600  
30-80

0/68  
2-52

2274  
37

35

Mount Pleasant

5066  
50-65

8765  
21-41

1851  
16-78

0396  
15-54

8936  
15-10

7031  
30-12

6428  
20

5200  
4-41

4000  
10-28

0006  
86-84

4074  
25-02

7571  
34-17

3979  
15-87

4056  
15-74

2552  
8-49

3231  
6-33

4401  
14-02  
4402  
14-02  
4403  
14-02

0011  
14-02  
0012  
14-02  
0013  
14-02

Foot Path  
87



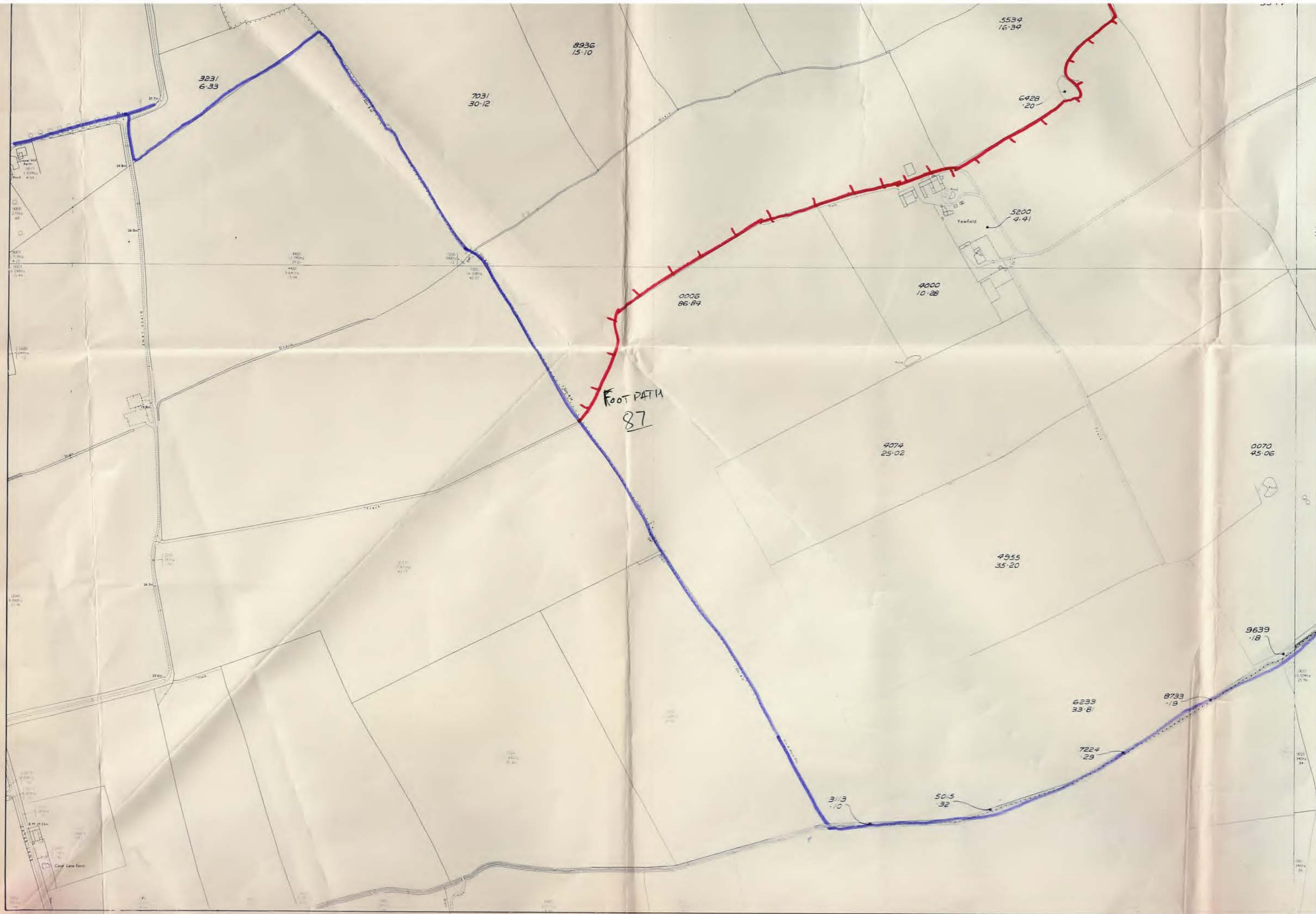



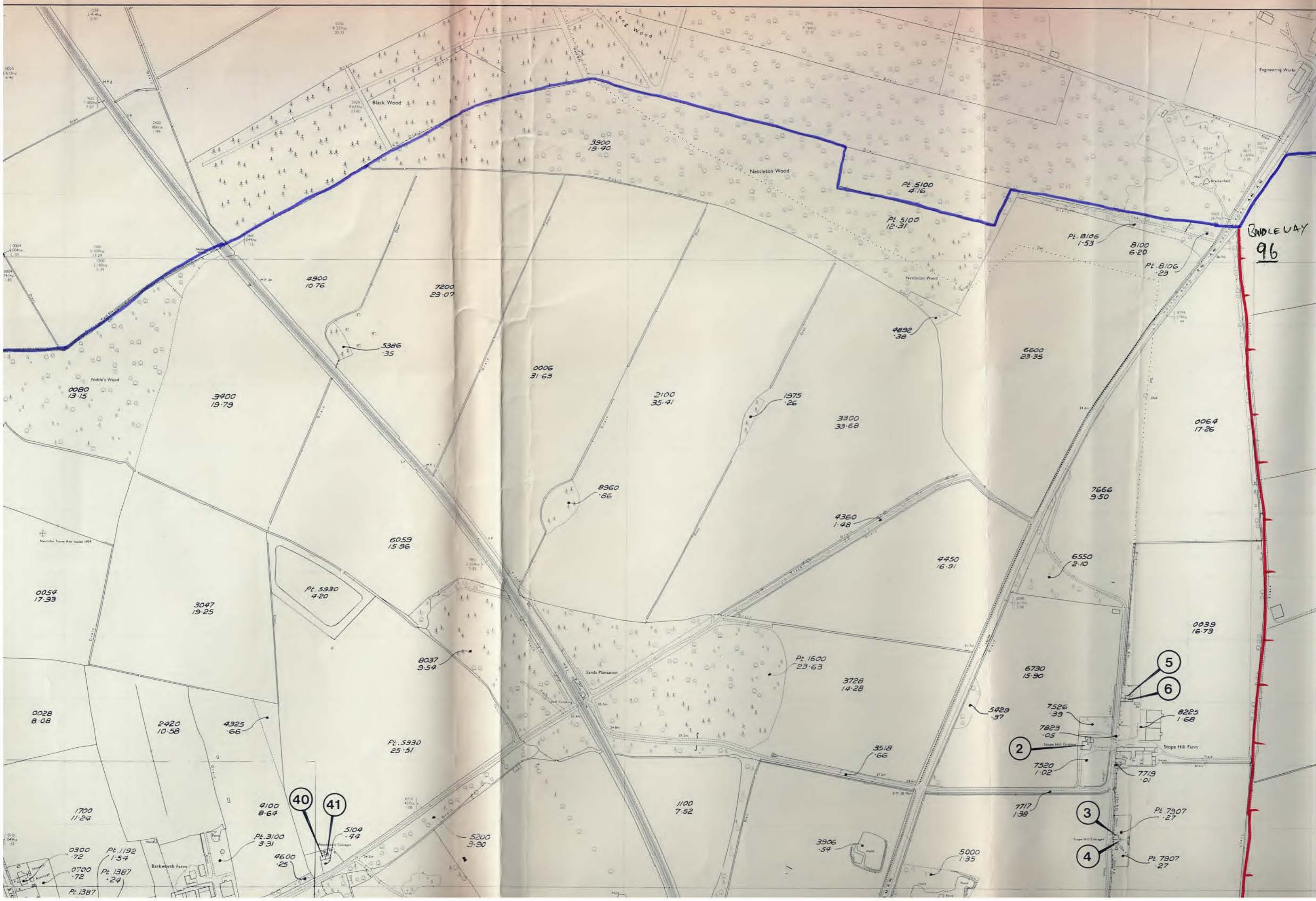



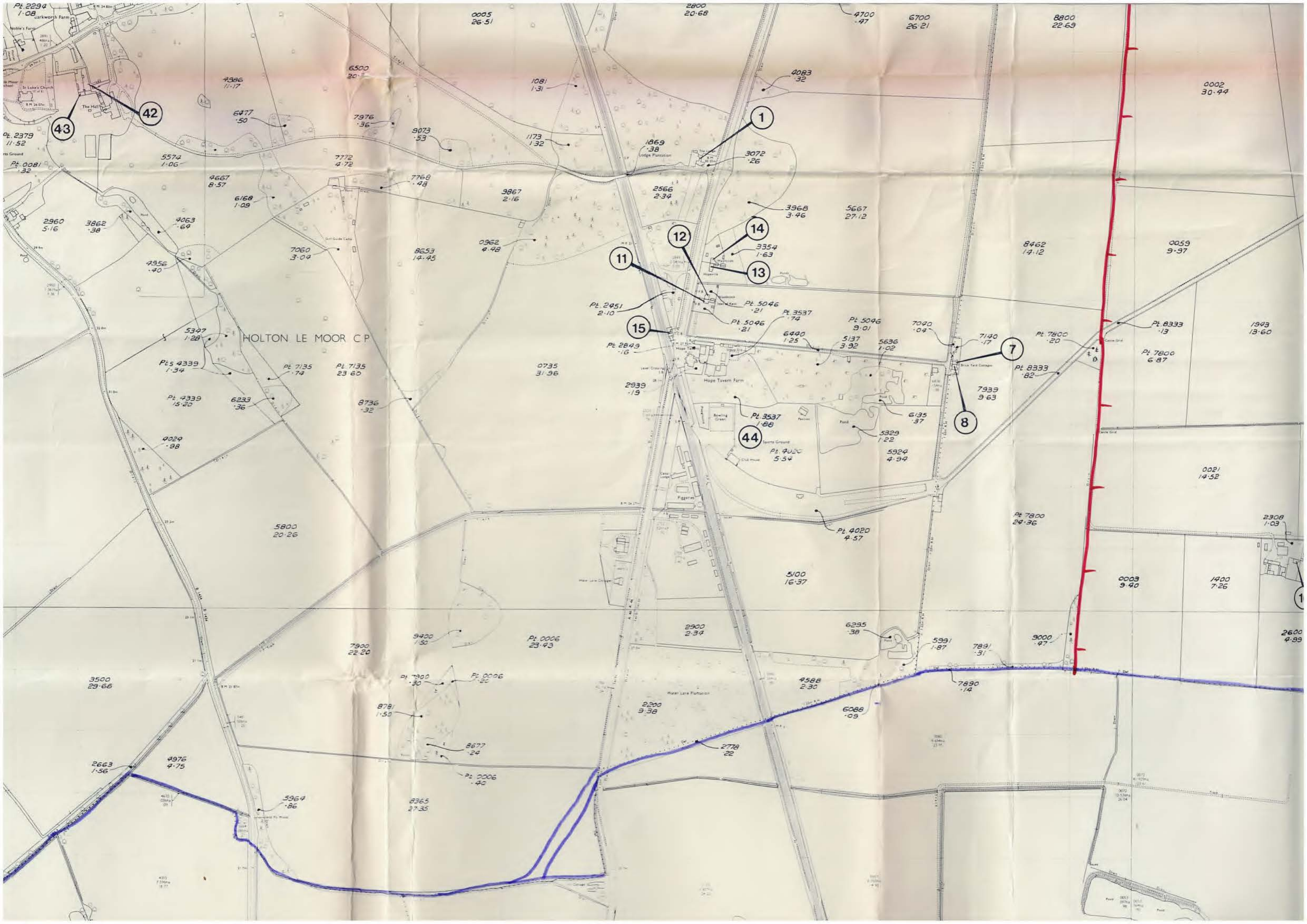







[illegible]

\_\_\_\_\_











I, PHILIP HENRY GIBBONS of The Hall Holton le Moor in the County of Lincoln  
Solemnly and Sincerely Declare as follows :-

1. I have been familiar with and owned various land at Holton le Moor and  
Nettleton in the County of Lincoln since 1970 which are edged purple on the  
attached plan marked "P.H.G." - - - - -

2. During this time I confirm that the only Highways which have been used  
by the Public are shown on the attached plan marked red and no further land  
has been dedicated to the Local Authority as Public Rights of Way - - - -

3. I Depose as above from my knowledge and as Owner of the land situate  
in Holton le Moor and Nettleton - - - - -

AND I make this solemn declaration conscientiously believing the same to be  
true by virtue of the provisions of the Statutory Declarations Act 1835 -

DECLARED at *Market Rasen* )  
this *8th* day of *September* 1994 )  
Before me *N.M. Cook* )

*JUSTICE OF THE PEACE*

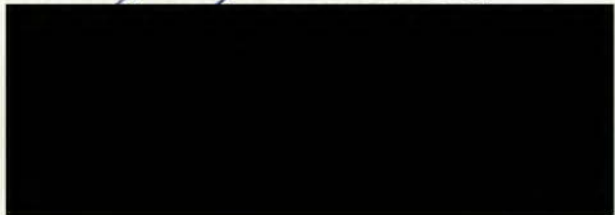









Footpath  
87









Bridleway  
96

4450

1000











# HOLTON-LE-MOOR ESTATE

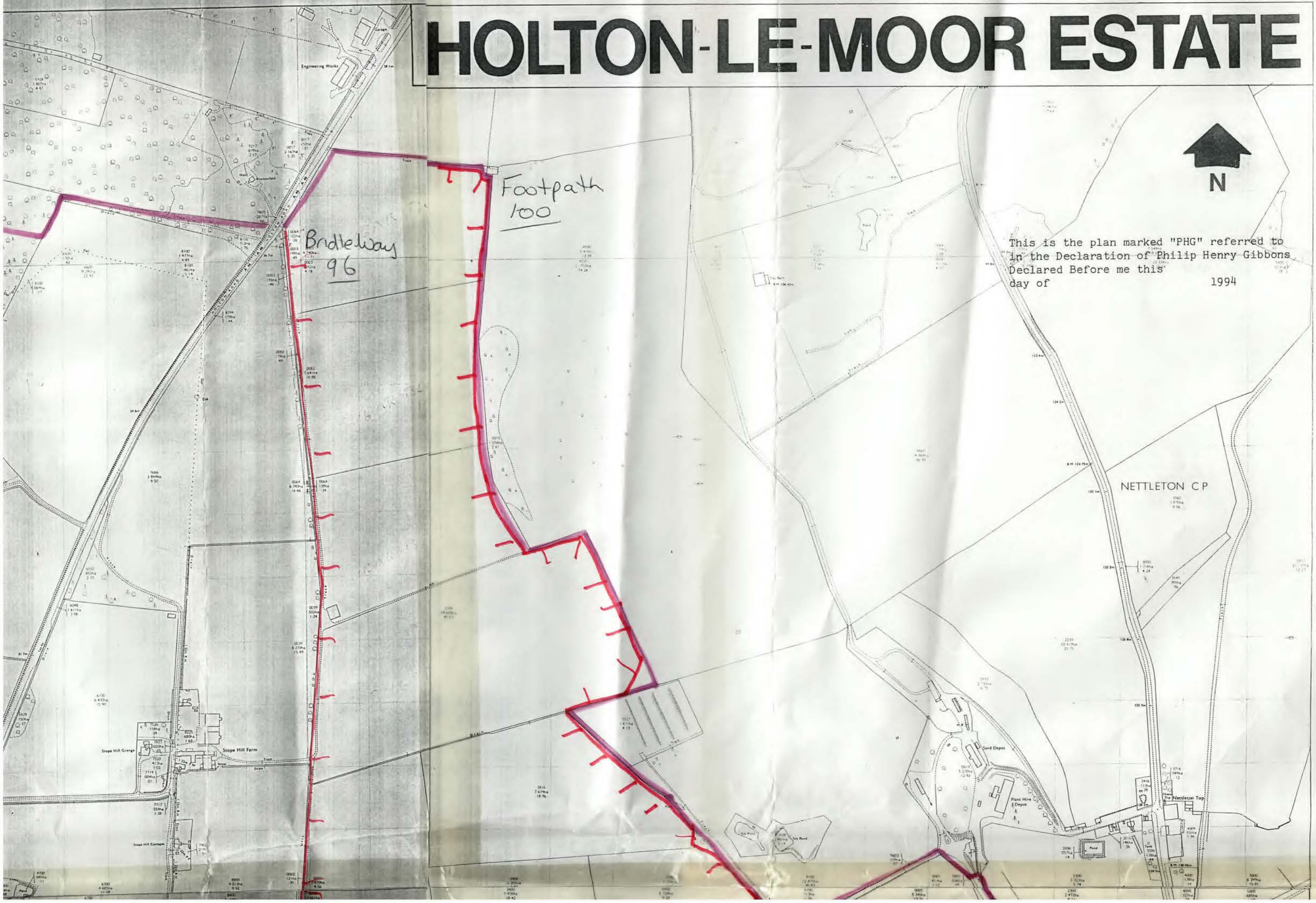







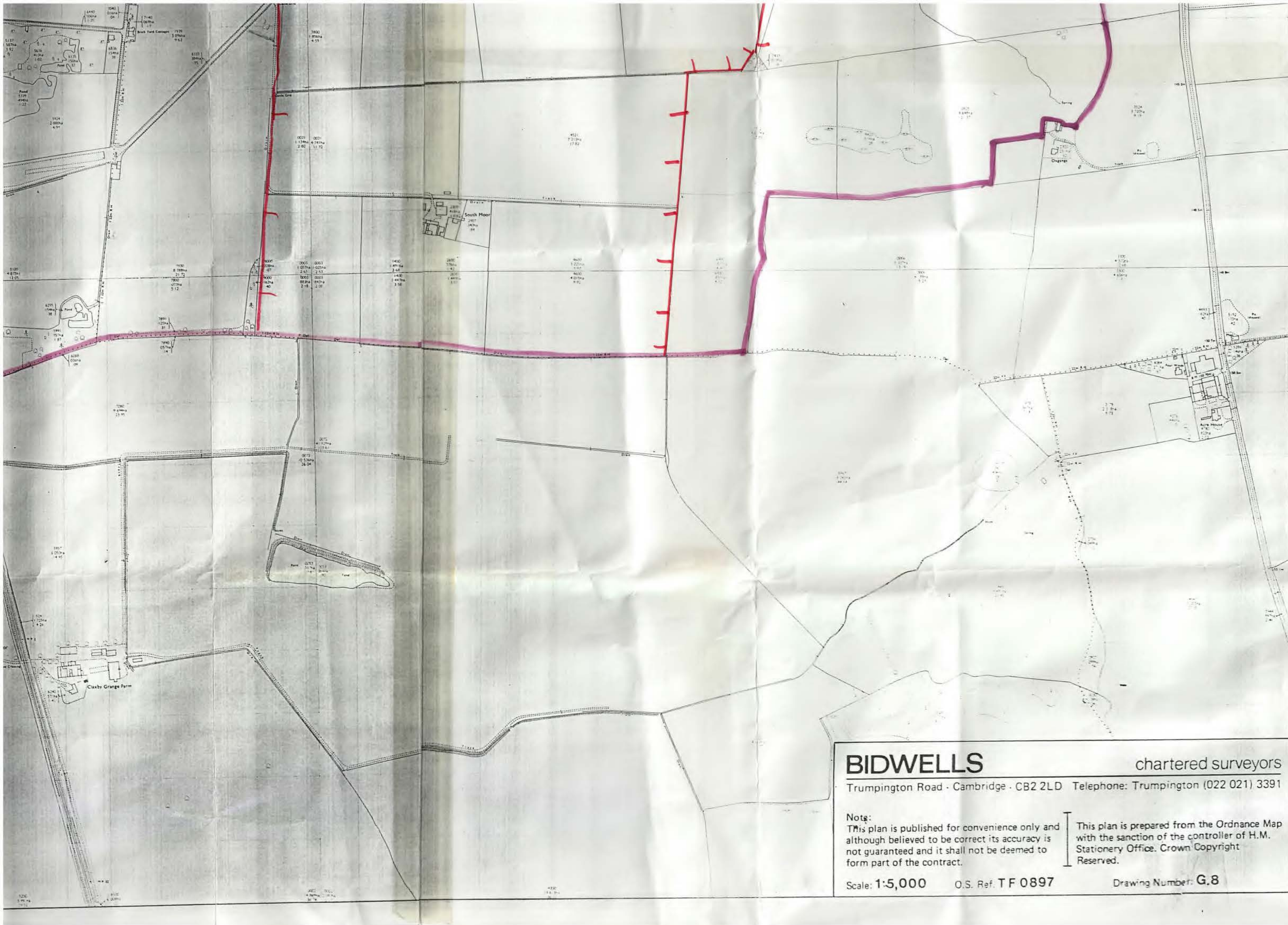

**BIDWELLS**

chartered surveyors

Trumpington Road · Cambridge · CB2 2LD Telephone: Trumpington (022 021) 3391

**Notes:**

This plan is published for convenience only and although believed to be correct its accuracy is not guaranteed and it shall not be deemed to form part of the contract.

This plan is prepared from the Ordnance Map with the sanction of the controller of H.M. Stationery Office. Crown Copyright Reserved.

Scale: 1:5,000

O.S. Ref. TF 0897

Drawing Number: **G.8**