

INSET 1

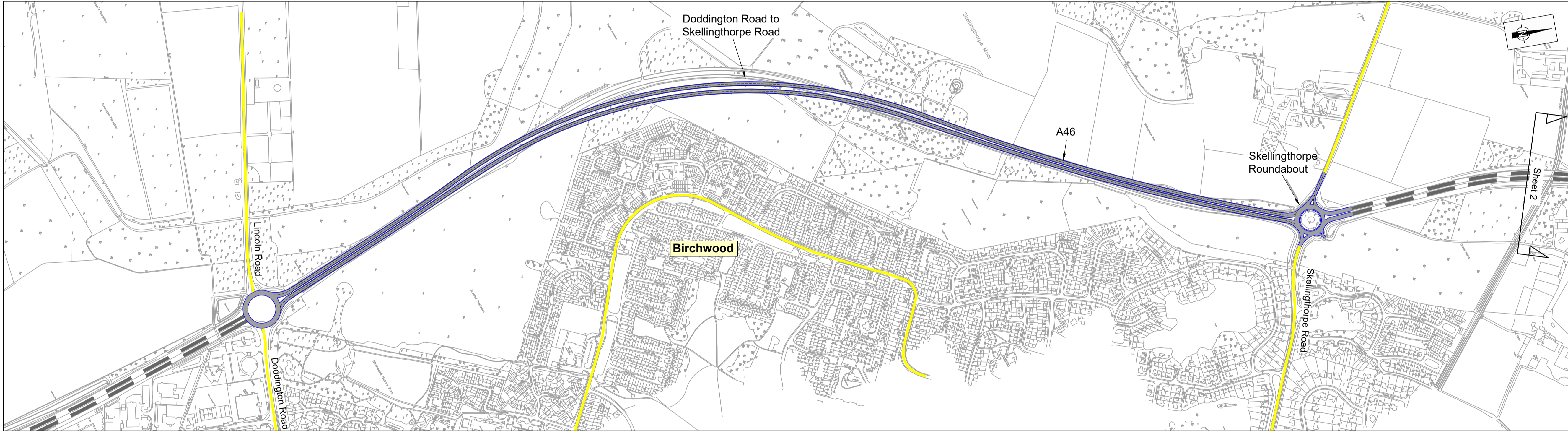

INSET 2

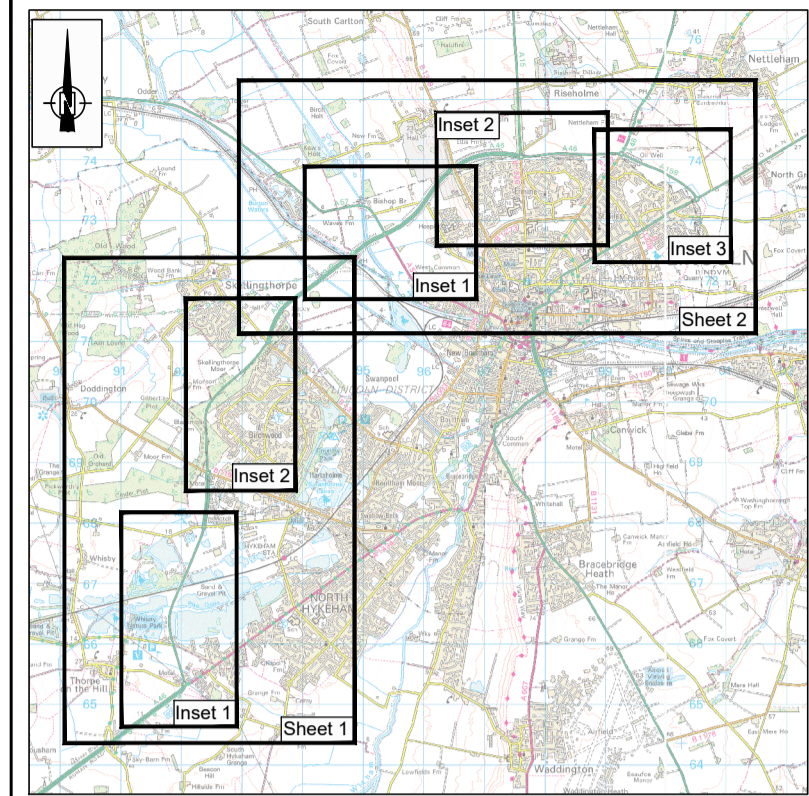

LOCATION PLAN

**KEY**  
 Existing A46 dual carriageway

# PRELIMINARY

PRELIMINARY/FEASIBILITY DRAWING PRIOR TO DETAILED DESIGN ONLY

FOR THIRD PARTY USE, THIS DRAWING SHALL BE DEEMED CURRENT ONLY AT THE DATE OF APPROVAL. PLEASE CHECK FOR AMENDMENTS BEFORE USE

UNDER NO CIRCUMSTANCES IS THIS DRAWING TO BE ISSUED FOR DETAILED DESIGN, PRICING OR CONSTRUCTION PURPOSES

**Drawing Approval**  
 Latest Revision: 1st Approval  
 Drawn/Designed by: NM  
 CAD By: DS  
 Approved By: MCO - 23/11/18

**Scale:**  
 Primary: 1:5000  
 Secondary: (Do not scale from this drawing)

**Lincolnshire** COUNTY COUNCIL  
**Highways Alliance**  
 TECHNICAL SERVICES PARTNERSHIP  
 CHRYSLER HOUSE  
 GRANTHAM STREET  
 LINCOLN  
 LN2 1BD  
 Customer Service Centre 01522 703070



BSI  
 Certificate No. FS20705

738233/WSP / GEN / XX / D2 / CH / 0017 Rev.  
 Project/Originator Volume Location/File Type Role/No. Revision

Alternative Scheme Code: 0362/01/PR2/008 Road No:  
 Parish: LINCOLN  
 Structure No: SCN No: Site Ref:

Description:  
 NORTH HYKEHAM RELIEF ROAD  
 DUALLING OF A46 BYPASS  
 SHEET 1 OF 2