

10. 'Appropriate authority' means (a) in relation to a map or statement deposited or declaration lodged under section 31(6) of that Act, an appropriate council (as defined in section 31(7) of the Highways Act 1980); and (b) in relation to a statement and map deposited under section 15A(1) of the 2006 Act, a commons registration authority (defined in section 4 of the Commons Act 2006 and section 2 of the Commons Registration Act 1965). In practice, the appropriate council and commons registration authority will usually be the same body.

**PART A: Information relating to the applicant and land to which the application relates  
(all applicants must complete this Part)**

1. Name of appropriate authority to which the application is addressed:

Lincolnshire County Council

2. Name and full address (including postcode) of applicant:

Paul Henry Roughton of The Grange Eaudyke Road Friskney Boston Lincs PE22 8RT

3. Status of applicant (tick relevant box or boxes):

I am

(a)  the owner of the land(s) described in paragraph 4.

(b)  making this application and the statements/declarations it contains on behalf of [insert name of owner] who is the owner of the land(s) described in paragraph 4 and in my capacity as [insert details].

4. Insert description of the land(s) to which the application relates (including full address and postcode):

land on the north and south sides of Sea Lane, Friskney

5. Ordnance Survey six-figure grid reference(s) of a point within the area of land(s) to which the application relates (if known): TF490544

6. This deposit comprises the following statement(s) and/or declarations (*delete Parts B, C, or D where not applicable*): Statement under Section 31 (6) of the Highways Act 1980.

**PART B: Statement under section 31(6) of the Highways Act 1980**

I am Paul Henry Roughton the owner of the land described in paragraph 4 of Part A of this form and shown edged red on the map accompanying this statement.

Ways shown purple on the accompanying map are public footpaths.

No other ways over the land shown edged red on the accompanying map have been dedicated as highways.

**PART E: Additional information relevant to the application**  
*(insert any additional information relevant to the application)*

**PART F: Statement of Truth**  
*(all applicants must complete this Part)*

**WARNING:** If you dishonestly enter information or make a statement that you know is, or might be, untrue or misleading, and intend by doing so to make a gain for yourself or another person, or to cause loss or the risk of loss to another person, you may commit the offence of fraud under section 1 of the Fraud Act 2006, the maximum penalty for which is 10 years' imprisonment or an unlimited fine, or both.

**I BELIEVE THAT THE FACTS AND MATTERS CONTAINED IN THIS FORM ARE TRUE**

Signature: 

Print full name: Paul Henry Roughton

Date: 14/11/2024

You should keep a copy of the completed form

**Data Protection Act 1998 - Fair Processing Notice**

The purpose of this Fair Processing Notice is to inform you of the use that will be made of your personal data, as required by the Data Protection Act 1998.

The appropriate authority (see explanation of definition in above guidance notes) in England is the data controller in respect of any personal data that you provide when you complete this form.

The information that you provide will be used by the appropriate authority in its duties to process applications to deposit statements, maps and declarations under section 31(6) the Highways Act 1980 and statements under section 15A(1) of the Commons Act 2006. The information you provide will also be used by the appropriate authority in its duty to update the registers in which details of such deposits are recorded under the Dedicated Highways (Registers under Section 31A of the Highways Act 1980) (England) Regulations 2007 and the Commons (Registration of Town or Village Greens) and Dedicated Highways (Landowner Statements and Declarations) (England) Regulations 2013.

The appropriate authority is required by the legislation above to maintain a register which holds information provided in this form, which can be inspected online or in person by members of the public on request. It may also be required to release information, including personal data and commercial information, on request under the Environmental Information Regulations 2004 or the Freedom of Information Act 2000. However, the appropriate authority will not permit any unwarranted breach of confidentiality nor will they act in contravention of their obligations under the Data Protection Act 1998.

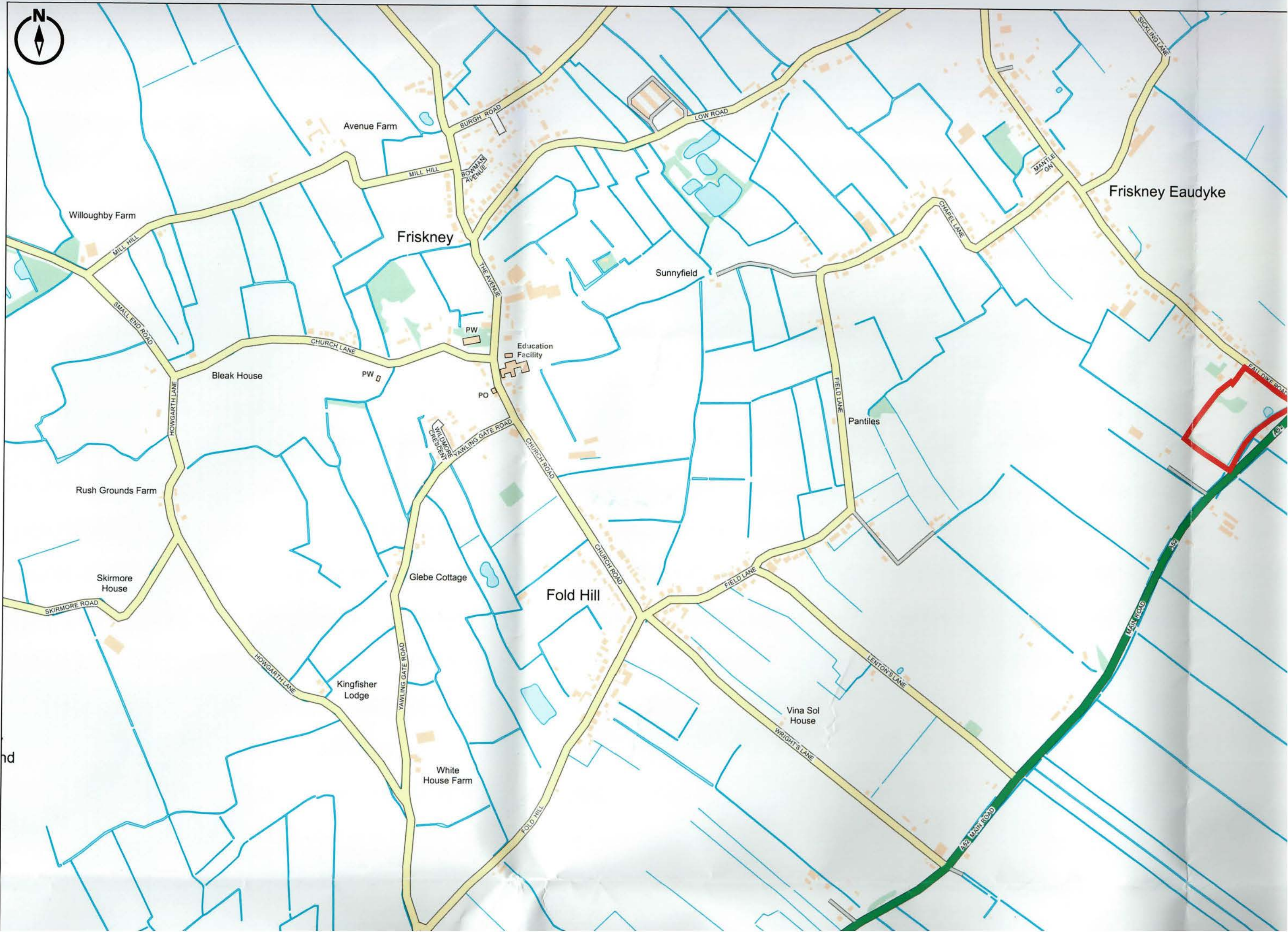

Willoughby Farm

Avenue Farm

Friskney

Friskney Eaudyke

Sunnyfield

Bleak House

Education Facility

Pantiles

Rush Grounds Farm

Glebe Cottage

Fold Hill

Skirmore House

Kingfisher Lodge

Vina Sol House

White House Farm

nd

MILL HILL

SMALL END ROAD

HOWGARTH LANE

SKIRMORE ROAD

HOWGARTH LANE

BURGH ROAD

MILL HILL

BOWMAN AVENUE

THE AVENUE

WILDMORP CRESCENT

YAWLING GATE ROAD

YAWLING GATE ROAD

FOLD HILL

LOW ROAD

CHURCH ROAD

CHURCH ROAD

FIELD LANE

FIELD LANE

LENTON'S LANE

WRIGHT'S LANE

CHapel Lane

MANTLE GN

MAN ROAD

A52 MAIN ROAD

SICKLING LANE

PANTILES ROAD

49

43



© Crown copyright and database rights 2024. OS AC0000813445

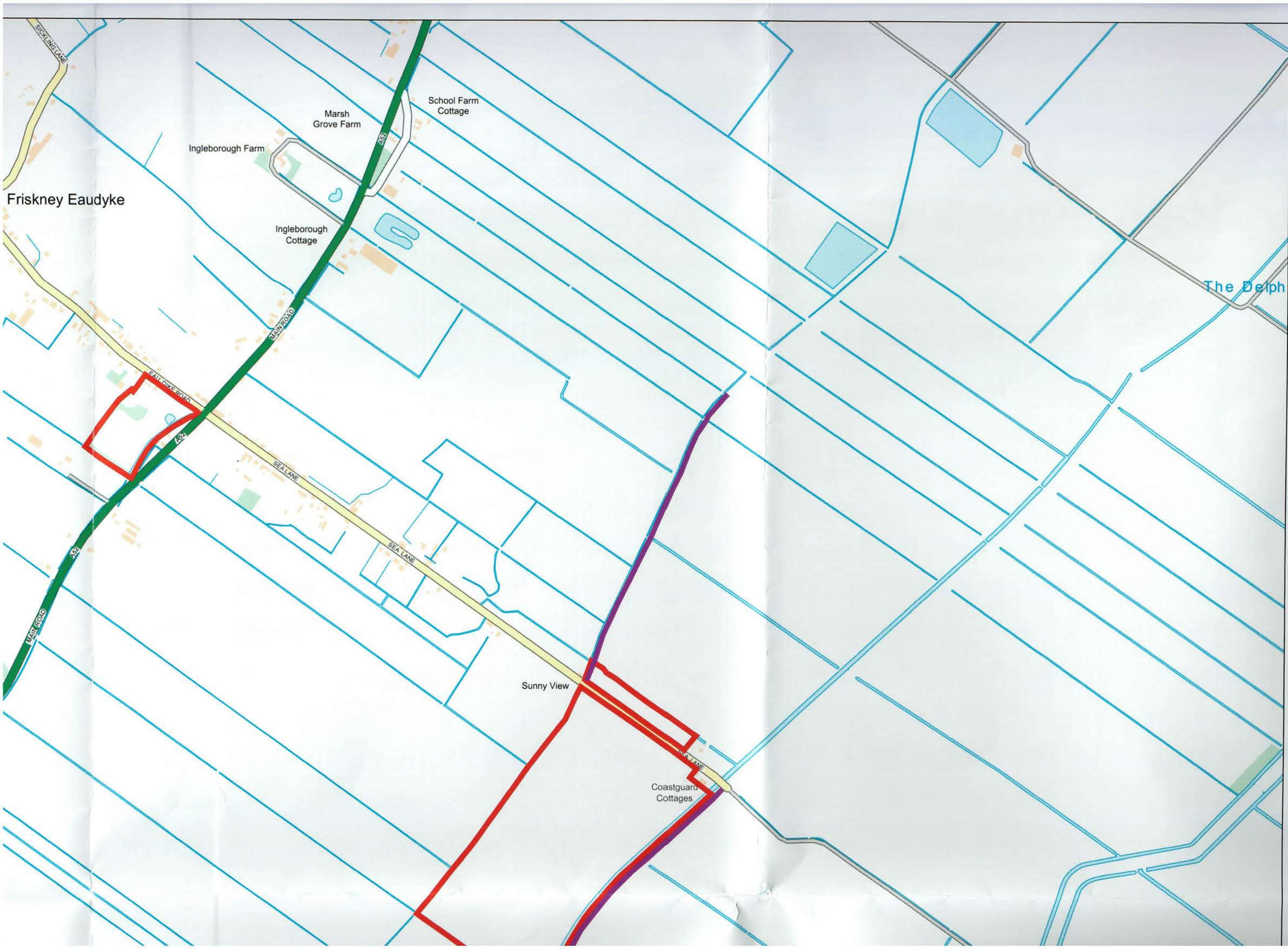

Friskney Eaudyke

Ingleborough Farm

Marsh Grove Farm

School Farm Cottage

Ingleborough Cottage

The Delph

Sunny View

Coastguard Cottages

SICKLING LANE

MAIN ROAD

FALL DIKE ROAD

MAIN ROAD

SEA LANE

SEA LANE

SEA LANE

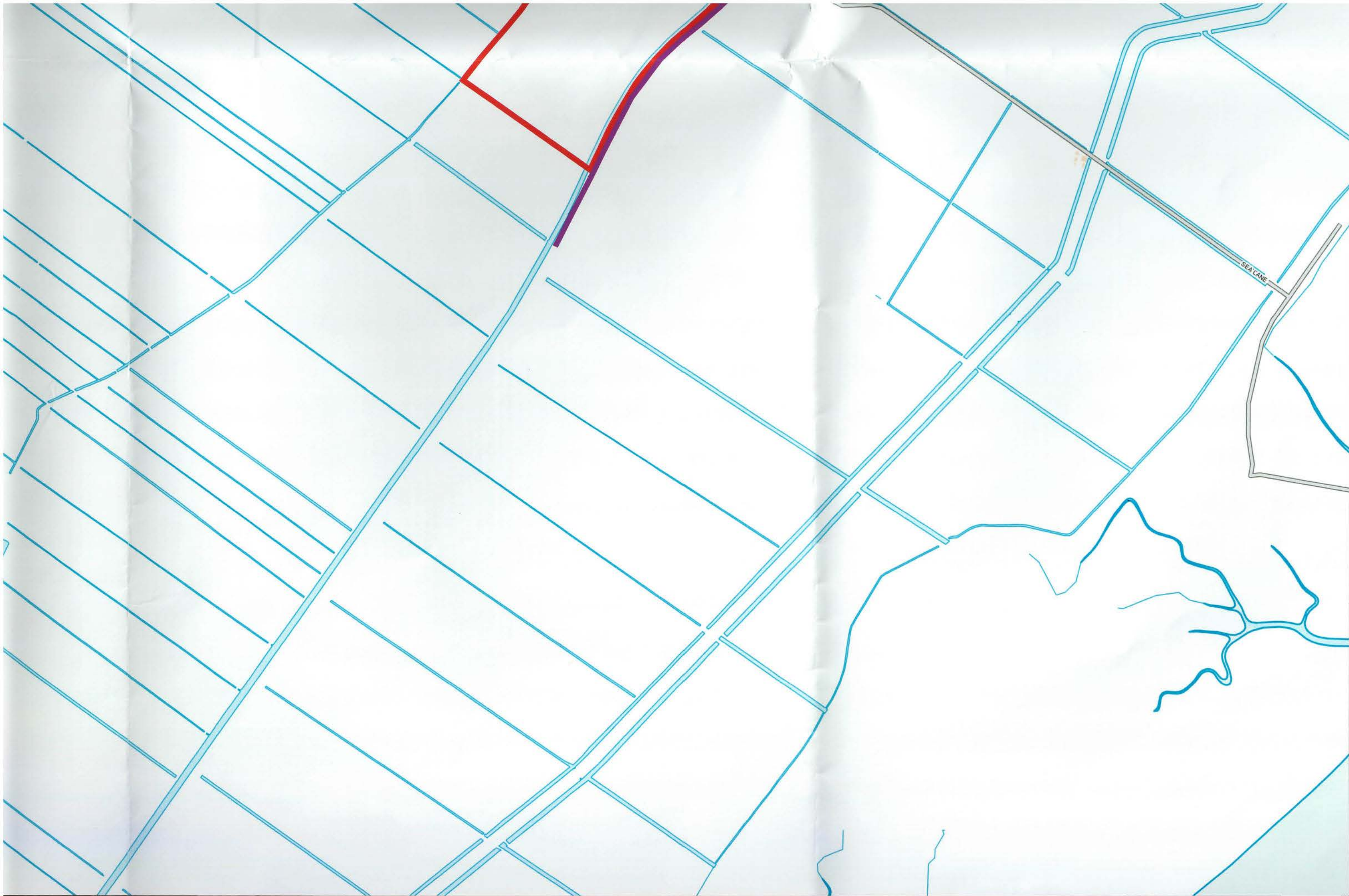

10. 'Appropriate authority' means (a) in relation to a map or statement deposited or declaration lodged under section 31(6) of that Act, an appropriate council (as defined in section 31(7) of the Highways Act 1980); and (b) in relation to a statement and map deposited under section 15A(1) of the 2006 Act, a commons registration authority (defined in section 4 of the Commons Act 2006 and section 2 of the Commons Registration Act 1965). In practice, the appropriate council and commons registration authority will usually be the same body.

**PART A: Information relating to the applicant and land to which the application relates**  
**(all applicants must complete this Part)**

1. Name of appropriate authority to which the application is addressed:  
Lincolnshire County Council

2. Name and full address (including postcode) of applicant:  
Paul Henry Roughton of The Grange Eaudyke Road Friskney Boston Lincs PE22 8RT

3. Status of applicant (tick relevant box or boxes):

I am

(a)  the owner of the land(s) described in paragraph 4.

(b)  making this application and the statements/declarations it contains on behalf of [*insert name of owner*] who is the owner of the land(s) described in paragraph 4 and in my capacity as [*insert details*].

4. Insert description of the land(s) to which the application relates (including full address and postcode):  
Land on the north and south sides of Sea Lane Friskney

5. Ordnance Survey six-figure grid reference(s) of a point within the area of land(s) to which the application relates (if known): TF490544

6. This deposit comprises the following declaration under section 31(6) of the Highways Act 1980.

**PART C: Declaration under section 31(6) of the Highways Act 1980**

1. I am Paul Henry Roughton the owner of the land described in paragraph 4 of Part A of this form and shown red on the map lodged with Lincolnshire County Council on 15<sup>th</sup> November 2024.

2. On the 15<sup>th</sup> day of November 2024 I Paul Henry Roughton deposited with Lincolnshire County Council, being the appropriate council, a statement accompanied by a map showing my property red which stated that:

the ways shown purple on that map had been dedicated as footpaths

no other ways had been dedicated as highways over my property.

4. No additional ways have been dedicated over the land red on the map referenced in paragraph 1 above since the statement dated 14<sup>th</sup> November 2024 referred to in paragraph 2 above other than those footpaths marked in the appropriate colour on the map accompanying this declaration and at the present time I have no intention of dedicating any more public rights of way over my property.



**PART E: Additional information relevant to the application**  
*(insert any additional information relevant to the application)*

**PART F: Statement of Truth**  
*(all applicants must complete this Part)*

**WARNING:** If you dishonestly enter information or make a statement that you know is, or might be, untrue or misleading, and intend by doing so to make a gain for yourself or another person, or to cause loss or the risk of loss to another person, you may commit the offence of fraud under section 1 of the Fraud Act 2006, the maximum penalty for which is 10 years' imprisonment or an unlimited fine, or both.

**I BELIEVE THAT THE FACTS AND MATTERS CONTAINED IN THIS FORM ARE TRUE**

**Signature (of the person making the statement of truth):**



**Print full name:** PAUL ROUGHTON

**Date:** 03/12/24

**You should keep a copy of the completed form**

**Data Protection Act 1998 - Fair Processing Notice**

The purpose of this Fair Processing Notice is to inform you of the use that will be made of your personal data, as required by the Data Protection Act 1998.

The appropriate authority (see explanation of definition in above guidance notes) in England is the data controller in respect of any personal data that you provide when you complete this form.

The information that you provide will be used by the appropriate authority in its duties to process applications to deposit statements, maps and declarations under section 31(6) the Highways Act 1980 and statements under section 15A(1) of the Commons Act 2006. The information you provide will also be used by the appropriate authority in its duty to update the registers in which details of such deposits are recorded under the Dedicated Highways (Registers under Section 31A of the Highways Act 1980) (England) Regulations 2007 and the Commons (Registration of Town or Village Greens) and Dedicated Highways (Landowner Statements and Declarations) (England) Regulations 2013.

The appropriate authority is required by the legislation above to maintain a register which holds information provided in this form, which can be inspected online or in person by members of the public on request. It may also be required to release information, including personal data and commercial information, on request under the Environmental Information Regulations 2004 or the Freedom of Information Act 2000. However, the appropriate authority will not permit any unwarranted breach of confidentiality nor will they act in contravention of their obligations under the Data Protection Act 1998.