

ROAD TRAFFIC REGULATION ACT 1984

LINCOLNSHIRE COUNTY COUNCIL

(SWINESHEAD, ABBEY ROAD)

(PROHIBITION OF LOADING) AMENDMENT ORDER 20

THE LINCOLNSHIRE COUNTY COUNCIL in exercise of its powers under Sections 1, 2(1) and (2), 3, 4, 5, 32, 35, 45, 46, 49, 53, 124 and Part IV of Schedule 9 of the Road Traffic Regulation Act 1984 (the Act of 1984) as amended and the Traffic Management Act 2004 (the Act of 2004) and of all other enabling powers, and after consultation with the Chief Officer of Police in accordance with Part III of Schedule 9 to the Act of 1984, hereby makes the following Order.

1. This Order shall come into operation on 20 and may be cited as the Lincolnshire County Council (Swineshead, Abbey Road) (Prohibition of Loading) Amendment Order 20
2. The Lincolnshire County Council (Prohibition and Restriction of Waiting and Loading and Parking Places) (Civil Enforcement and Consolidation) Order 2012 Plans including the key (the 'Plans') are incorporated into this Order.
3. Plan ? of the Lincolnshire County Council (Prohibition and Restriction of Waiting and Loading and Parking Places) (Civil Enforcement and Consolidation) Order 2012 shall be amended.
4. Any restriction or requirement made or having effect as if made under the Act of 1984 or any other enactment is hereby revoked insofar as it relates to the length and sides of road specified in this Order.

5. The prohibition imposed by this Order shall be in addition to and not in derogation from any restriction or requirement imposed by any regulations made or having effect as if made under the Act of 1984 or by or under any other enactment.

THE COMMON SEAL of the LINCOLNSHIRE)

COUNTY COUNCIL was hereunto affixed)

in the presence of:-)

Authorised Officer

DATED -

LINCOLNSHIRE COUNTY COUNCIL

(SWINESHEAD, ABBEY ROAD)

(PROHIBITION OF LOADING)

AMENDMENT ORDER 20

A Gutherson

Director for Place

Lincolnshire County Council

County Offices

Lincoln

**LINCOLNSHIRE COUNTY COUNCIL
(SWINESHEAD, ABBEY ROAD)
(PROHIBITION OF LOADING) AMENDMENT ORDER 20**

STATEMENT OF REASONS

- Concerns have been expressed with regards to parking in the vicinity of the school.
- Vehicles have regularly been observed parking inconsiderately and ignoring the existing No Waiting restrictions resulting in difficulties for all road users and raising safety concerns.
- The proposals will facilitate traffic flow, ensure all accesses are kept clear and improve visibility and road safety for all users.
- Therefore, it is proposed to prohibit loading as set out on the plans to the Order.
- The Chief Constable, Swineshead Parish Council and Boston Borough Council have been consulted, along with other local groups/companies.

PUBLIC NOTICE

LINCOLNSHIRE COUNTY COUNCIL (SWINESHEAD, ABBEY ROAD) (PROHIBITION OF LOADING) AMENDMENT ORDER 20

NOTICE IS HEREBY GIVEN that the Lincolnshire County Council propose to make an Order under their powers contained in the Road Traffic Regulation Act 1984, the effect of which will be to prohibit loading on sections of Abbey Road, Swineshead.

Exemptions are included which will permit the maintenance of the roads and works in connection with the supply of gas, electricity, water and telecommunications apparatus.

A copy of the plan showing the lengths of road concerned along with a Statement of Reasons for proposing to make the Order may be inspected on our website: www.lincolnshire.gov.uk/trafficorders

If you are unable to view our website the documents can be supplied to you by contacting us using the contact details below or calling our Customer Service Centre on 01522 782070 during office hours.

You may also be able to view these documents at the offices of Boston Borough Council, during normal office hours.

Objections or representations to the proposals, together with the grounds on which they are made, must be made in writing to Chief Executive - Lincolnshire County Council, Lancaster House, 36 Orchard Street, Lincoln, LN1 1XX or Email: TRO@lincolnshire.gov.uk (For the attention of: Mr B Gault, Traffic Orders Section) by **12th March 2025.**

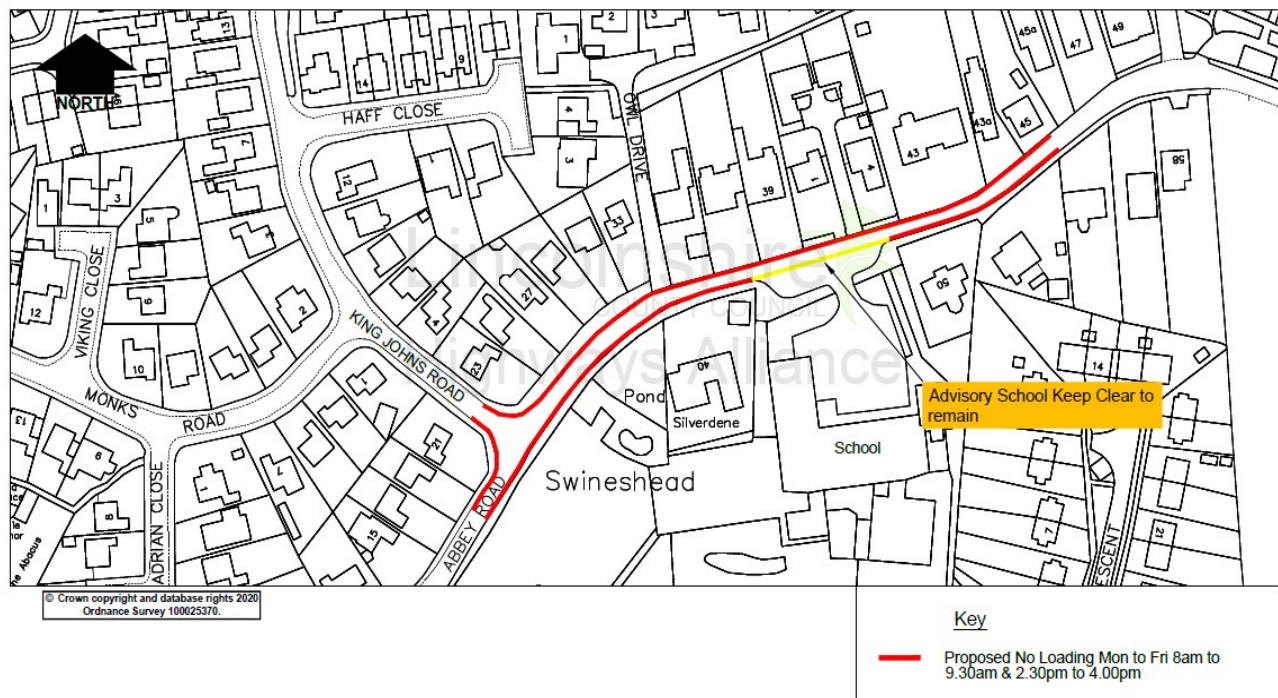

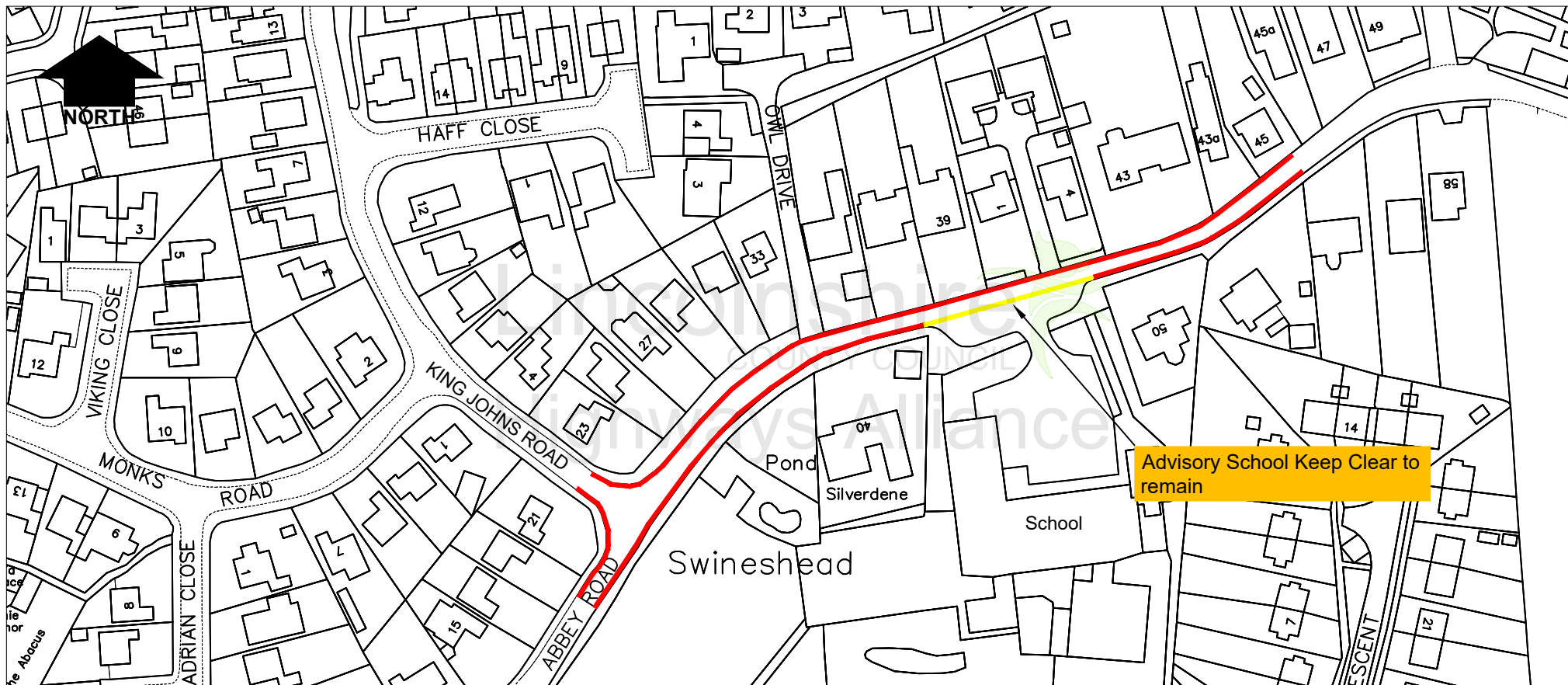

© Crown copyright and database rights 2020
Ordnance Survey 100025370.

Advisory School Keep Clear to remain

Key

— Proposed No Loading Mon to Fri 8am to 9.30am & 2.30pm to 4.00pm

Project		Swineshead, Abbey Road	
Status	Project No. 265		
Drawing Title Proposed No Loading Restrictions			
Drawing No. BG/265/003			

Rev.	Description	Drawn	Ch'kd	Auth	Date
	Project	BG			11/24
		Ch'kd			Date
		Auth			Traced
		Rev.	0		Scale
					NTS @A4