

# RSPB Freiston Shore

# 6

## The Lagoon Trial 1.8 km or 1.1 miles

1. From the car park, walk around the hedgerow and then through the double green gates, stopping to look at the reserve information board on the way. Follow this hard gravel path along the hedgerow, perhaps stopping at the birdwatching hide for a few minutes on the way, until you reach a kissing gate at the end.
2. Go through the kissing gate and walk up onto the sea bank. Go straight ahead for 50 metres towards the sea, and then turn left and follow the top of the sea bank that separates the lagoon from the new realignment area, keeping the lagoon on your left at all times.
3. Go through the kissing gate at the end, and then walk down the short flight of steps on the left. Follow the grassy path between the hedgerow and the lagoon back to the car park.

## The Wetland Trial 4.8 km or 3 miles

4. From the car park, walk back past the Reserve entrance to the large metal gate. Go through the kissing gate, and then continue along the concrete road until you reach the barrier at the start of the North Sea Camp land.
5. Turn left here, and walk along the grassy path to the sea bank.
6. Go through the kissing gate, and up the wooden steps on to the seabank. Turn left, and then follow the sea bank back towards the lagoon.
7. On reaching the lagoon, either go down the sea bank and through the kissing gate to walk back to the car park along the gravel track, or continue on around the lagoon trail to 3.

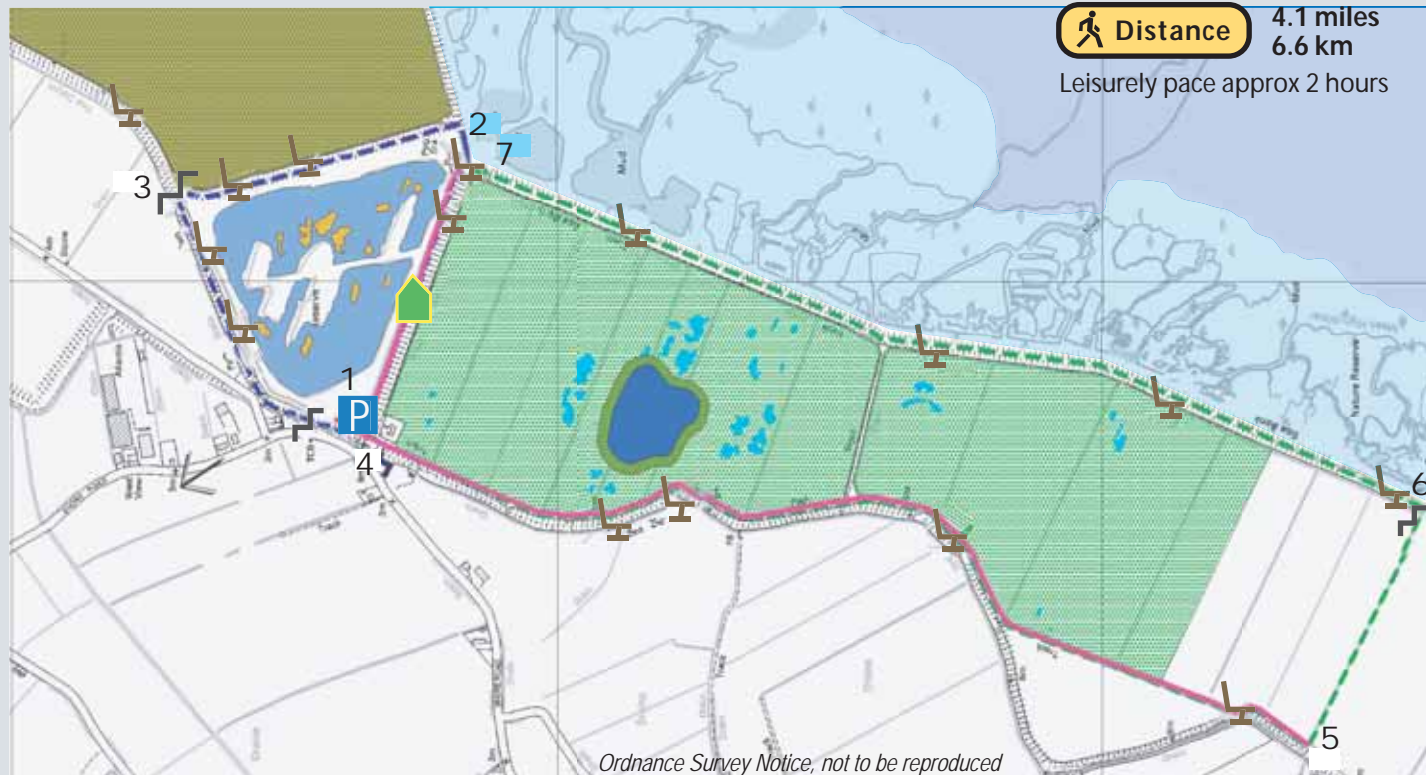

**Distance** 4.1 miles  
6.6 km  
Leisurely pace approx 2 hours

Ordnance Survey Notice, not to be reproduced

### Key

Wetland trail	Lagoon trail	Steps	Reservoir and bank
Bench	Birdwatching hide	Car park	Freshwater pools
Disability trail	Wetland area	Realignment	Salt Marsh

[not to scale]

## Areas of interest

Freiston Shore was once a major holiday destination, with horse racing and two hotels. People wanting a quieter time were advised to go to Skegness! All this changed when the shore turned from sand into mud, and the railway was extended to Skegness.

The inner sea bank (12th century) is known locally as the Roman Bank. This was built to enclose many miles of marshes to convert it to farmland. This bank was the main defence against both the sea and the threat of invasion during WWII. The outer bank was completed in 1982, and was known as “the bank too far” by the Borstall boys that built it. It lacked sufficient saltmarsh in front of it to protect it from the erosive powers of the sea, and so in 2001 the wall was deliberately breached by the Environment Agency to let the sea back on to the land it had once covered. This process is known as managed realignment, and the Freiston Shore example was the biggest in the UK when it was formed.

The lagoon at Freiston Shore was created during this time, and is a haven for many different kinds of wildlife. In the spring and summer the air is alive with the calls of avocets and black-headed gulls, while the autumn and winter brings huge numbers of birds to the area, including over 2000 brent geese from Siberia. The reservoir, built to supply the ditch network with water, attracts birds such as black-tailed godwits and wigeons. The Wash is Britain’s biggest bird table, and Freiston Shore is an excellent place from which to see it.

### How to get to RSPB Freiston Shore

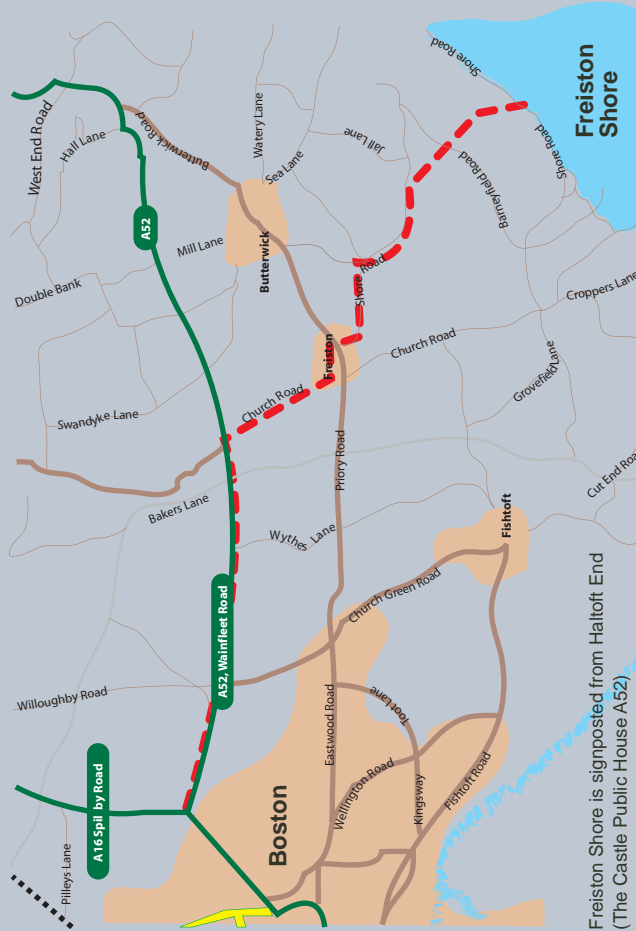

Freiston Shore is signposted from Haltoft End (The Castle Public House A52)



Avocets, courtesy of Neil Smith, RSPB